

Attachment C

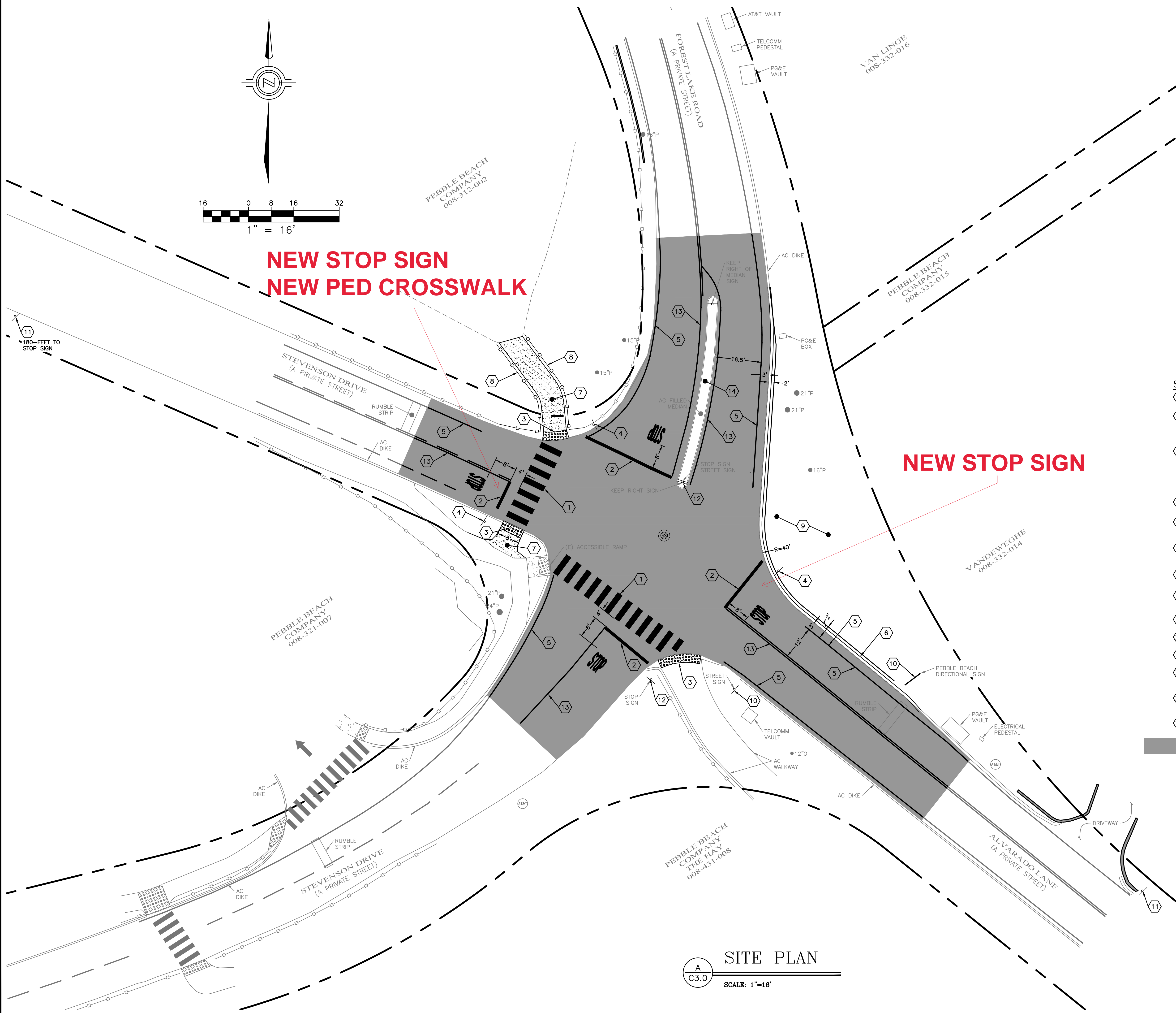

**NEW STOP SIGN
 NEW PED CROSSWALK**

NEW STOP SIGN

- SITE KEYNOTES:**
- ① (N) CROSS WALK STRIPING, SEE DETAIL F/C6.0
 - ② (N) "STOP" PAVEMENT MARKING AND 12" STOP BAR STRIPING. PAINT WITH 2 COATS OF WHITE ACRYLIC LATEX TRAFFIC PAINT, DRY BETWEEN COATS. SEE DETAIL A/C6.0
 - ③ (N) TRUNCATED DOMES, CONCRETE ADA COMPLIANT PAVER. PAVER TO BE PER 2019 CBC SEC. 11B-406.5.12 COMPLIANT PER CALIFORNIA NON-RESIDENTIAL DISABLED ACCESS REGULATIONS OF THE LATEST REVISION. COLOR TO BE RED TO MATCH (E) DOMES IN AREA. PAVERS TO BE SET IN CONCRETE, SEE DETAIL B/C6.0
 - ④ (N) STOP SIGN (MUTCD R1-1 AND R1-3P). SEE DETAIL C/C6.0
 - ⑤ (N) 4" WIDE WHITE STRIPING. PAINT WITH 2 COATS OF WHITE ACRYLIC LATEX TRAFFIC PAINT, DRY BETWEEN COATS
 - ⑥ (N) ROLLED AC DIKE TO FOLLOW (E) EDGE OF PAVEMENT. SEE DETAIL D/C6.0
 - ⑦ (N) 8-FOOT WIDE DG WALKWAY. SEE DETAIL E/C6.0
 - ⑧ (N) 3-FOOT TALL SPLIT RAIL FENCE TO MATCH EXISTING. USE SALVAGE WOOD IF POSSIBLE.
 - ⑨ (N) LANDSCAPING BY OWNER.
 - ⑩ (E) SIGNS TO REMAIN, PROTECT IN PLACE.
 - ⑪ (N) STOP AHEAD SIGN (MUTCD W3-1). SEE DETAIL C/C6.0
 - ⑫ (E) STOP SIGN TO BE REMOVED AND SALVAGED. INSTALL (N) STOP SIGN (MUTCD R1-1 AND R1-3P). SEE DETAIL C/C6.0
 - ⑬ (N) 4" WIDE YELLOW STRIPING. PAINT WITH 2 COATS OF YELLOW ACRYLIC LATEX TRAFFIC PAINT, DRY BETWEEN COATS
 - ⑭ SLURRY COAT (E) ASPHALT ISLAND, PAINT CURBS WITH 2 COATS OF WHITE ACRYLIC LATEX TRAFFIC PAINT, DRY BETWEEN COATS
- CALTRANS CLASS 2 SLURRY COAT WITH BLACK ROCK (14,300 SF)

SITE PLAN
 SCALE: 1"=16'