



LEGEND

EXISTING

- A** Vietnam Veteran's Memorial
- B** Bridge Crossing at Gabilan Creek
- C** Parking Lot
- D** Multi-Use Trail - City Wide
- E** Maintenance Access
- F** Connection to Constitution Soccer Complex

PROPOSED SCOPE

- 1** Skate Park- 10,000 SF
- 2** Bike Park - 12,900 SF
- 3** Accessible Pathways
- 4** Stormwater Retention Area
- 5** Planting & Irrigation
- 6** Enhanced Trail Crossing at Street
- 7** Directional / Educational Trail Signage
- 8** Security Lighting

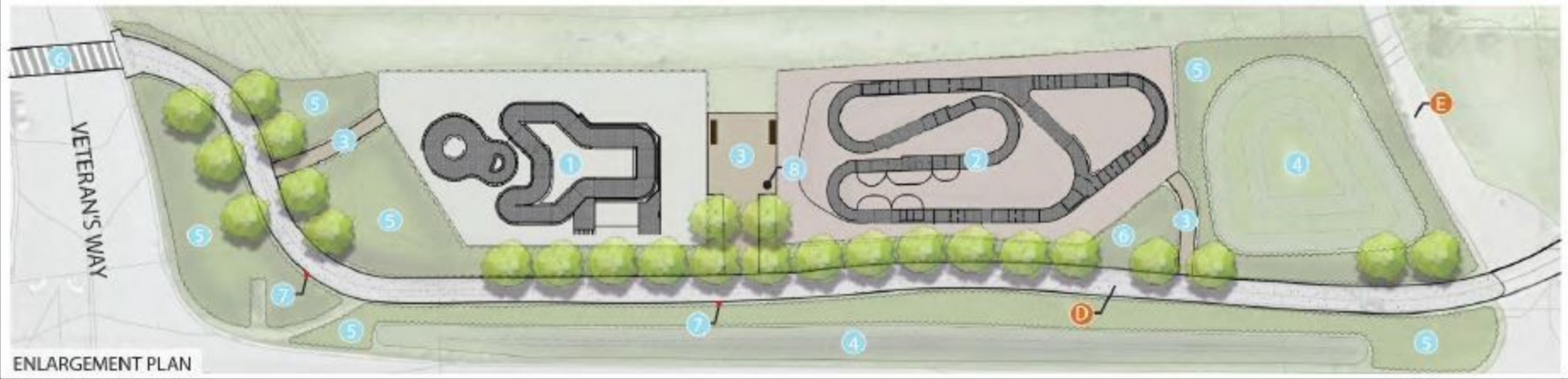

Proposed Site Plan

Date: 11-30-2021
 Scale: 1 inch = 67 feet
 Project: 855 E Laurel Dr

Monterey | San Jose

Denise Duffy and Associates, Inc.
 Environmental Consultants Resource Planners

947 Cass Street, Suite 5
 Monterey, CA 93940
 (831) 373-4341

Figure
3