

Attachment D  
Lot Line Adjustment Map

PLN120829

This page intentionally left blank.



**NOTE:**  
 1. ALL DISTANCES SHOWN HEREON ARE EXPRESSED IN FEET AND DECIMALS THEREOF.  
 2. LAND CONSERVATION AGREEMENT NO. 76-4 (RESOLUTION NO. 76-16-4) RECORDED ON REEL 1035-08-08, PG. 734, DATED FEB. 27, 1976.  
 3. JOHNSON CANYON ROAD  
 VACATED AND ABANDONED BY THE MONTEREY COUNTY BOARD OF SUPERVISORS BY RESOLUTION NO. 97-2586 DATED AND ADOPTED MAY 14, 1997. THE BOARD OF SUPERVISORS HAS HEREBY REPEALED AND ABANDONED THE PERMANENT EASEMENT FOR PACIFIC GAS AND ELECTRIC COMPANY UTILITIES AND RESERVES THE PERMANENT EASEMENT FOR PACIFIC GAS AND ELECTRIC COMPANY UTILITIES WITHIN THE LIMITS OF THE ABANDONED JOHNSON CANYON ROAD.  
 4. JOHNSON CANYON ROAD  
 VACATED AND ABANDONED BY THE MONTEREY COUNTY BOARD OF SUPERVISORS BY RESOLUTION NO. 97-2586 DATED AND ADOPTED MAY 14, 1997. THE BOARD OF SUPERVISORS HAS HEREBY REPEALED AND ABANDONED THE PERMANENT EASEMENT FOR PACIFIC GAS AND ELECTRIC COMPANY UTILITIES WITHIN THE LIMITS OF THE ABANDONED JOHNSON CANYON ROAD.  
 5. JOHNSON CANYON ROAD  
 VACATED AND ABANDONED BY THE MONTEREY COUNTY BOARD OF SUPERVISORS BY RESOLUTION NO. 97-2586 DATED AND ADOPTED MAY 14, 1997. THE BOARD OF SUPERVISORS HAS HEREBY REPEALED AND ABANDONED THE PERMANENT EASEMENT FOR PACIFIC GAS AND ELECTRIC COMPANY UTILITIES WITHIN THE LIMITS OF THE ABANDONED JOHNSON CANYON ROAD.  
 6. JOHNSON CANYON ROAD  
 VACATED AND ABANDONED BY THE MONTEREY COUNTY BOARD OF SUPERVISORS BY RESOLUTION NO. 97-2586 DATED AND ADOPTED MAY 14, 1997. THE BOARD OF SUPERVISORS HAS HEREBY REPEALED AND ABANDONED THE PERMANENT EASEMENT FOR PACIFIC GAS AND ELECTRIC COMPANY UTILITIES WITHIN THE LIMITS OF THE ABANDONED JOHNSON CANYON ROAD.  
 7. JOHNSON CANYON ROAD  
 VACATED AND ABANDONED BY THE MONTEREY COUNTY BOARD OF SUPERVISORS BY RESOLUTION NO. 97-2586 DATED AND ADOPTED MAY 14, 1997. THE BOARD OF SUPERVISORS HAS HEREBY REPEALED AND ABANDONED THE PERMANENT EASEMENT FOR PACIFIC GAS AND ELECTRIC COMPANY UTILITIES WITHIN THE LIMITS OF THE ABANDONED JOHNSON CANYON ROAD.  
 8. JOHNSON CANYON ROAD  
 VACATED AND ABANDONED BY THE MONTEREY COUNTY BOARD OF SUPERVISORS BY RESOLUTION NO. 97-2586 DATED AND ADOPTED MAY 14, 1997. THE BOARD OF SUPERVISORS HAS HEREBY REPEALED AND ABANDONED THE PERMANENT EASEMENT FOR PACIFIC GAS AND ELECTRIC COMPANY UTILITIES WITHIN THE LIMITS OF THE ABANDONED JOHNSON CANYON ROAD.  
 9. JOHNSON CANYON ROAD  
 VACATED AND ABANDONED BY THE MONTEREY COUNTY BOARD OF SUPERVISORS BY RESOLUTION NO. 97-2586 DATED AND ADOPTED MAY 14, 1997. THE BOARD OF SUPERVISORS HAS HEREBY REPEALED AND ABANDONED THE PERMANENT EASEMENT FOR PACIFIC GAS AND ELECTRIC COMPANY UTILITIES WITHIN THE LIMITS OF THE ABANDONED JOHNSON CANYON ROAD.  
 10. JOHNSON CANYON ROAD  
 VACATED AND ABANDONED BY THE MONTEREY COUNTY BOARD OF SUPERVISORS BY RESOLUTION NO. 97-2586 DATED AND ADOPTED MAY 14, 1997. THE BOARD OF SUPERVISORS HAS HEREBY REPEALED AND ABANDONED THE PERMANENT EASEMENT FOR PACIFIC GAS AND ELECTRIC COMPANY UTILITIES WITHIN THE LIMITS OF THE ABANDONED JOHNSON CANYON ROAD.

**FLOOD PLAIN NOTE:**  
 LOCATED WITHIN TIME "C" 100-YEAR FLOODPLAIN, AS SHOWN ON FEMA FLOOD INSURANCE RATE MAP 06030250G AND MAP 06030250G, EFFECTIVE DATE APRIL 2, 2009.

DOCUMENT REFERENCES:	DESCRIPTION	LEGAL DOCUMENT
PARCEL "A"	APN 416-491-001 NE 1/4 SEC. 2, T. 16 S., R. 5 E., S. 1/2 NW 1/4 SEC. 2 M.D.M. (RES. 20 AC±) PG. 239 12/2/1919	CERTIFICATE OF COMPLIANCE REEL 495-08-PAGE 514 7/29/1996
PARCEL "B"	APN 416-491-002 NE 1/4 SEC. 2, T. 16 S., R. 5 E., S. 1/2 NW 1/4 SEC. 2 M.D.M. (RES. 88 AC±) PG. 240 12/2/1919	USA VOL. E - PAGES - PG. 28
PARCEL "C"	APN 416-491-003 NE 1/4 SEC. 2, T. 16 S., R. 5 E., S. 1/2 NW 1/4 SEC. 2 M.D.M. (RES. 88 AC±) PG. 240 12/2/1919	USA VOL. E - PAGES - PG. 27

**SURVEYOR'S STATEMENT:**  
 THIS MAP WAS PREPARED BY ME OR UNDER MY CLOSE PERSONAL SUPERVISION AND I AM A LICENSED SURVEYOR IN THE STATE OF CALIFORNIA.  
 PHILIP L. FREEMAN, L.S. 4448  
 LICENSE EXPIRES 9/30/15

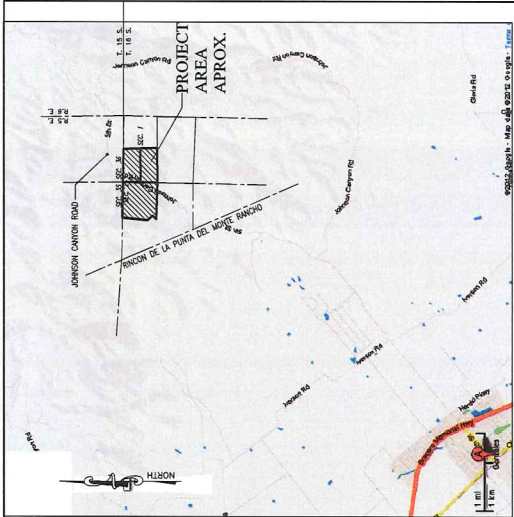

**PROJECT INFORMATION:**  
 PROJECT DESCRIPTION: LANCE BAITSTICH, 681 000 SINCE ROAD, SALINAS, CA 93908  
 PROJECT ADDRESS: 681 000 SINCE ROAD, SALINAS, CA 93908  
 ZONING: PG-40  
 EXISTING USE: GRADING  
 PROPOSED USE: GRADING  
 TREE REMOVAL: N/A

**UTILITIES:**

1. WATER SUPPLY	(W) 10" GAL. WATER TANK
2. SEWER SERVICE	(S) 8" SEWIC SYSTEM
3. ELECTRICITY SUPPLY	(E) 8" POSE
4. GAS SUPPLY	(G) PROPANE

**OCCUPANCY TABLE:**

STRUCTURE	EXISTING	PROPOSED
1. RESIDENCE	R-3	R-3
2. SHED	U	U

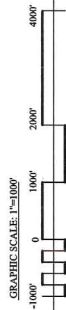

**PLN 120829**  
**APPLICATION MAP**  
**LOT LINE ADJUSTMENT**  
 APN 416-481-020, APN 416-481-021, & APN 416-481-028

THIS MAP IS A PRELIMINARY APPLICATION MAP FOR THE LOT LINE ADJUSTMENT OF PARCELS 1, 2, AND 3, S. 1/2 NW 1/4 SEC. 2, T. 16 S., R. 5 E., M.D.M. (RES. 318 AC±) PG. 239, 240, 241, 242, 243, 244, 245, 246, 247, 248, 249, 250, 251, 252, 253, 254, 255, 256, 257, 258, 259, 260, 261, 262, 263, 264, 265, 266, 267, 268, 269, 270, 271, 272, 273, 274, 275, 276, 277, 278, 279, 280, 281, 282, 283, 284, 285, 286, 287, 288, 289, 290, 291, 292, 293, 294, 295, 296, 297, 298, 299, 300, 301, 302, 303, 304, 305, 306, 307, 308, 309, 310, 311, 312, 313, 314, 315, 316, 317, 318, 319, 320, 321, 322, 323, 324, 325, 326, 327, 328, 329, 330, 331, 332, 333, 334, 335, 336, 337, 338, 339, 340, 341, 342, 343, 344, 345, 346, 347, 348, 349, 350, 351, 352, 353, 354, 355, 356, 357, 358, 359, 360, 361, 362, 363, 364, 365, 366, 367, 368, 369, 370, 371, 372, 373, 374, 375, 376, 377, 378, 379, 380, 381, 382, 383, 384, 385, 386, 387, 388, 389, 390, 391, 392, 393, 394, 395, 396, 397, 398, 399, 400, 401, 402, 403, 404, 405, 406, 407, 408, 409, 410, 411, 412, 413, 414, 415, 416, 417, 418, 419, 420, 421, 422, 423, 424, 425, 426, 427, 428, 429, 430, 431, 432, 433, 434, 435, 436, 437, 438, 439, 440, 441, 442, 443, 444, 445, 446, 447, 448, 449, 450, 451, 452, 453, 454, 455, 456, 457, 458, 459, 460, 461, 462, 463, 464, 465, 466, 467, 468, 469, 470, 471, 472, 473, 474, 475, 476, 477, 478, 479, 480, 481, 482, 483, 484, 485, 486, 487, 488, 489, 490, 491, 492, 493, 494, 495, 496, 497, 498, 499, 500, 501, 502, 503, 504, 505, 506, 507, 508, 509, 510, 511, 512, 513, 514, 515, 516, 517, 518, 519, 520, 521, 522, 523, 524, 525, 526, 527, 528, 529, 530, 531, 532, 533, 534, 535, 536, 537, 538, 539, 540, 541, 542, 543, 544, 545, 546, 547, 548, 549, 550, 551, 552, 553, 554, 555, 556, 557, 558, 559, 560, 561, 562, 563, 564, 565, 566, 567, 568, 569, 570, 571, 572, 573, 574, 575, 576, 577, 578, 579, 580, 581, 582, 583, 584, 585, 586, 587, 588, 589, 590, 591, 592, 593, 594, 595, 596, 597, 598, 599, 600, 601, 602, 603, 604, 605, 606, 607, 608, 609, 610, 611, 612, 613, 614, 615, 616, 617, 618, 619, 620, 621, 622, 623, 624, 625, 626, 627, 628, 629, 630, 631, 632, 633, 634, 635, 636, 637, 638, 639, 640, 641, 642, 643, 644, 645, 646, 647, 648, 649, 650, 651, 652, 653, 654, 655, 656, 657, 658, 659, 660, 661, 662, 663, 664, 665, 666, 667, 668, 669, 670, 671, 672, 673, 674, 675, 676, 677, 678, 679, 680, 681, 682, 683, 684, 685, 686, 687, 688, 689, 690, 691, 692, 693, 694, 695, 696, 697, 698, 699, 700, 701, 702, 703, 704, 705, 706, 707, 708, 709, 710, 711, 712, 713, 714, 715, 716, 717, 718, 719, 720, 721, 722, 723, 724, 725, 726, 727, 728, 729, 730, 731, 732, 733, 734, 735, 736, 737, 738, 739, 740, 741, 742, 743, 744, 745, 746, 747, 748, 749, 750, 751, 752, 753, 754, 755, 756, 757, 758, 759, 760, 761, 762, 763, 764, 765, 766, 767, 768, 769, 770, 771, 772, 773, 774, 775, 776, 777, 778, 779, 780, 781, 782, 783, 784, 785, 786, 787, 788, 789, 790, 791, 792, 793, 794, 795, 796, 797, 798, 799, 800, 801, 802, 803, 804, 805, 806, 807, 808, 809, 810, 811, 812, 813, 814, 815, 816, 817, 818, 819, 820, 821, 822, 823, 824, 825, 826, 827, 828, 829, 830, 831, 832, 833, 834, 835, 836, 837, 838, 839, 840, 841, 842, 843, 844, 845, 846, 847, 848, 849, 850, 851, 852, 853, 854, 855, 856, 857, 858, 859, 860, 861, 862, 863, 864, 865, 866, 867, 868, 869, 870, 871, 872, 873, 874, 875, 876, 877, 878, 879, 880, 881, 882, 883, 884, 885, 886, 887, 888, 889, 890, 891, 892, 893, 894, 895, 896, 897, 898, 899, 900, 901, 902, 903, 904, 905, 906, 907, 908, 909, 910, 911, 912, 913, 914, 915, 916, 917, 918, 919, 920, 921, 922, 923, 924, 925, 926, 927, 928, 929, 930, 931, 932, 933, 934, 935, 936, 937, 938, 939, 940, 941, 942, 943, 944, 945, 946, 947, 948, 949, 950, 951, 952, 953, 954, 955, 956, 957, 958, 959, 960, 961, 962, 963, 964, 965, 966, 967, 968, 969, 970, 971, 972, 973, 974, 975, 976, 977, 978, 979, 980, 981, 982, 983, 984, 985, 986, 987, 988, 989, 990, 991, 992, 993, 994, 995, 996, 997, 998, 999, 1000.

PREPARED FOR:  
**LANCE BAITSTICH**  
 681 000 SINCE ROAD  
 SALINAS, CA 93908

DATE: 11/17/2014  
 SHEET ONE OF ONE  
 REVISION: 1/07/2014



This page intentionally left blank.