

**PROJECT TITLE: Roof Repairs & Renovations
County of Monterey**

Roof Replacement Courthouse

ADDRESS: 1200 Aguajito, Monterey CA

PROJECT NO.: 8543

DRAWING TABLE OF CONTENTS

- A-1 Title Page
- A-2 Roof Plan Drawing
- A-3 Details
- A-4 Details
- A-5 Roof Drainage

Drawn by:
Bryan Schalesky
Skyline Engineering

David Pratt
Project Manager, Facilities
County of Monterey,
Resource Management Agency
Department of Public Works
(831) 795-6091
prattidw@co.monterey.ca.us



No.	Revision/Issue	Date

Firm Name and Address
SKYLINE ENGINEERING, INC.
8100 Wild Horse Road
Salinas CA 93907

PROJECT TITLE:
Roof Repairs and Renovations
County of Monterey
Roof Replacement
Courthouse
ADDRESS: 1200 Aguajito
Monterey CA
PROJECT NO.: 8543

Date	Sheet
Dec 2013	A-1 Title Page

<p style="text-align: center;">SECTION 00 24 00 PROCUREMENT SCOPE (Master Scope of Work)</p> <p>A. Remove existing roofing system, insulation, and flashings in accordance with section 02 41 19.13, Selective Building Demolition, 02 82 00 Asbestos Remediation, and 02 83 00 Lead Remediation.</p> <p>B. Provide odor control measures at all air intakes as specified in section 07 54 00 Thermoplastic Membrane Roofing.</p> <p>C. Check decking for deflection. Modify decking in order to eliminate deflected areas that may cause ponding as specified in section 07 54 00 Thermoplastic Membrane Roofing. For bid purposes, contractor shall include the modification of 2% (350 square feet at the Courthouse) of the roof deck surface in order to eliminate deflection. This shall be bid into the base bid as an allowance. If more is needed, additional funds may be authorized based upon unit costs. If less is needed, credit will be given back to the owner per unit prices.</p> <p>D. Install wood nailers and curbs in order to accommodate increased insulation heights in accordance with section 06 10 00 Rough Carpentry.</p> <p>E. Adhere 1/4" per foot tapered isocyanurate insulation and coverboard to the deck as specified in section 07 54 00 Thermoplastic Membrane Roofing.</p> <p>F. Install drainage crickets as specified in section 07 54 00 Thermoplastic Membrane Roofing.</p> <p>G. Install crickets on the high sides of all curbs as specified in section 07 54 00 Thermoplastic Membrane Roofing.</p> <p>H. Add alternate: Install temporary roof and cellular insulating concrete slope to drain as specified in section 03 52 16 Lightweight Insulating Concrete.</p> <p>I. Adhere specified 80 mil PVC membrane as specified in section 07 54 00 Thermoplastic Membrane Roofing.</p> <p>J. Install walkpads from roof access points to all serviceable equipment as specified in section 07 54 00 Thermoplastic Membrane Roofing and shown on the plan drawings.</p> <p>K. Install pipe hangers under all chiller lines, electrical conduits, condensation lines and other horizontal lines running along the roof as specified in section 07 54 00 Thermoplastic Membrane Roofing and shown on the detail drawings.</p> <p>L. Perimeter and projection flashings:</p> <ol style="list-style-type: none"> 1. Provide all flashing and penetration details in accordance with the detail drawings and manufacturer guidelines as specified in section 07 54 00 Thermoplastic Membrane Roofing. 2. Drawings included with these specifications are not meant to accurately depict substrate conditions. They are meant to provide NRCA guidelines for basic flashing installation according to the system specified. 3. If a manufacturer standard and required detail differs from that shown on the project detail drawings included in these specifications, contractor shall submit manufacturer approved drawing to the Owner and Engineer for approval. If the manufacturer requirements for a flashing detail is less stringent than those shown in the project drawings, the more stringent flashing detail shall govern with the approval of the manufacturer providing the warranty for this project. <p>M. Provide owner with a five (5) year contractor guarantee as specified in section 07 54 00 Thermoplastic Membrane Roofing.</p> <p>N. Provide owner with a twenty (20) year no-dollar-limit manufacturer warranty covering labor, materials, and metal flashings as specified in section 07 54 00 Thermoplastic Membrane Roofing.</p>		<p>APPLICABLE CODES:</p> <ol style="list-style-type: none"> 1. 2013 CALIFORNIA CODE OF REGULATIONS TITLE 24 - PARTS 1, 2, 6, 9 and 12. 2. STATE OF CALIFORNIA TITLE 24 (2013 EDITION) - PART 4 CALIFORNIA MECHANICAL CODE/AMMENDMENTS WITH 2000 UMC 3. STATE OF CALIFORNIA TITLE 24 (2013 EDITION) - PART 5 CALIFORNIA PLUMBING CODE WITH 2000 UPC 4. STATE OF CALIFORNIA TITLE 24 (2013 EDITION) - PART 6 CALIFORNIA ENERGY CODE ROOFING SYSTEM SHALL POSSESS A COOL ROOF RATING FROM THE CALIFORNIA COOL ROOF RATING COUNCIL. 5. STATE OF CALIFORNIA TITLE 24 (2013 EDITION) - PART 9 CALIFORNIA FIRE CODE/AMMENDMENTS WITH 2000 UFC 6. STATE OF CALIFORNIA TITLE 24 (2013 EDITION) - PART 12 CALIFORNIA REFERENCED STANDARDS CODE 7. TITLE 19, CCR, PUBLIC SAFETY, STATE FIRE MARSHAL REGULATIONS 8. 2008 CALIFORNIA ENERGY CODE 9. NRCA (LATEST EDITION) NATIONAL ROOFING CONTRACTORS ASSOCIATION GUIDELINES 10. UL 790 Class A fire rating. 11. ASCE 7-05 Wind Design loads as follows: Field - 26.70 psf, Perimeter - 40.49 psf, Corners - 57.72 psf.
--	--	---

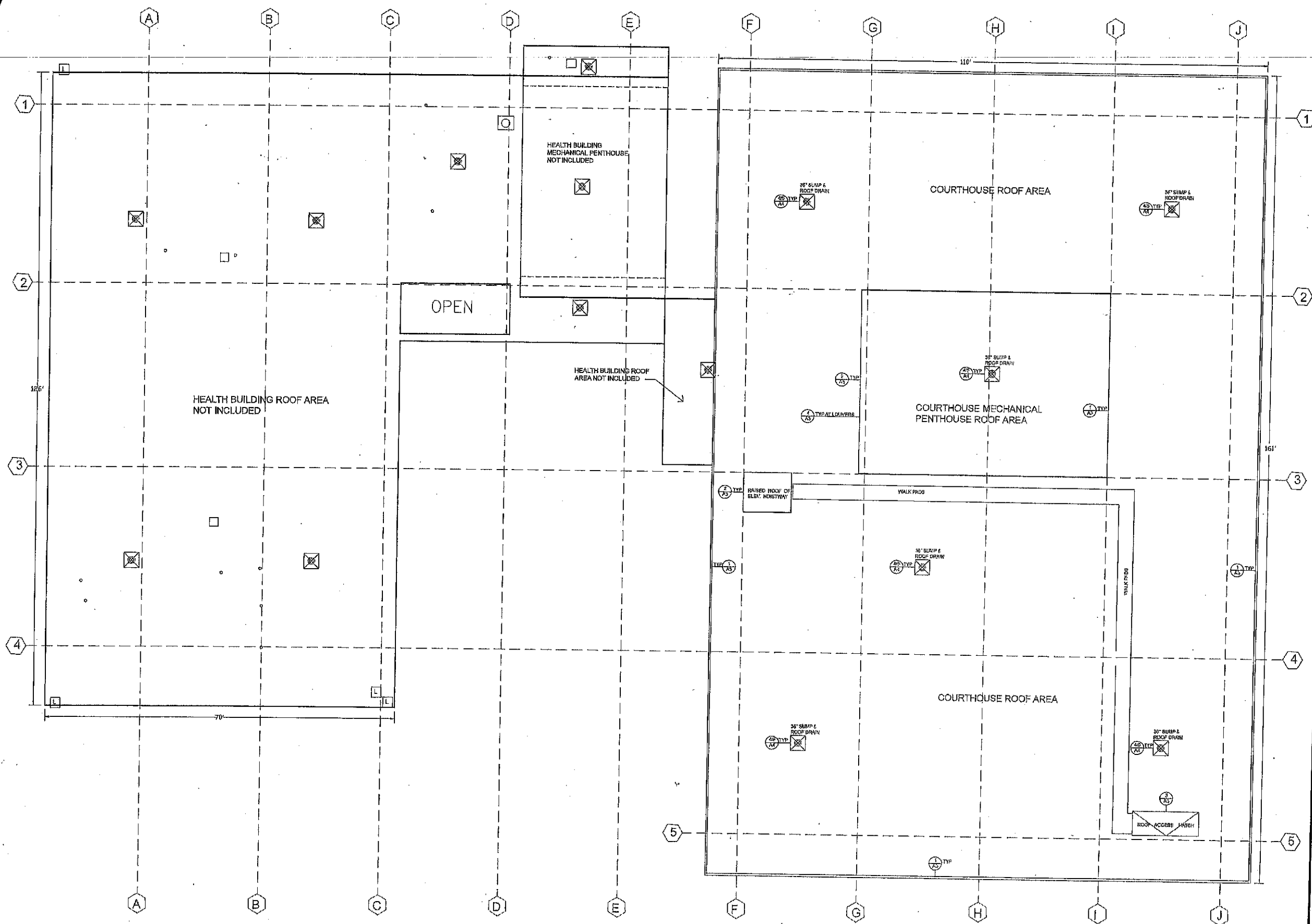

General Notes

Equipment and projection locations are approximate.
 Not all projections are shown.
 Contractors are responsible for all measurements and projection counts. Not all projections are shown.
 Horizontal conditions not shown.
 Scale Check: 0', 10', 20', 30'

Drawn by:
 Bryan Schalesky
 Skyline Engineering

David Pratt
 Project Manager, Facilities
 County of Monterey,
 Resource Management Agency
 Department of Public Works
 (831) 796-8091
prattdw@co.monterey.ca.us

No.	Revision/Issue	Date

Project Name and Address

SKYLINE ENGINEERING
 8100 Wild Horse Road
 Salinas CA 93907

Project Name and Address

PROJECT TITLE:
 Roof Repairs and Renovations
 County of Monterey
 Courthouse
 Roof Replacement
ADDRESS: 1200 Aguajito
 Monterey CA
PROJECT NO.: 8543

Project: Roofing @ County Courthouse Bldg	Sheet: A-2
Date: Dec 2013	Roof Plan
Scale: 1" = 16'	1/16" = 1'

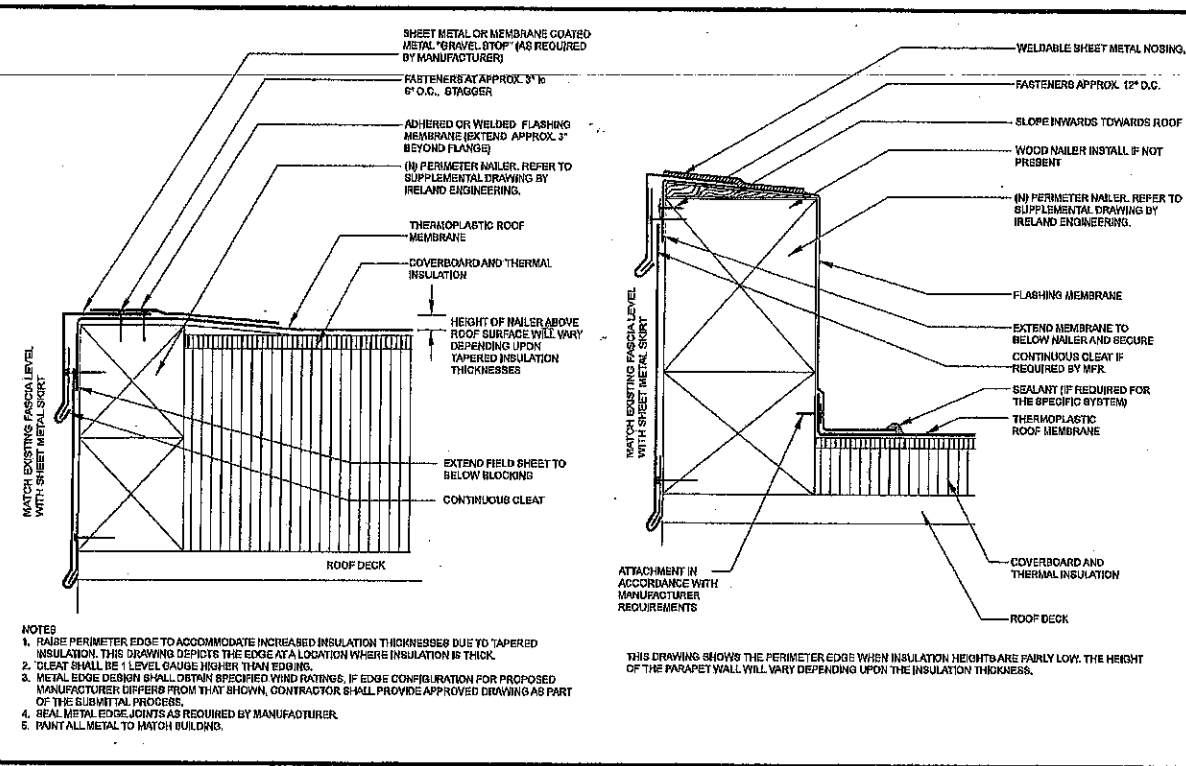

1
A-3 PERIMETER RAISED EDGE FLASHING

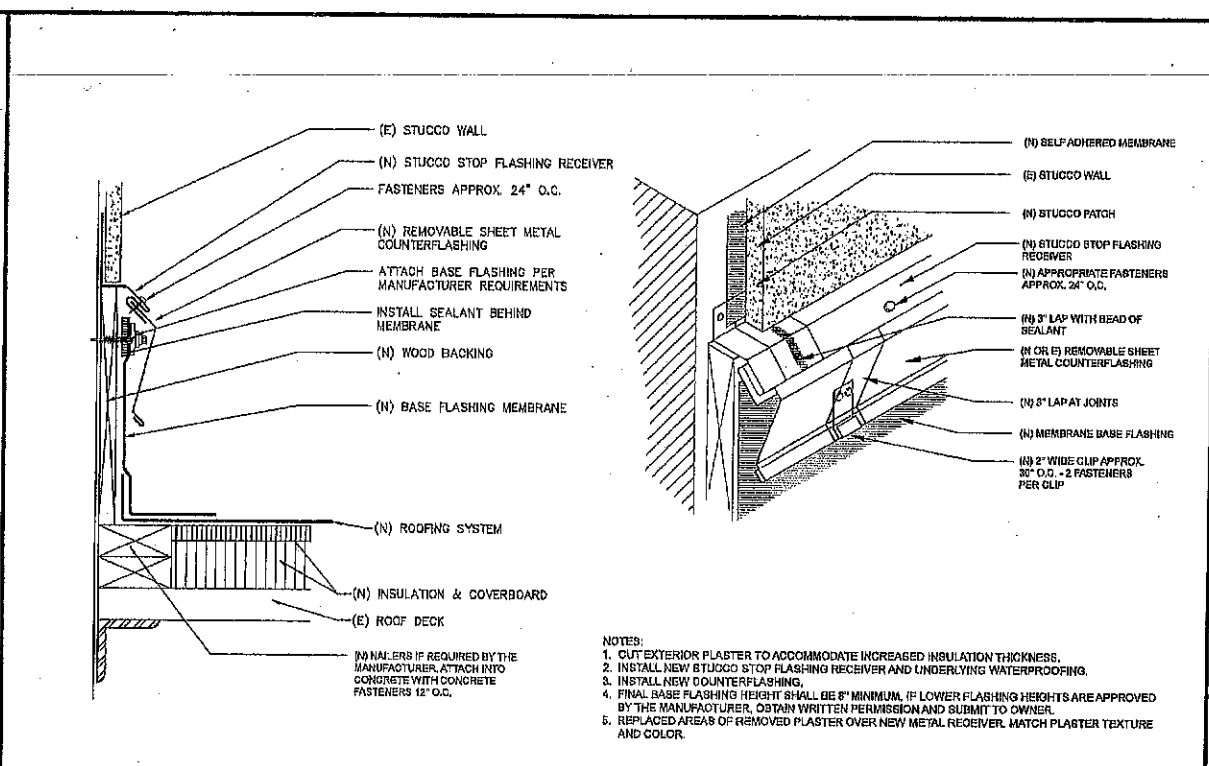

2
A-3 STUCCO STOP WALL FLASHING SYSTEM

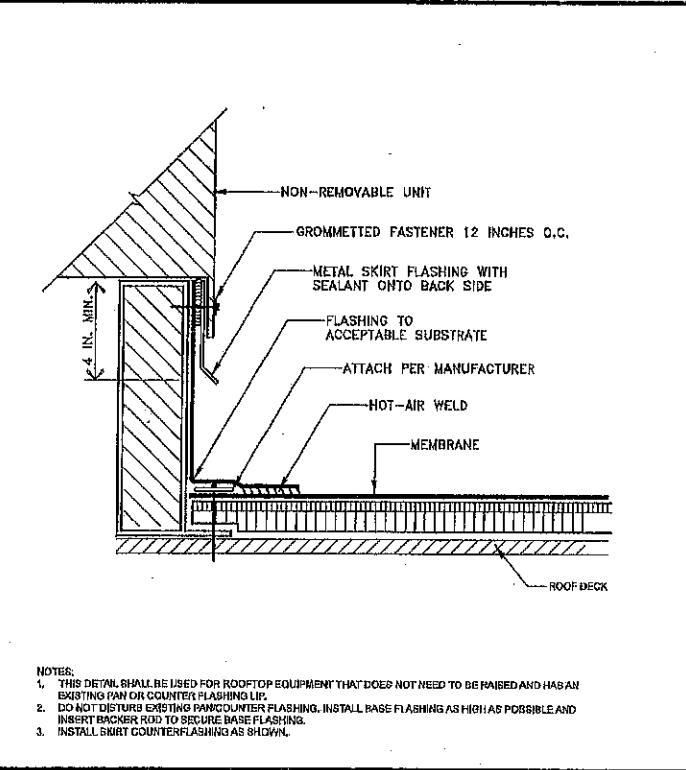

3
A-3 EQUIPMENT SKIRT FLASHING

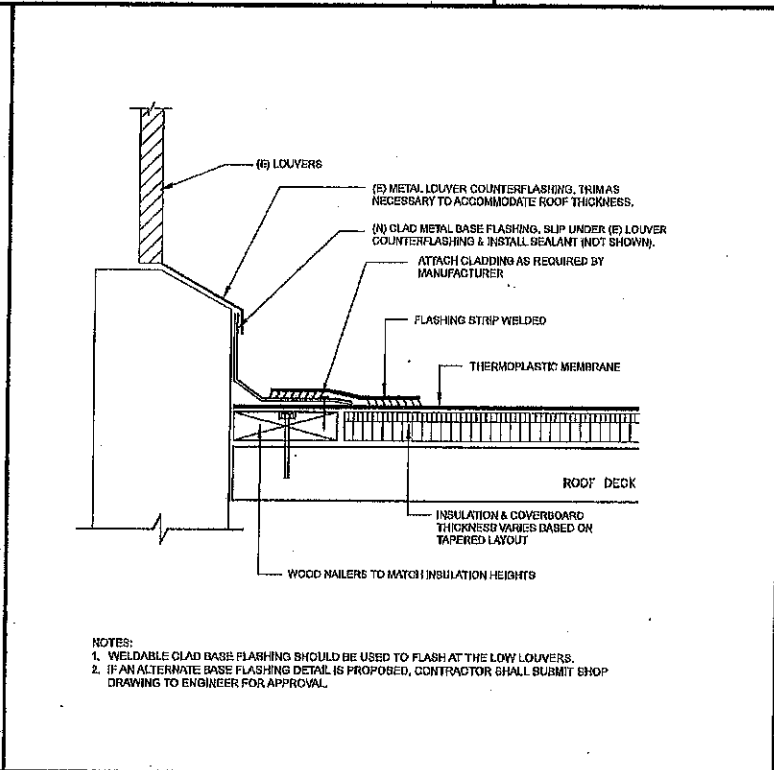

4
A-3 BASE FLASHING AT LOW LOUVERS

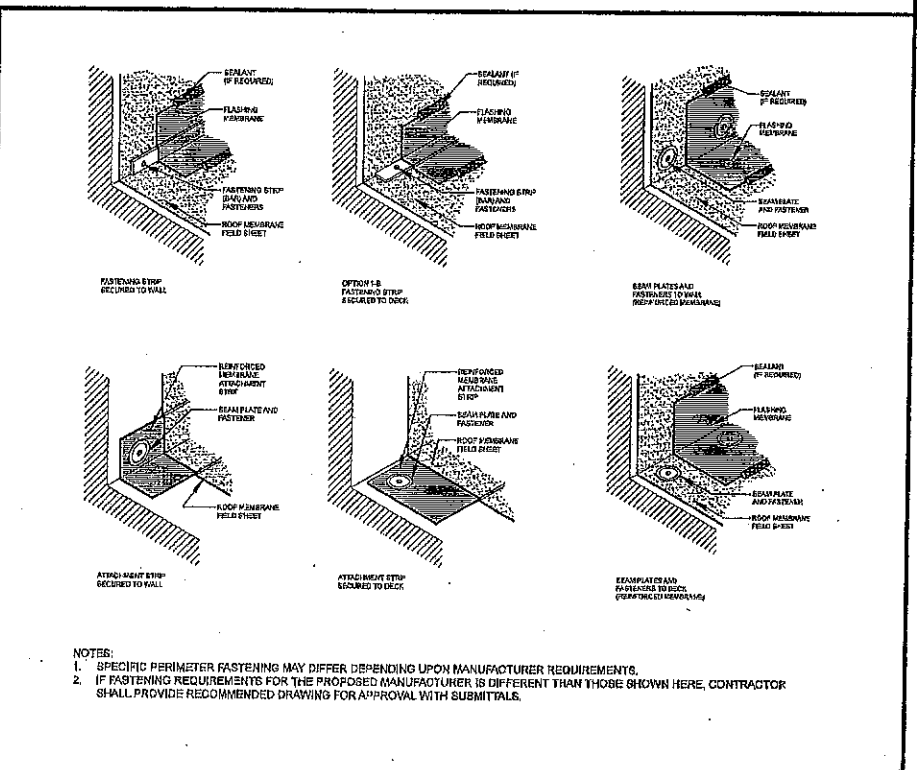

5
A-3 OPTIONS FOR PERIMETER BASE SECUREMENT (ROOF-TO-WALL AND ROOF-TO-CURB INTERSECTIONS)

GENERAL NOTES

The purpose of these detail drawings is to provide the installer with a basic guideline for the installation of termination and projection flashings.

These drawings do not depict as-built conditions for the substrate.

Where field conditions warrant alteration of these details, the installer shall notify the owner and design engineer.

If conflict exists between these detail drawings and the flashing details as published by the manufacturer providing the warranty for this project, the more stringent requirements shall govern.

Use these detail drawings in conjunction with written specifications.

Drawn by:
Bryan Schalesky
Skyline Engineering

No.	Revision/Issue	Date

Project Name and Address

SKYLINE ENGINEERING
8100 Wildhorse Road
Salinas CA 93907

Project Name and Address

PROJECT TITLE:
Roof Repair and Renovations
County of Monterey
Roof Replacement
Courthouse
ADDRESS: 1000 Arguillo
Monterey CA
PROJECT NO.: 8843

Project Roof Replacement	Sheet A-3 Flashing Details
Date Dec 2013	
Scale None	

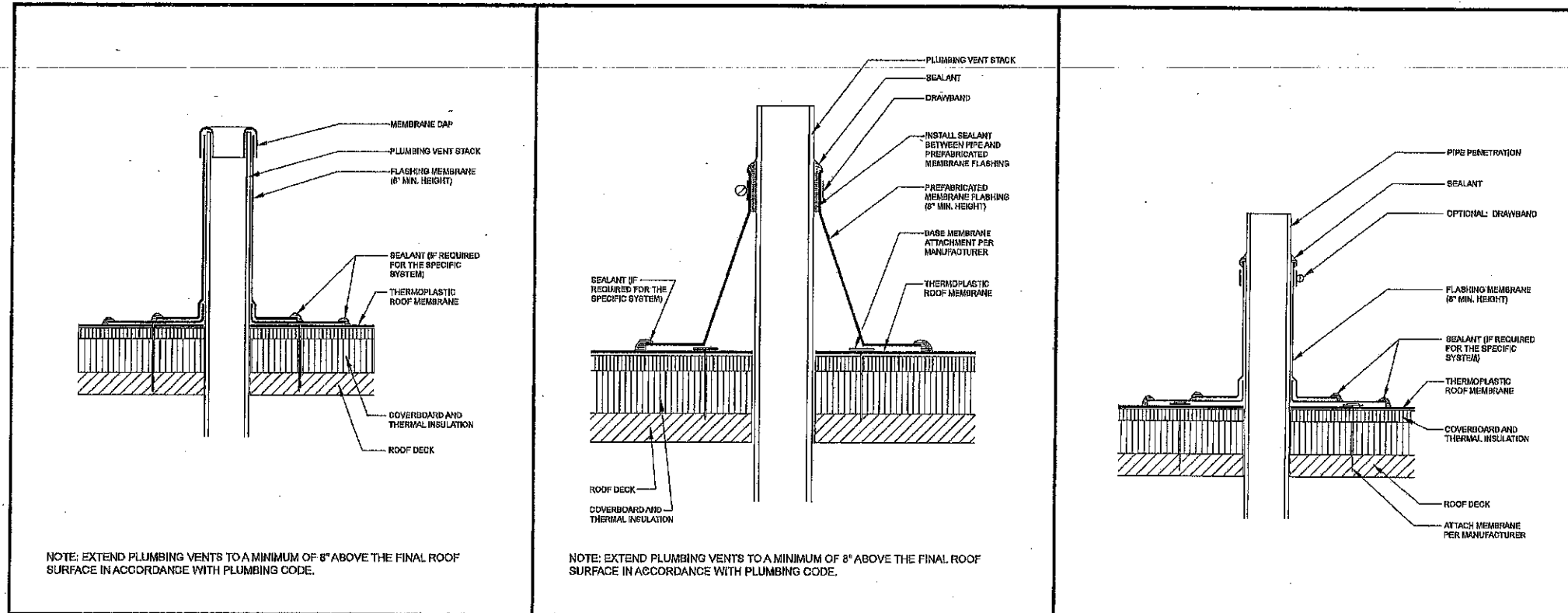

1
A-4 PLUMBING VENT (FIELD WRAP)

2
A-4 PLUMBING VENT (PREMANUFACTURED BOOT)

3
A-4 PIPE PENETRATION (FIELD WRAP)

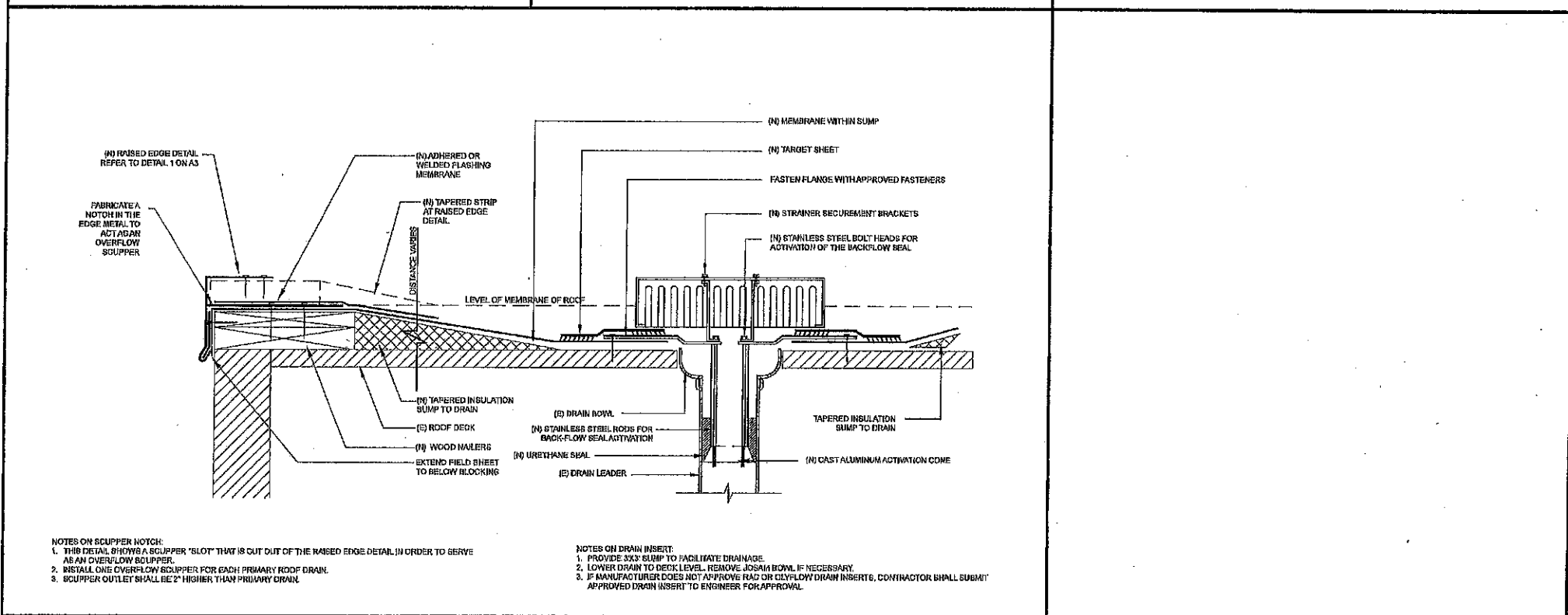

4
A-4 SCUPPER THROUGH ROOF EDGE

5
A-4 DRAIN INSERT

6
A-5 THIS AREA BLANK

GENERAL NOTES

The purpose of these detail drawings is to provide the installer with a basic guideline for the installation of foundation and projection flashings.

These drawings do not depict so-built conditions for the site/works.

Where field conditions warrant alteration of these details, the installer shall notify the owner and design engineer.

If conflict exists between these detail drawings and the flashing details as published by the manufacturer, provided the warranty for this project, the more stringent requirements shall govern.

Use these detail drawings in conjunction with written specifications.

Drawn by:
 Bryan Schalesky
 Skyline Engineering



No.	Revision/Issue	Date

Firm Name and Address
SKYLINE ENGINEERING
 8100 Wild Horse Road
 Salinas CA 93907

Project Name and Address
PROJECT TITLE:
 Roof Repairs and Renovations
 County of Monterey
 Roof Replacement
 Courthouse
 ADDRESS: 1200 Agujito
 Monterey CA
 PROJECT NO.: 8643

Project: Roof Replacement	Sheet: A-4 Penetration Details
Date: Dec 2013	Scale: none

NO OVERFLOW DRAINAGE TROUGH & SCUPPER OUTLET
SEE DETAILS 4 & 5 ON A-4
VIEW

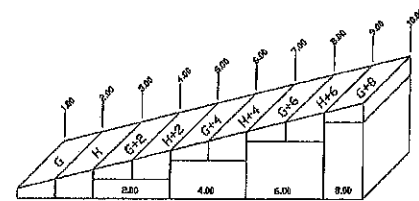
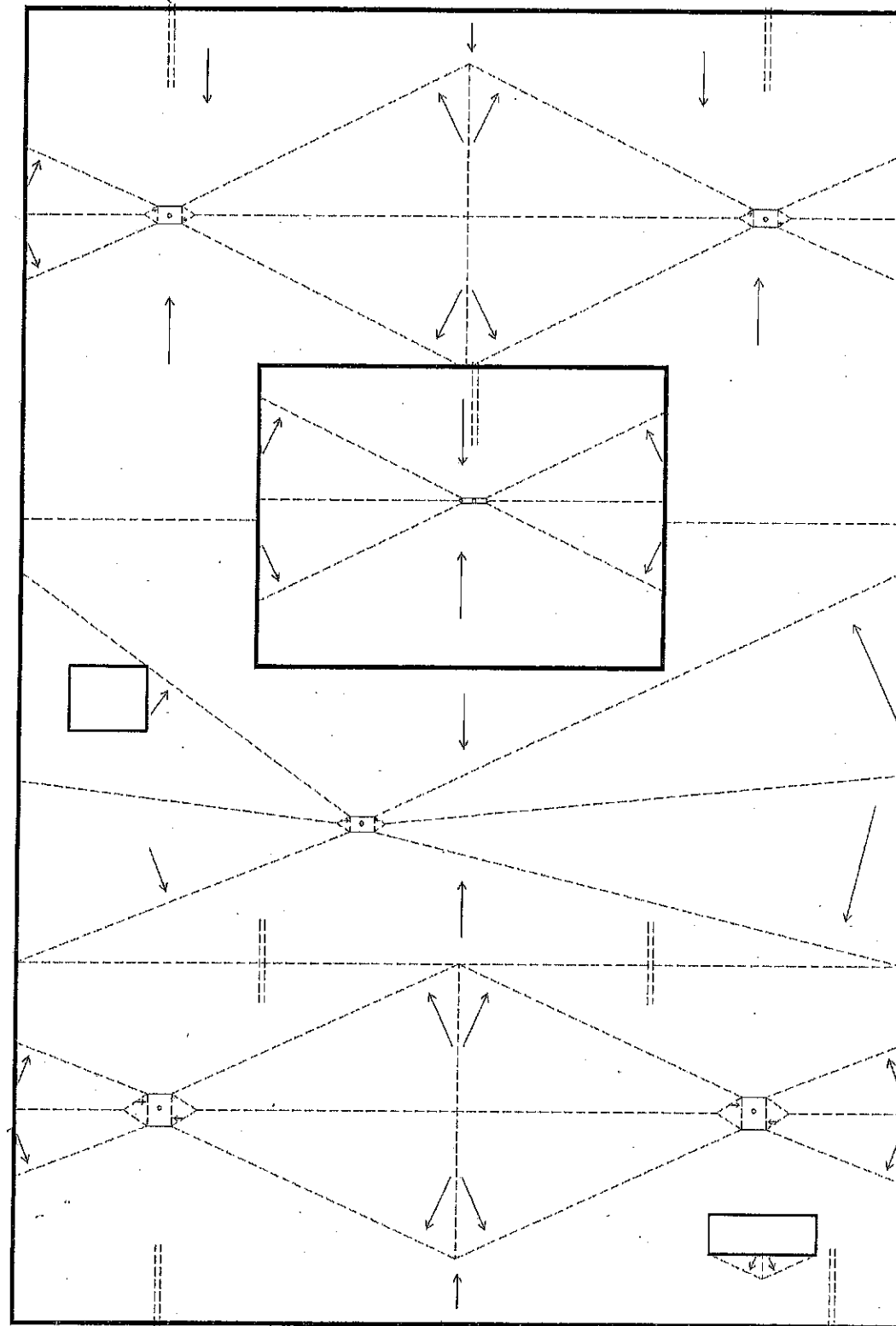

TYPICAL CROSS SECTION - 1/4" PER FOOT
NOT TO SCALE

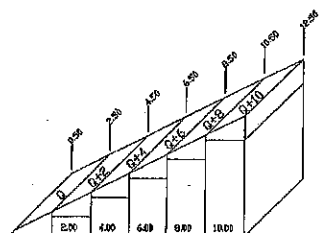

TYPICAL CROSS SECTION - 1/2" PER FOOT
NOT TO SCALE

General Notes

Install 1/4" per foot tapered insulation and crickets as shown. Cricket slope shall be 1/2" per foot.

Contractor are responsible for all measurements and projection counts. Not all projections are shown.

Contractor shall raise any and all plumbing vents, curbs or flashings in order to enable the installation of the specified tapered insulation system.

If contractor would like to alter tapered insulation layout from that shown, provide drawing during submittal process for review by owner and engineer.

Drain stumps shall have tapered insulation installed in order to provide a continuous slope into the drain. Stump dimensions can be modified in order to maximize efficiency of tapered system.

Paradele edges shall be raised in order to accommodate insulator/cricket thicknesses.

All primary drains shall have overflow scuppers and/or overflow scuppers and troughs as shown, exact locations may vary, overflow outlets must be 2" above primary drains. Widths of scuppers shall be 6"

Drainage crickets on the high sides of curbs shall have a width that is 1/3 the length.



Drawn by:
Bryan Schalesky
Skyline Engineering

No.	Revision/Issue	Date

Firm Name and Address

SKYLINE ENGINEERING
8100 Wildhorse Road
Ballinas CA 93907

Project Name and Address

PROJECT TITLE:
Roof Repairs and Renovations
County of Monterey
Roof Replacement
Courthouse
ADDRESS: 1200 Aguelito
Monterey CA
PROJECT NO.: 8843

Project Roofing @ County
Courthouse Bldg

Date
Dec 2013

Scale
1" = 16'
1/16" = 1'

Sheet
A-5
Roof
Drainage
Plan

IRELAND ENGINEERING
 Joseph M. Otto, P.E.
 California License # CE 049527
 Nevada License # 020532
 4351 Mission Boulevard, Suite 110, Fremont, CA 94599
 (510) 438-0689 FAX (510) 438-9632
 E-Mail: drawings@irelandeng.com

Job No. 8280.
 HEALTH BUILDING &
 COURTHOUSE.
 Date 3/25/10 By GJB.
 Sheet SK1. Of 1

1200 AGUAJITO, MONTEREY, CA.

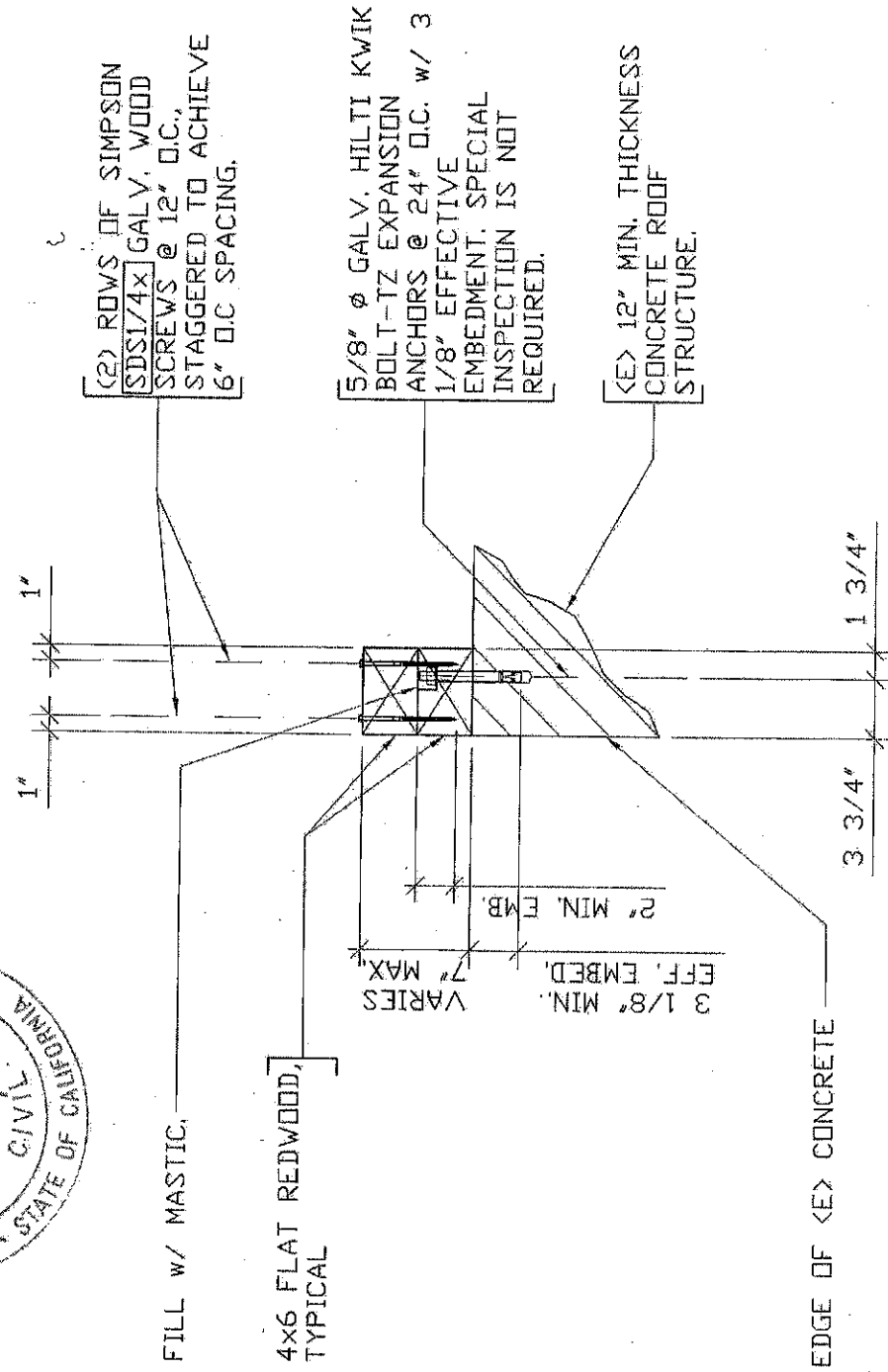
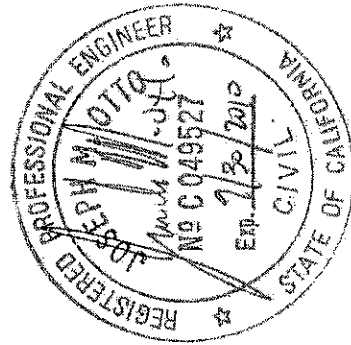

8280001 SCALE 1"=1'-0"

REFER TO DETAIL 1 / SHEET A-3 BY SKYLINE ENGINEERING FOR ITEMS NOT NOTED.

C:\Documents and Settings\Gary Birch\My Documents\Drawing2.dwg, 3/25/2010 5:03:02 PM, IISHPLaserJet4V