

Customer Site Name:
Customer Site ID:

Crown Site Name: Bryant Canyon
Crown Business Unit: 839198
License Number: 179772
Amendment Number: 380555

FIRST AMENDMENT TO WIRELESS COMMUNICATION SITE LEASE AGREEMENT

This First Amendment to Wireless Communication Site Lease Agreement (this "Amendment") is made this _____ day of _____, 20____, by and between Crown Castle MU LLC, a Delaware limited liability company (f/k/a Mountain Union Telecom, LLC) ("Crown") and County of Monterey, a political subdivision of the State of California ("Customer").

WHEREAS, Crown (and/or certain of its predecessors-in-interest) and Customer (and/or certain of its predecessors-in-interest) entered into a certain Wireless Communication Site Lease Agreement dated June 24, 2008, as may have been previously amended and/or assigned (hereinafter the "TLA"), whereby Customer leases or licenses from Crown certain space at a telecommunications facility described in the TLA (the "Site"), and

WHEREAS, Crown and Customer desire to amend the TLA pursuant to the terms and subject to the conditions set forth herein.

NOW, THEREFORE, for good and valuable consideration, the receipt and sufficiency of which are hereby acknowledged, the parties hereto agree to be legally bound to this Amendment as follows:

1. Unless clear from the context in which they are used, all capitalized terms used herein shall have the same meanings ascribed to them in the TLA.
2. The monthly fee due under the TLA shall increase by One Thousand and 00/100 Dollars (\$1,000.00) on March 1, 2014.
3. The parties acknowledge that Customer is making certain modifications to its space and/or equipment at the Site as described in Attachment A, attached hereto.
4. The descriptions of Customer's space on the ground set forth in the TLA (including, without limitation, any descriptions of Customer's space on the ground set forth in any schedules, exhibits or attachments to the TLA) are hereby amended and deleted in their entirety and replaced and superseded by and with the descriptions of Customer's space on the ground set forth in Attachment A and Attachment B, attached hereto.
5. The descriptions of Customer's space on the tower set forth in the TLA (including, without limitation, any descriptions of Customer's space on the tower set forth in any schedules, exhibits or attachments to the TLA) are hereby amended and deleted in their entirety and replaced and superseded by and with the descriptions of Customer's space on the tower set forth in Attachment A and Attachment C, attached hereto.
6. The equipment descriptions and specifications with respect to Customer's tower-mounted equipment and Customer's ground-based equipment set forth in the TLA (including, without limitation, any equipment descriptions and specifications with respect to Customer's tower-mounted equipment and Customer's ground-based equipment set forth in any schedules, exhibits or attachments to the TLA) are hereby amended and deleted in their entirety and replaced and superseded by and with the equipment descriptions and specifications with respect to Customer's tower-mounted equipment and Customer's ground-based equipment set forth in Attachment A, Attachment B and Attachment C, attached hereto.

Prepared by: J.Ogbunugafor
Prepared on: January 30, 2014
Revised on:
Master Exhibit Version: 09/13/06

LRF Rev. #: 1
App Rev. #: 8

Template Version: 7/9/13

Customer Site Name:
Customer Site ID:

Crown Site Name: Bryant Canyon
Crown Business Unit: 839198
License Number: 179772
Amendment Number: 380555

7. Except as expressly set forth in this Amendment, the TLA is otherwise unmodified, shall remain in full force and effect and is incorporated and restated herein as if fully set forth at length. In the event of any inconsistencies between the TLA and this Amendment, the terms of this Amendment shall control. Each reference in the TLA to itself shall be deemed to also refer to this Amendment.

[Remainder of Page Intentionally Left Blank]

Prepared by: J.Ogbunugafor
Prepared on: January 30, 2014
Revised on:
Master Exhibit Version: 09/13/06

LRF Rev. #: 1
App Rev. #: 8

Template Version: 7/9/13

Customer Site Name:
Customer Site ID:

Crown Site Name: Bryant Canyon
Crown Business Unit: 839198
License Number: 179772
Amendment Number: 380555

IN WITNESS WHEREOF, the parties have set forth their hand and seal as of the date indicated above.

CROWN:

Crown Castle MU LLC,
a Delaware limited liability company

By: _____

Print Name: _____

Title: _____

Execution Date: _____

CUSTOMER:

County of Monterey,
a political subdivision of the State of California

By: _____

Print Name: _____

Title: _____

Execution Date: _____

Prepared by: J.Ogbunugafor
Prepared on: January 30, 2014
Revised on:
Master Exhibit Version: 09/13/06

LRF Rev. #: 1
App Rev. #: 8

Template Version: 7/9/13

Customer Site Name:
Customer Site ID:

Crown Site Name: Bryant Canyon
Crown Business Unit: 839198
License Number: 179772
Amendment Number: 380555

ATTACHMENT A

Site Engineering Application

(See attached approved Site Engineering Application)

Prepared by: J.Ogbunugafor
Prepared on: January 30, 2014
Revised on:
Master Exhibit Version: 09/13/06

LRF Rev. #: 1
App Rev. #: 8

Template Version: 7/9/13



Customer Approved: Jan 28 2014

Application ID: 168049

Revision # 8 Submitted: Oct 03 2013

Submitted By: Brittany Honikel**Original Submit Date:** Jan 07 2013**Desired Install Date:** Dec 10 2012**Reason for Application:** Adding additional equipment to existing config**JDE Job Number** 215757

Applications are subject to applicable Crown Castle engineering, regulatory, zoning/planning, and priority property-owner approval. Approval conditions may result in alternative requirements for type and/or placement of equipment. Approval conditions may also lead to additional or revised engineering analysis at Crown Castle discretion and upon consent of the customer.

Company Information

MLA: Stand Alone Agreement - TLA**Parent License #:** 179772**Company:** COUNTY OF MONTEREY**Address:** 1590 MOFFETT STREET
IT/TELECOM DEPT.**City/Town:** SALINAS**State:** CA **Postal Code:** 93905**Customer Job Number:** N/A**Customer Payment Reference:** 839198**Customer Site Name:** N/A**Customer Site Number :** N/A

Site Information

Crown Castle Site Name: Bryant Canyon**Crown Castle Site ID:** 839198**Crown Castle District:** San Francisco**Address:** .5 Miles W of Bryant Canyon Road 3 Miles North of Metzger Road**City/Town:** Soledad**State:** CA **Postal Code:** 93960**County:** Monterey**Latitude:** 36° 27' 34.1" **Longitude:** -121° 17' 58.5"**Structure Type:** GUYED **Structure Height:** 189.8 ft

Legal Entity Information

Operating Legal Entity: County of Monterey**Primary Contact:** DeAnna Hilbrants**Phone:** 8317698883**E-mail:** hilbrantsd@co.monterey.ca.us**Fax:** N/A**Address:** 1322 Natividad Road**City/Town:** Salinas**State:** CA **Postal Code:** 93906**RF Contact:** N/A**Phone:** N/A**E-mail:** N/A

Project Management Vendor

Project Management Vendor: None

Service Information

Svc	Technology	EIRP (WATTS)	Std Frequency	Frequencies		Receive	
				Start	Stop	Start	Stop
1	Digital	100.0		152.09	152.09	158.55	158.55

2	Digital	100.0		154.355	154.355	155.745	155.745
3	Digital	100.0		155.595	155.595	156.06	156.06
4	Digital	100.0		151.01	151.01	158.895	158.895
5	Digital	100.0		155.25	155.25	158.985	158.985
6	MW Link	60.0		5900.0	6800.0	5900.0	6800.0

Antenna Information

Pos.	Cust Mount Class / CAD	C Line	Mount Elev	Level	Azimuth	Leg or Face	Mfg. / Model	Transmit Svc	Transmit Start	Transmit Stop	Receive Start	Receive Stop	Use	Orient	Status
A	Pipe Mount [PM 601-1]	83	83.0	130	FT	Leg B	ANDREW PAR6-59W-PXA	6	5900.0	6800.0	5900.0	6800.0	TX/RX	Mid-Mount	Installed
B	Pipe Mount [PM 601-1]	83	83.0	295	FT	Leg C	ANDREW PAR6-59W-PXA	6	5900.0	6800.0	5900.0	6800.0	TX/RX	Mid-Mount	Installed
A	Side Arm Mount [SO 305-1]	110	110.0	230	FT	Leg B	KATHREIN K531921	1	152.09	152.09	N/A	N/A	TX	Mid-Mount	Proposed
								2	154.355	154.355	N/A	N/A	TX		
								3	155.595	155.595	N/A	N/A	TX		
A	Side Arm Mount [SO 305-1]	151	147.0	190	FT	Leg C	SINCLAIR SRL-210C-2	1	152.09	152.09	158.55	158.55	TX/RX	Upright	Installed
A	Side Arm Mount [SO 305-1]	160	160.0	0	FT	Leg A	DBSPECTRA DS1F06F36U-D	1	N/A	N/A	158.55	158.55	RX	Upright	Proposed
								2	N/A	N/A	155.745	155.745	RX		
								3	N/A	N/A	156.06	156.06	RX		
A	Side Arm Mount [SO 305-1]	174	170.0	190	FT	Leg C	SINCLAIR SRL-210C-2	1	152.09	152.09	158.55	158.55	TX/RX	Upright	Installed

Feedline Information

Pos.	Customer Mount	Qty	Mfg.	Model	Length	Location	Ladder Type	Status
------	----------------	-----	------	-------	--------	----------	-------------	--------

Class								
A	Pipe Mount	1	Primary: ANDREW Secondary: N/A	EW52	133.0	Face 1C	Banded	Installed
B	Pipe Mount	1	Primary: ANDREW Secondary: N/A	EW52	133.0	Face 1C	Banded	Installed
A	Side Arm Mount	1	Primary: RFS/CELWAVE Secondary: N/A	LCF78-50JA	160.0	Face 1C	Banded	Proposed
A	Side Arm Mount	1	Primary: ANDREW Secondary: N/A	LDF5-50A	201.0	Face 1B	Feedline Ladder	Installed
A	Side Arm Mount	1	Primary: RFS/CELWAVE Secondary: N/A	LCF78-50JA	210.0	Face 3G	Feedline Ladder	Proposed
A	Side Arm Mount	1	Primary: ANDREW	LDF4-50A	224.0	Face 3G	Feedline Ladder	Installed
		1	Secondary: ANDREW	LDF5-50A	224.0	Face 3G	Feedline Ladder	Installed

Optional Component Information

Pos.	Customer Mount Class	Qty.	Mfg.	Tower Mounted Equipment			Status
				Model	Type	Elevation	
A	Pipe Mount	N/A	N/A	N/A	N/A	N/A	N/A
B	Pipe Mount	N/A	N/A	N/A	N/A	N/A	N/A
A	Side Arm Mount	N/A	N/A	N/A	N/A	N/A	N/A
A	Side Arm Mount	N/A	N/A	N/A	N/A	N/A	N/A
A	Side Arm Mount	N/A	N/A	N/A	N/A	N/A	N/A
A	Side Arm Mount	N/A	N/A	N/A	N/A	N/A	N/A

Power Requirements

VAC	Need Crown Power	Phase	Amps
120/240	Yes	Single Phase	125

Lease, Pad, and Building Requirements

Building	Building Id #:	Building Type:	Length	Width	Height	SQ. Footage	Irregular SQ. Footage	Status
	N/A	INSHLTR						
Lease			1ft 6in	6ft 0in	N/A N/A	9.0	N/A	INSTLLD
Pad			N/A N/A	N/A N/A	N/A N/A	N/A	N/A	N/A
Building			N/A N/A	N/A N/A	N/A N/A	N/A	N/A	N/A

Other Pad Requirements

Number of Existing Cabinets:	Number of Proposed Cabinets:	Cabinet	Length	Width	Height	SQ. Footage	Irregular SQ. Footage	Status
0	3							
Lease			N/A N/A	N/A N/A	N/A N/A	N/A	N/A	N/A
Pad			N/A N/A	N/A N/A	N/A N/A	N/A	N/A	N/A
Cabinet			1ft 8in	1ft 9in	7ft 2in	2.92	N/A	PRPSD
Cabinet								
Lease			N/A N/A	N/A N/A	N/A N/A	N/A	N/A	N/A
Pad			N/A N/A	N/A N/A	N/A N/A	N/A	N/A	N/A
Cabinet			1ft 9in	3ft 4in	7ft 0in	5.83	N/A	PRPSD
Cabinet								
Lease			N/A N/A	N/A N/A	N/A N/A	N/A	N/A	N/A
Pad			N/A N/A	N/A N/A	N/A N/A	N/A	N/A	N/A
Cabinet			2ft 0in	2ft 5in	0ft 0in	4.83	N/A	PRPSD



Generator Requirements

No generators exist for this application

Battery Requirements

Type	Qty.	Mfg.	Model	Is Battery Backup Required?	Yes
INSTLLD	0	N/A	N/A		
PRPSD	1	Eaton	9170+		

Scope of Work/Additional Information**Scope of Work:**

COUNTY OF MONTEREY. Customer is proposing (1) new DBSPECTRA, (1) new Yagi and (2) new lines. County to add (2) racks and (1) UPS. Proposed antenna equipment at 110' and 160' carry all 5 bands listed under technology.

****Indicates where Cut Sheet data has been entered.**

NOTICE: Structural Analysis shall be performed in accordance with the current revision of the TIA/EIA 222 standard and applicable local building permit codes and standards. EME analysis shall be consistent with current revision of FCC/OSHA standard OETB 65. AM detuning, when required, will be performed to 47 CFR22.371. The customer is responsible for all analysis expenses. All construction drawings are subject to Crown Castle engineering approval prior to commencement of tower attachments and compound installations. Installation of equipment not conforming to approved drawings may violate the terms of the occupancy agreement and will be corrected at the customer's expense. Crown Castle requires drawings for pre-construction approval and as built drawings for physical configuration validation to be submitted as unlocked AutoCAD files (Version 2000i preferred).

Appendix A - Antenna, Feedline, TME Specifications**Antenna Specifications**

Quantity	Manufacturer	Model	Type	Height	Width	Depth	Weight	Flat Plate Area
2	ANDREW	PAR6-59W-PXA	MICROWAVE DISH	76.3 IN	76.3 IN	52.55 IN	161.0 LBS	0.0 FT2
2	SINCLAIR	SRL-210C-2	DIPOLE	120.0 IN	40.0 IN	3.0 IN	16.0 LBS	26.7 FT2
1	DBSPECTRA	DS1F06F36U-D	OMNI	262.8 IN	3.2	3.2 IN	60.0	0.0
1	KATHREIN	K531921	YAGI	25.6 IN	41.7 IN	3.0 IN	14.3 LBS	0.0

Feedline Specifications

Quantity	Manufacturer	Model	Nominal Size	Nominal O.D.
2	ANDREW	EW52	ELLIPTICAL	1.31 IN
2	ANDREW	LDF5-50A	7/8"	1.09 IN
1	ANDREW	LDF4-50A	1/2"	0.63 IN
2	RFS/CELWAVE	LCF78-50JA	7/8"	1.09 IN

Customer Site Name:
Customer Site ID:

Crown Site Name: Bryant Canyon
Crown Business Unit: 839198
License Number: 179772
Amendment Number: 380555

ATTACHMENT B

Site Plan

(See attached CAD-Generated Site Plan)

Prepared by: J.Ogbunugafor
Prepared on: January 30, 2014
Revised on:
Master Exhibit Version: 09/13/06

LRF Rev. #: 1
App Rev. #: 8

Template Version: 7/9/13

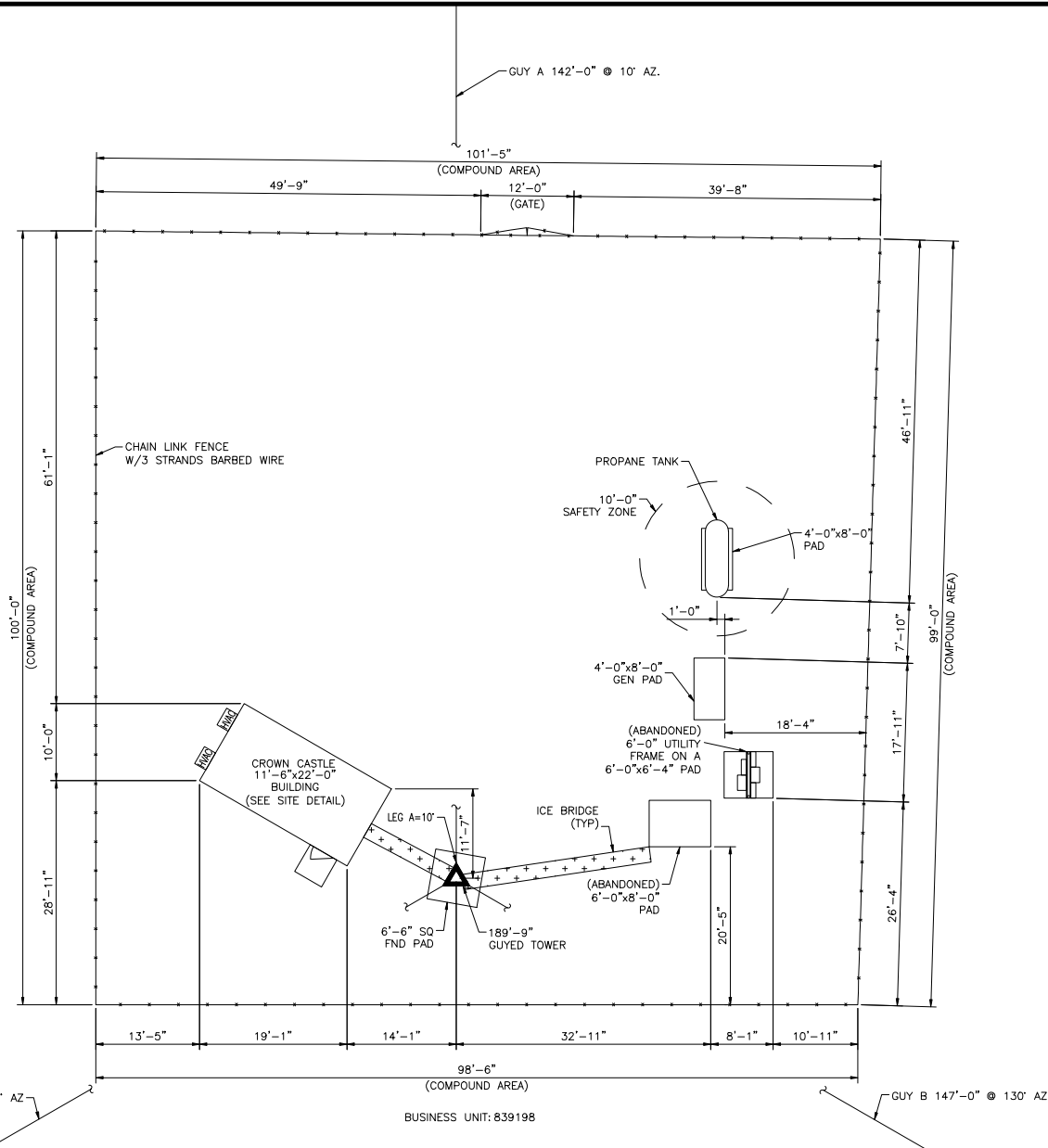

ENG-PUN-10050 REV C DATE: 7/13/06
 PLOT DATE: 1/10/2014 FILE NAME: 839198_SITEPLAN.DWG

SITE PLAN
 BUSINESS UNIT: 839198
 SCALE: 1"=15'-0"
 1

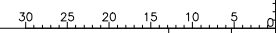

CARRIERS LOGO



CROWN REGION ADDRESS
 USA

SPACE RESERVED FOR PROFESSIONAL SEALS

NO.	DATE	DESCRIPTION	BY
1	12/09/07	REGIONAL CHG TO PER WORK ORDER # 164753	AM
2	18/02/08	REGIONAL CHG TO PER WORK ORDER # 203236	AT
3	02/04/08	REGIONAL CHG TO PER WORK ORDER # 203339	AT
4	17/11/09	APPLICATION ADDED PER WORK ORDER # 306112	AT
5	28/05/11	AS-BUILT INFORMATION ADDED PER WORK ORDER # 301059	VP
6	20/07/11	RECOMMENDED PER WORK ORDER # 426913	AM
7	11/10/11	RECOMMENDED PER WORK ORDER # 425923	AM
8	28/12/12	RECOMMENDED PER WORK ORDER # 262736	AM
9	04/10/13	UPDATED PER WORK ORDER # 468334	AM

DRAWN BY: AM
 CHECKED BY: SL
 DRAWING DATE: 12/09/07

SITE NUMBER:
 SITE NAME:
 BRYANT CANYON
 BUSINESS UNIT NUMBER:
 839198
 SITE ADDRESS:
 .5 MI. W OF BRYANT CANYON ROAD 3 MI N
 SOLEDAD, CA 95960
 MONTEREY COUNTY
 USA
 SHEET TITLE:
 SITE PLAN
 SHEET NUMBER:

A-2



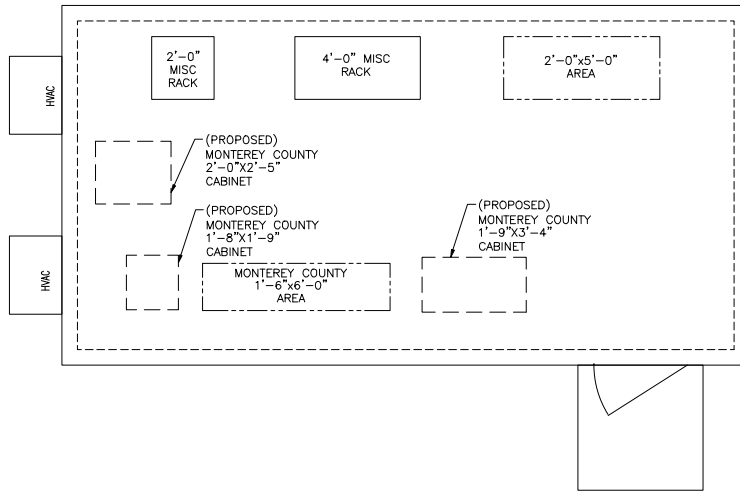

DETAIL

BUSINESS UNIT: 839198 TOWER ID: SITEDETAIL



SCALE: 1/4"=1'-0"

1

CARRIERS LOGO



CROWN REGION ADDRESS
USA

SPACE RESERVED FOR PROFESSIONAL SEALS

REVISIONS NO.	DATE	DESCRIPTION	BY
1	18/03/08	REGIONAL CHG TO PER WORK ORDER # 200336	AT
2	02/04/08	REGIONAL CHG TO PER WORK ORDER # 200339	AT
3	27/11/08	APPLICATION ADDED PER WORK ORDER # 306712	AT
4	28/02/11	AS-BUILT INFORMATION ADDED PER WORK ORDER # 406713	VP
5	20/02/11	REVISIONS PER WORK ORDER # 406713	AMM
6	11/07/11	RECOMMENDED PER WORK ORDER # 423033	AMM
7	28/12/12	RECOMMENDED PER WORK ORDER # 502756	LAN
8	30/01/14	UPDATED PER WORK ORDER # 706837	CAH
9	31/01/14	UPDATED PER WORK ORDER # 707198	CAH

DRAWN BY: ALM
CHECKED BY:
DRAWING DATE: 04/10/13

SITE NUMBER:
SITE NAME:

BRYANT CANYON
BUSINESS UNIT NUMBER

839198
SITE ADDRESS

5 MI. W OF BRYANT CANYON ROAD 3 MI N
SOLEDAD, CA 93960
MONTEREY COUNTY
USA

SHEET TITLE

SITE DETAIL

SHEET NUMBER

A2-3



ENG-PUN-10050 REV(C) DATE: 7/13/06

SITE DETAIL

PLOT DATE: 1/31/2014 FILE NAME: 839198_SITEDETAIL.DWG

Customer Site Name:
Customer Site ID:

Crown Site Name: Bryant Canyon
Crown Business Unit: 839198
License Number: 179772
Amendment Number: 380555

ATTACHMENT C

Level Drawing

(See attached CAD-generated Level Drawing)

Prepared by: J.Ogbunugafor
Prepared on: January 30, 2014
Revised on:
Master Exhibit Version: 09/13/06

LRF Rev. #: 1
App Rev. #: 8

Template Version: 7/9/13



B

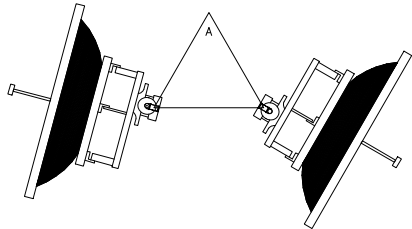

A

BUSINESS UNIT: 839198 TOWER ID: A LEVEL: 83

LEVEL DRAWING

ORIENT	CUSTOMER	ANTENNA						FEEDLINE		TME					
		Q	STATUS	MFG	MODEL	AZ	TECH	TX/RX	QTY	SIZE	QTY	TME	TYPE	MFG	MODEL
A	MID	MONTEREY COUNTY CA	83	INSTALLED	ANDREW	PAR6-59W-PXA	130	MW Link	TX/RX	1	EW52	0			
B	MID	MONTEREY COUNTY CA	83	INSTALLED	ANDREW	PAR6-59W-PXA	295	MW Link	TX/RX	1	EW52	0			
C															
D															
E															
F															
G															
H															
I															
J															
K															
L															
M															
N															
O															
P															
Q															
R															

OPERATING LEGAL ENTITY: COUNTY OF MONTEREY

CARRIERS LOGO



CROWN REGION ADDRESS
USA

SPACE RESERVED FOR PROFESSIONAL SEALS

NO.	DATE	DESCRIPTION	BY
1	10/1/2013	UPDATED FOR WORK ORDER 50832	MH

DRAWN/CHECKED BY: E2CAD
DRAWING DATE: 1/10/2013

SITE NUMBER:
SITE NAME:

BRYANT CANYON
BUSINESS UNIT NUMBER

839198
SITE ADDRESS

.5 MILES W OF BRYANT CANYON
ROAD 3 MILES NORTH OF METZER
ROAD
SOLEDAD, CA 93960
MONTEREY COUNTY
US

SHEET TITLE

83 FT INSTALLED LEVEL

SHEET NUMBER

A1-X





ORIENT		CUSTOMER				ANTENNA					FEEDLINE				TME			
Q																		
STATUS	MFG	MODEL	AZ	TECH	TX/RX	QTY	SIZE	QTY	TME	TYPE	MFG	MODEL						
110	PROPOSED	KATHREIN	K531921	230	Digital	TX	1	7/8	0									

OPERATING LEGAL ENTITY: COUNTY OF MONTEREY

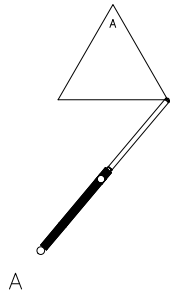

BUSINESS UNIT: 839198 TOWER ID: A LEVEL: 110

LEVEL DRAWING

CARRIERS LOGO



CROWN REGION ADDRESS
USA

SPACE RESERVED FOR PROFESSIONAL SEALS

REVISIONS	NO.	DATE	DESCRIPTION	BY
	1	4/10/2013	UPDATED PER WORK ORDER 658034	AA

DRAWN/CHECKED BY: EZCAD
DRAWING DATE: 10/4/2013

SITE NUMBER:

SITE NAME:

BRYANT CANYON

BUSINESS UNIT NUMBER:

839198

SITE ADDRESS:

.5 MILES W OF BRYANT CANYON
ROAD 3 MILES NORTH OF METZER
ROAD
SOLEDAD, CA 93960
MONTEREY COUNTY
US

SHEET TITLE:

110 FT PROPOSED LEVEL

SHEET NUMBER:

A1-X



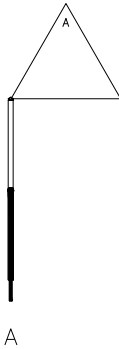

BUSINESS UNIT: 839198 TOWER ID: A LEVEL: 147

ORIENT	CUSTOMER	ANTENNA						FEEDLINE		TME					
		Q	STATUS	MFG	MODEL	AZ	TECH	TX/RX	QTY	SIZE	QTY	TME	TYPE	MFG	MODEL
A	UP MONTEREY COUNTY CA	151	INSTALLED	SINCLAIR	SRL-210C-2	190	Digital	TX/RX	1	7/8"	0				
B															
C															
D															
E															
F															
G															
H															
I															
J															
K															
L															
M															
N															
O															
P															
Q															
R															

OPERATING LEGAL ENTITY: **COUNTY OF MONTEREY**

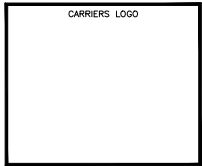

CROWN REGION ADDRESS
USA

SPACE RESERVED FOR PROFESSIONAL SEALS

NO.	DATE	DESCRIPTION	BY
1	10/1/2013	UPDATED PER WORK ORDER 59832	MM

DRAWN/CHECKED BY: E2CAD
DRAWING DATE: 1/10/2013

SITE NUMBER:
SITE NAME:
[SITE NAME]

BRYANT CANYON
[BUSINESS UNIT NUMBER]

839198
[SITE ADDRESS]

.5 MILES W OF BRYANT CANYON
ROAD 3 MILES NORTH OF METZER
ROAD
SOLEDAD, CA 93960
MONTEREY COUNTY
US

[SHEET TITLE]

147 FT INSTALLED LEVEL

[SHEET NUMBER]

LEVEL DRAWING

A1-X



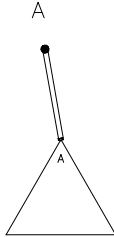

BUSINESS UNIT: 839198 TOWER ID: A LEVEL: 160

LEVEL DRAWING

ORIENT		CUSTOMER		ANTENNA				FEEDLINE			TME			
Q	STATUS	MFG	MODEL	AZ	TECH	TX/RX	QTY	SIZE	QTY	TME	TYPE	MFG	MODEL	
UP		MONTEREY COUNTY, CA	160	PROPOSED	DBSPECTRA	DS1F06F36U-D	0	Digital	RX	1	7/8	0		

OPERATING LEGAL ENTITY: COUNTY OF MONTEREY

CARRIERS LOGO



CROWN REGION ADDRESS

USA

SPACE RESERVED FOR PROFESSIONAL SEALS

REVISIONS	NO.	DATE	DESCRIPTION	BY
	1	4/10/2013	UPDATED PER WORK ORDER 68024	ALJ

DRAWN/CHECKED BY: EZCAD
DRAWING DATE: 10/4/2013

SITE NUMBER:

SITE NAME:

SITE NAME

BRYANT CANYON

BUSINESS UNIT NUMBER

839198

SITE ADDRESS

.5 MILES W OF BRYANT CANYON

ROAD 3 MILES NORTH OF METZER

ROAD

SOLEDAD, CA 93960

MONTEREY COUNTY

US

SHEET TITLE

160 FT PROPOSED LEVEL

SHEET NUMBER

A1-X



ENG-PUN-10050 REV(-) DATE: 7/13/06 APP ID: T68049 REV:

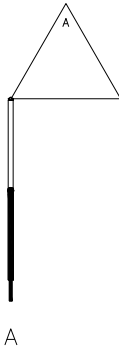

BUSINESS UNIT: 839198 TOWER ID: A LEVEL: 170

LEVEL DRAWING

ORIENT	CUSTOMER	ANTENNA							FEEDLINE		TME				
		Q	STATUS	MFG	MODEL	AZ	TECH	TX/RX	QTY	SIZE	QTY	TME	TYPE	MFG	MODEL
A	UP MONTEREY COUNTY CA MONTEREY COUNTY CA	174	INSTALLED INSTALLED	SINCLAIR	SRL-210C-2	190	Digital	TX/RX	1	7/8"	0				
B															
C															
D															
E															
F															
G															
H															
I															
J															
K															
L															
M															
N															
O															
P															
Q															
R															

OPERATING LEGAL ENTITY: COUNTY OF MONTEREY

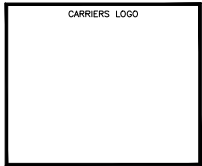

CROWN REGION ADDRESS
USA

SPACE RESERVED FOR PROFESSIONAL SEALS

NO.	DATE	DESCRIPTION	BY
1	10/1/2013	UPDATED PER WORK ORDER 598832	MMH

DRAWN/CHECKED BY: E2CAD
DRAWING DATE: 1/10/2013

SITE NUMBER:
SITE NAME:
[SITE NAME]

BRYANT CANYON
[BUSINESS UNIT NUMBER]

839198
[SITE ADDRESS]

.5 MILES W OF BRYANT CANYON
ROAD 3 MILES NORTH OF METZER
ROAD
SOLEDAD, CA 93960
MONTEREY COUNTY
US

[SHEET TITLE]

170 FT INSTALLED LEVEL

[SHEET NUMBER]

A1-X

