

SHEET NUMBER	TOTAL SHEETS
1	10

COUNTY OF MONTEREY
 STATE OF CALIFORNIA
 DEPARTMENT OF PUBLIC WORKS
**PROJECT PLANS FOR CONSTRUCTION OF
 DRAINAGE AND ROAD IMPROVEMENTS
 ON UNION STREET AND ALLEY 1CV51 IN CASTROVILLE**
 PROJECT NO. 13-142465

TO BE SUPPLEMENTED BY CALTRANS STANDARD SPECIFICATIONS AND STANDARD PLANS 2010 EDITION

INDEX OF SHEETS

1	TITLE SHEET
2	TYPICAL CROSS SECTIONS
3-5	CONSTRUCTION DETAILS
6	PLAN AND PROFILE - ALLEY
7	PLAN AND PROFILE - UNION STREET SIDEWALK
8	DRAINAGE PLAN AND PROFILE
9	CONSTRUCTION AREA SIGNS
10	SUMMARY OF QUANTITIES

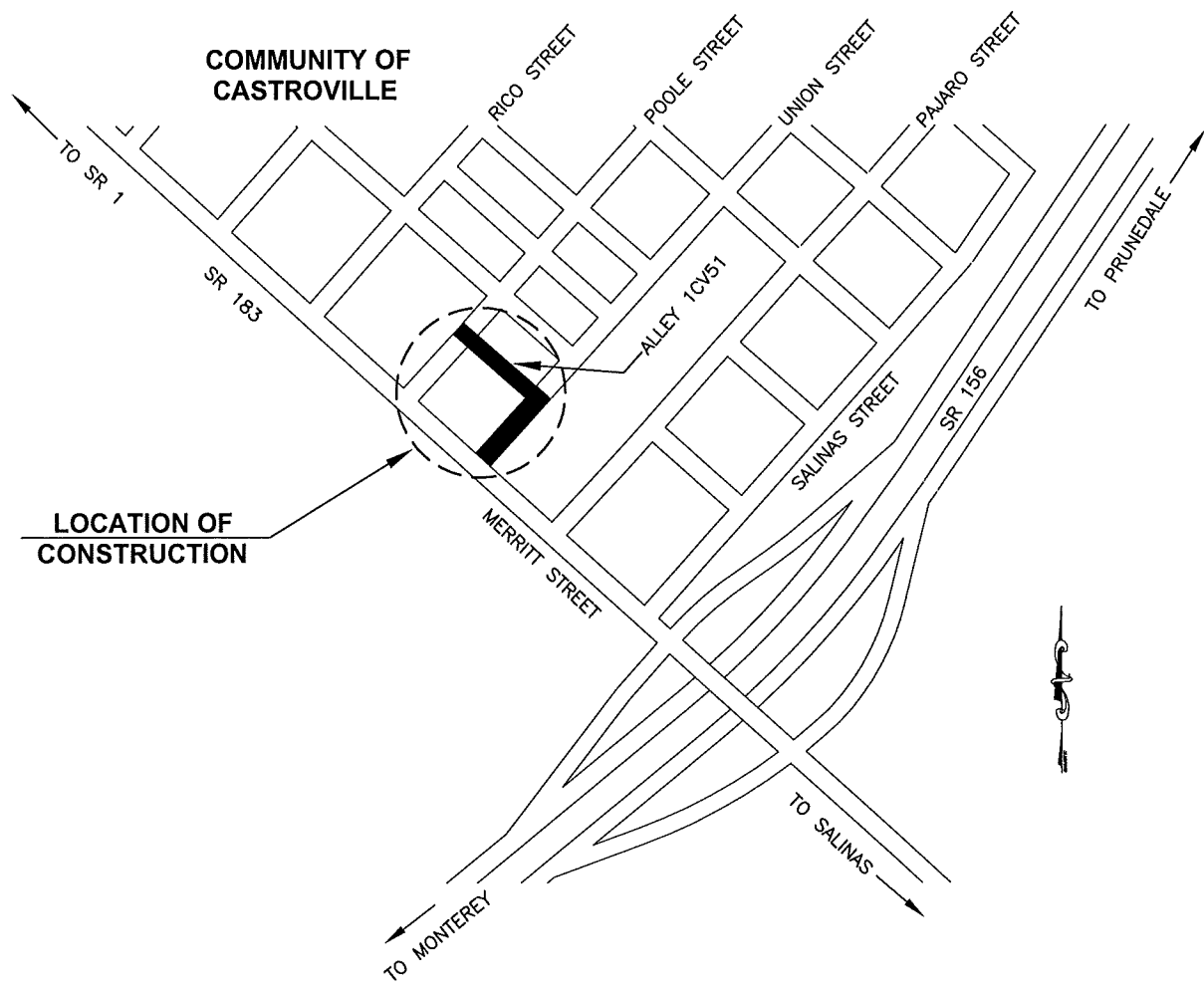
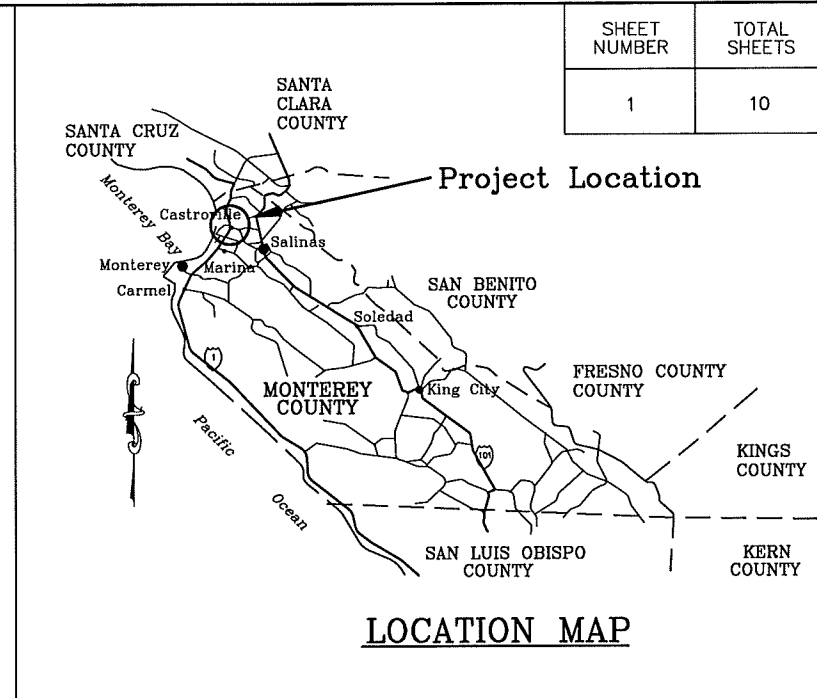

THE CONTRACTOR SHALL POSSESS THE CLASS (OR CLASSES) OF LICENSE AS SPECIFIED IN THE "NOTICE TO BIDDERS."

HORIZONTAL ASSUMED NORTH/COORDINATES USING BM#29 MONTEREY COUNTY BRASS DISK STAMPED "CASTRO BM29 1968", ELEV 17.42 TC RETURN SW CORNER ON MCDUGALL ST AT POOLE ST BEARING LINE BETWEEN #1 AND #2 IS DUE NORTH NGVD 1929 VERTICAL DATUM

BY ACTION OF THE BOARD OF SUPERVISORS
 APPROVED ON _____
 PER BOARD ORDER No. _____ PUBLIC WORKS

ROBERT K. MURDOCH, P.E. _____ DATE
 DIRECTOR OF PUBLIC WORKS

SUBMITTED BY, JONATHAN L. PASCUA, P.E.	
DESIGN BY, BARNEY GUZMAN	CHKD BY, J.P.
DRAWN BY FELIPE MORALES / I, DELA MERCED	CHKD BY B.G./J.P.
SPECIFICATIONS WRITTEN BY ISABELO DELA MERCED	CHKD BY B.G./J.P.
APPROVAL RECOMMENDED BY, PAUL, H., GREENWAY, P.E. ASSISTANT DIRECTOR OF PUBLIC WORKS	



NO.	DATE	REVISION	APPROVED
▲			
▲			
▲			
▲			
▲			



COUNTY OF MONTEREY
 RESOURCE MANAGEMENT AGENCY
 DEPARTMENT OF PUBLIC WORKS
 DESIGN SECTION
 168 WEST ALISAL STREET, 2nd FLOOR
 SALINAS, CALIFORNIA 93901
 (831)755-4800/FAX (831)755-4958

DRAINAGE AND ROAD IMPROVEMENTS ON UNION STREET AND ALLEY 1CV51 IN CASTROVILLE PROJECT NO. 13-142465		
TITLE SHEET		
DATE 02/15/2013	RELATIVE BORDER SCALE: IN INCHES 1 2 3	SHEET TS-1
SCALE NONE	VIEW TS-1	

SHEET NUMBER	TOTAL SHEETS
2	10

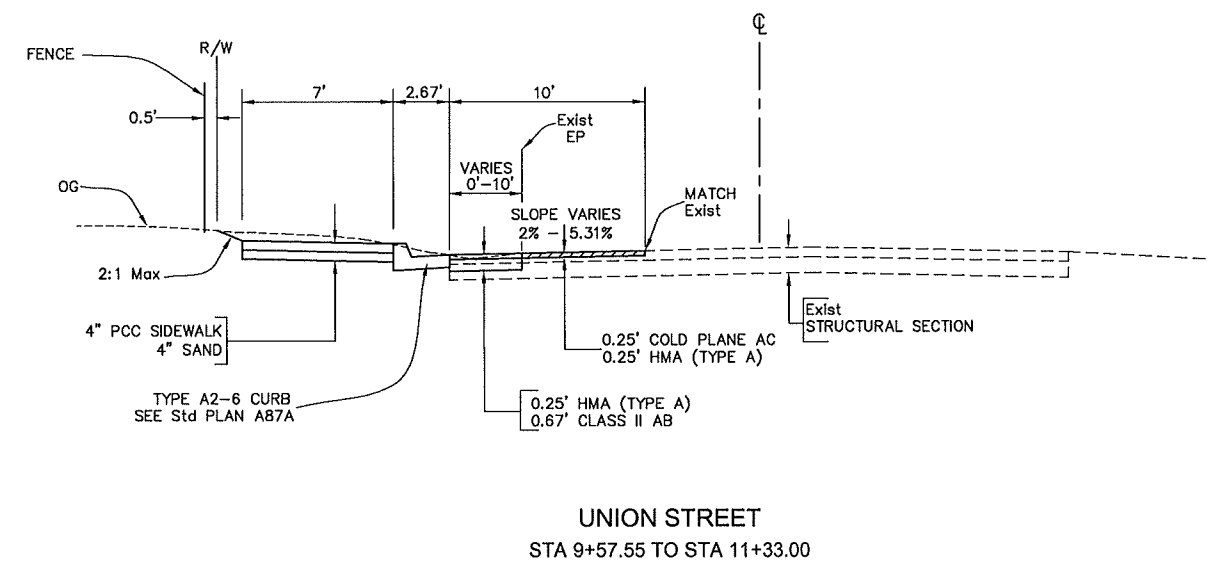
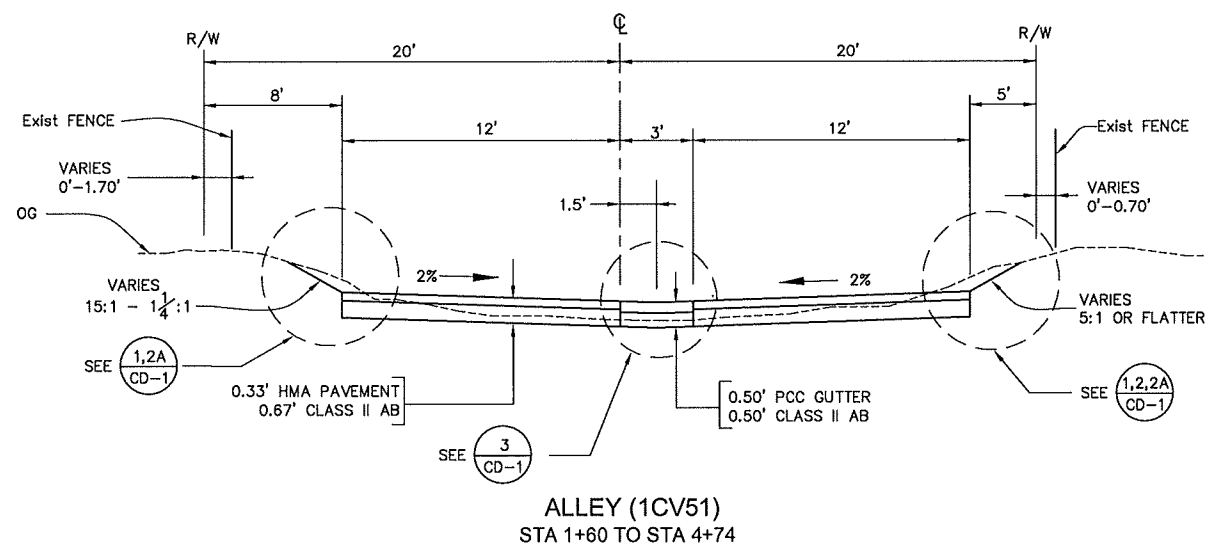

SUBMITTED BY, JONATHAN L. PASCUA, P.E.

DESIGN BY, ISABELO DELA MERCED\B.GUZMAN CHKD BY, J.P.

DRAWN BY, ISABELO DELA MERCED CHKD BY, J.P.

SPECIFICATIONS WRITTEN BY, ISABELO DELA MERCED CHKD BY, J.P.

APPROVAL RECOMMENDED BY, PAUL, H., GREENWAY, P.E. ASSISTANT DIRECTOR OF PUBLIC WORKS

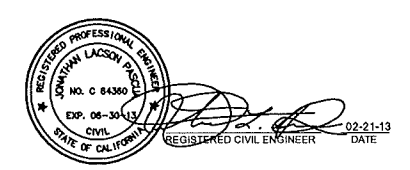

NO.	DATE	REVISION	APPROVED



COUNTY OF MONTEREY
RESOURCE MANAGEMENT AGENCY
DEPARTMENT OF PUBLIC WORKS

DESIGN SECTION

168 WEST ALISAL STREET, 2nd FLOOR
SALINAS, CALIFORNIA 93901
(831)755-4800/FAX (831)755-4958

DRAINAGE AND ROAD IMPROVEMENTS
ON UNION STREET AND ALLEY 1CV51 IN CASTROVILLE
PROJECT NO. 13-142465

TYPICAL CROSS SECTIONS

DATE 01/17/13	RELATIVE BORDER SCALE: IN INCHES 	SHEET X-1
SCALE NTS	VIEW X-1	

SHEET NUMBER	TOTAL SHEETS
3	10

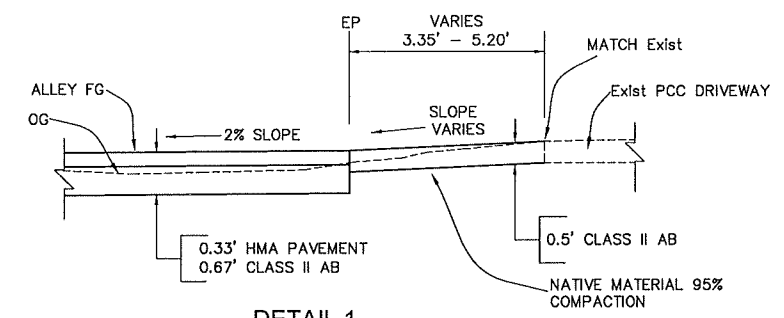

DETAIL 1
TYPICAL ALLEY CONFORM TO Exist DRIVEWAY

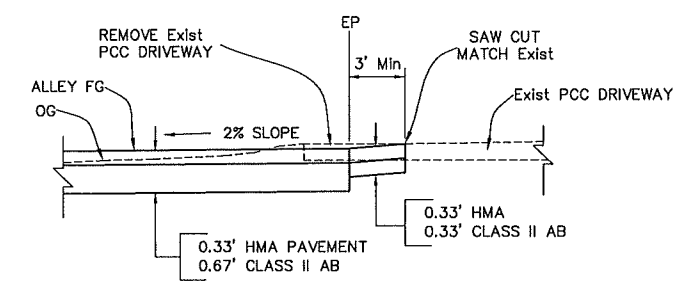

DETAIL 2
ALLEY CONFORM TO Exist DRIVEWAY

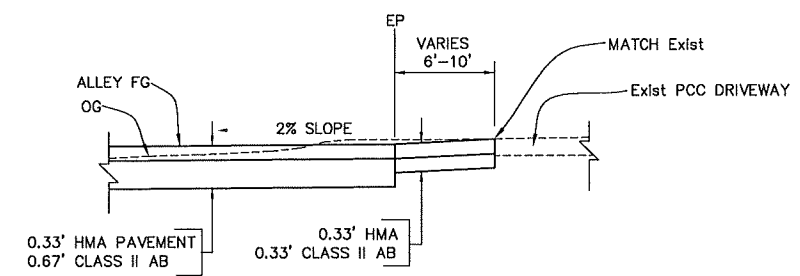

DETAIL 2A
TYPICAL ALLEY CONFORM TO Exist DRIVEWAY

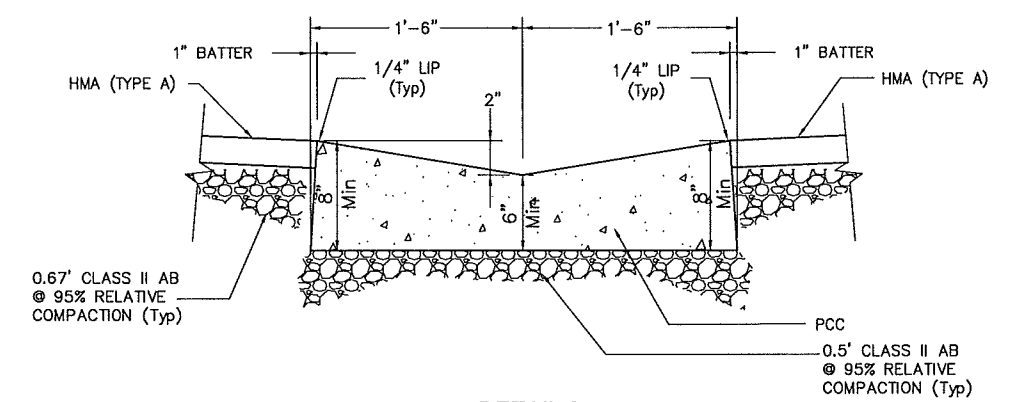

DETAIL 3
VEE GUTTER

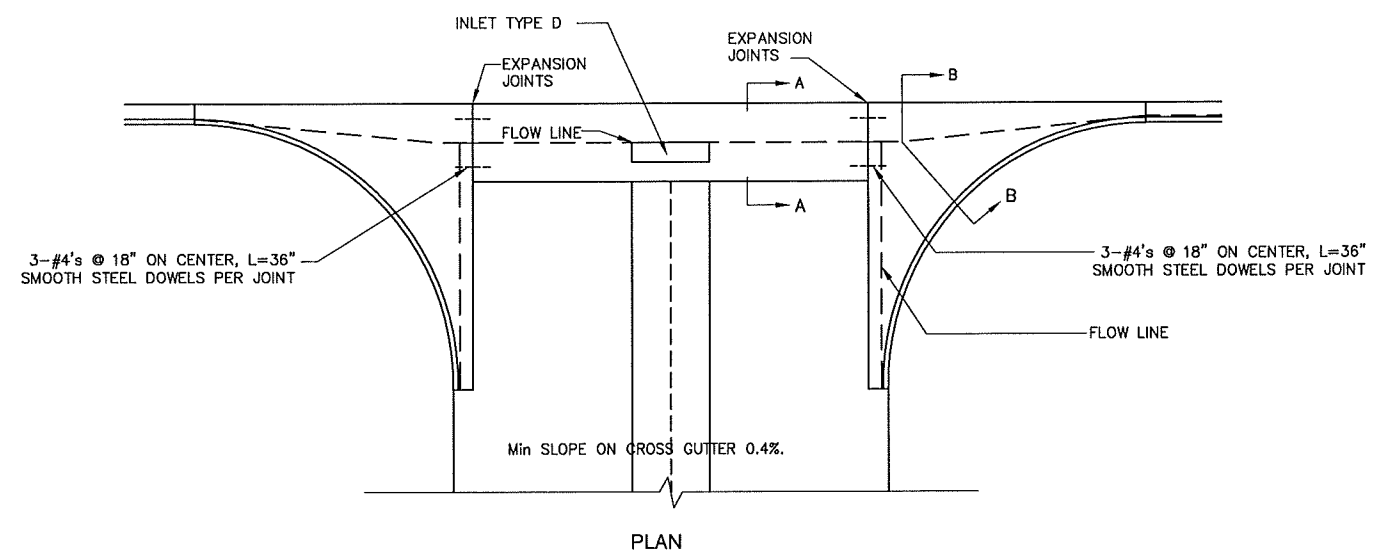

PLAN

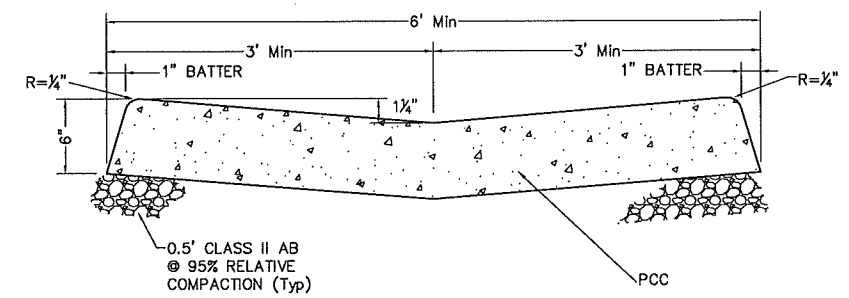

SECTION A-A

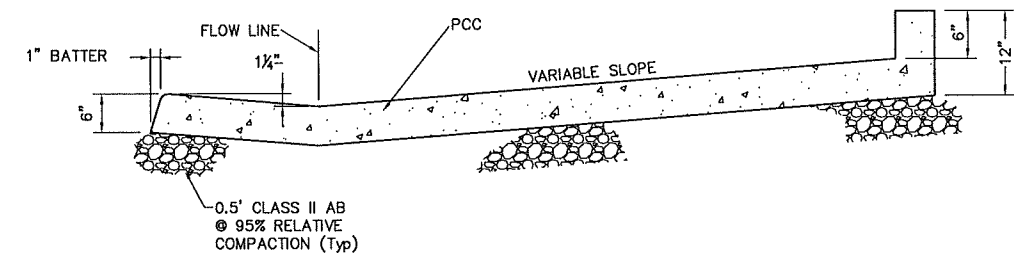

SECTION B-B

DETAIL 4
CROSS GUTTER

SUBMITTED BY, JONATHAN L. PASCUA, P.E.	
DESIGN BY, ISABELO DELA MERCED/B.GUZMAN	CHKD BY, J.P.
DRAWN BY, ISABELO DELA MERCED/J. GUIÇO	CHKD BY, J.P.
SPECIFICATIONS WRITTEN BY, ISABELO DELA MERCED	CHKD BY, J.P.
APPROVAL RECOMMENDED BY, PAUL H. GREENWAY, P.E. ASSISTANT DIRECTOR OF PUBLIC WORKS	

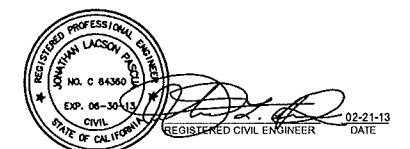

NO.	DATE	REVISION	APPROVED
▲			
▲			
▲			
▲			
▲			



COUNTY OF MONTEREY
RESOURCE MANAGEMENT AGENCY
DEPARTMENT OF PUBLIC WORKS
DESIGN SECTION
168 WEST AUSA STREET, 2nd FLOOR
SALINAS, CALIFORNIA 93901
(831)755-4800/FAX (831)755-4958

DRAINAGE AND ROAD IMPROVEMENTS ON UNION STREET AND ALLEY 1CV51 IN CASTROVILLE PROJECT NO. 13-142465		
CONSTRUCTION DETAILS		
DATE 01/17/13	RELATIVE BORDER SCALE: IN INCHES 0 1 2 3	SHEET CD-1
SCALE NTS	VIEW CD-1	

SHEET NUMBER	TOTAL SHEETS
4	10

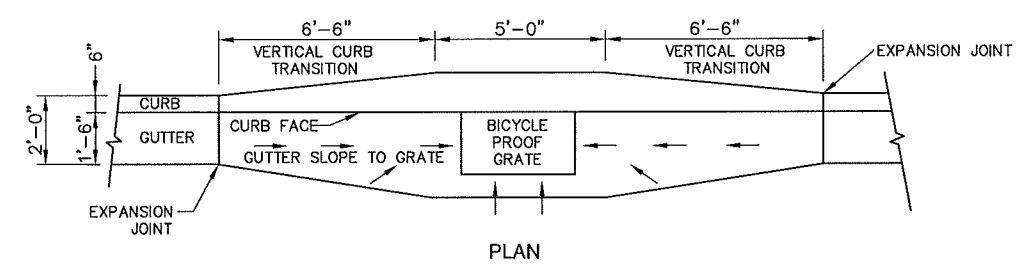

PLAN

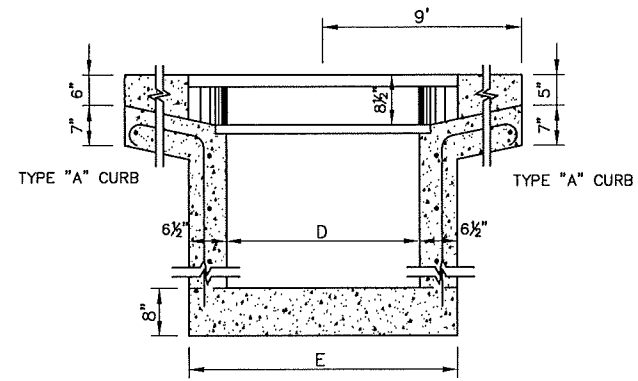

SECTION C-C

SECTION D-D

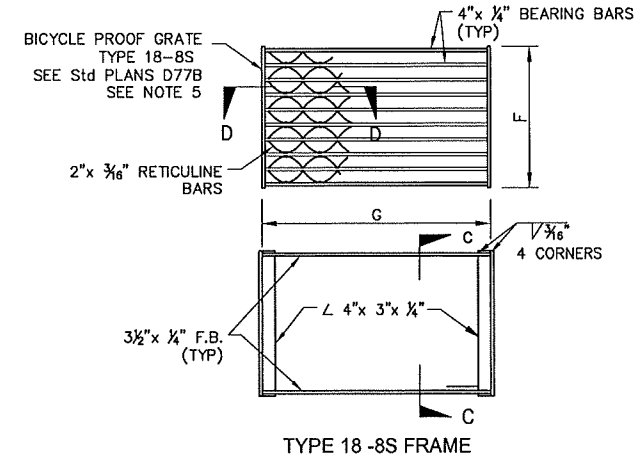
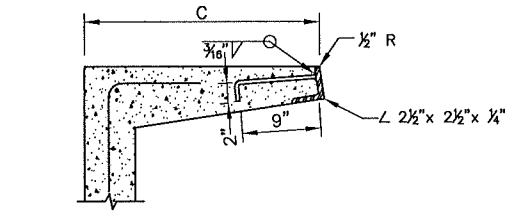
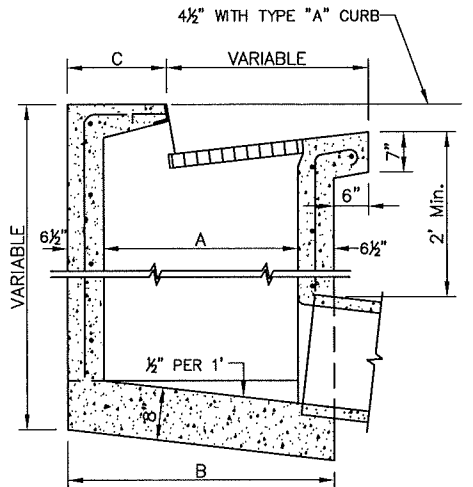

TYPE 18-8S FRAME

GENERAL NOTES:

- CATCH BASIN HOOD, FRAME & GRATE SHALL BE CAST MODULAR IRON FREE FROM DEFECTS (GALVANIZED STEEL FABRICATION.
- DIMENSIONS IN TABLE REFER TO METALFAB FRAME & GRATE. AN APPROVED EQUAL WILL BE
- MAXIMUM DEPTH FOR TYPE I IS 4'.
- MAXIMUM CURB OPENING HEIGHT SHALL NOT EXCEED 6" OR A GALVANIZED 3/4" ROUND PROTE SHALL BE PLACED HORIZONTALLY ACCROSS OPENINGS.
- FOR TYPE I USE MODIFIED TYPE 18-8S WHERE DIMENSION G IS 29".

	A	B	C	D	E	F	G
TYPE I	24"	37"	14"	24"	37"	18"	29"
TYPE II	24"	37"	14"	36"	49"	18"	40"
TYPE III	36"	49"	20"	36"	49"	24"	40"

REINFORCING STEEL:
WHEN DEPTH IS,
0-4' USE #3 BARS @ 18" o.c.
4'-12' USE #4 BARS @ 18" o.c.
12' OR MORE REQUIRES SPECIAL DESIGN

DETAIL 5
CATCH BASIN

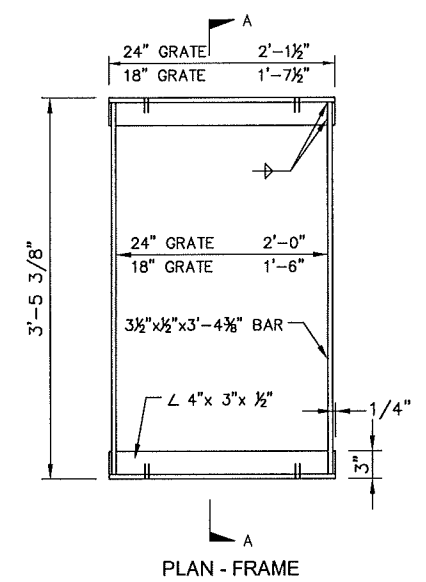

PLAN - FRAME

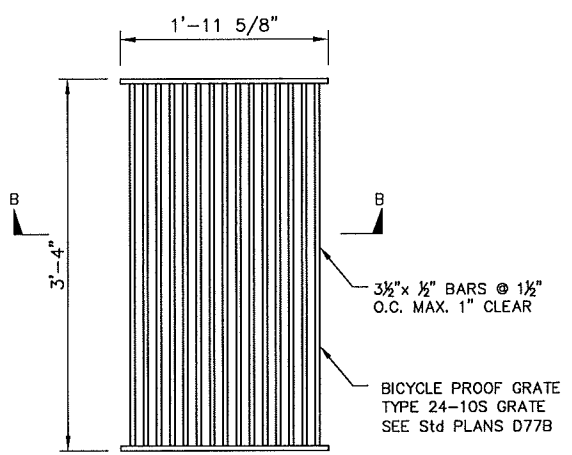

PLAN
24" WELDED GRATE

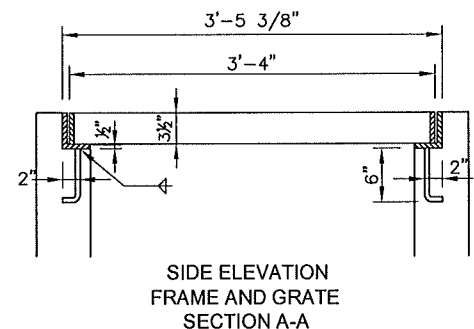

SIDE ELEVATION
FRAME AND GRATE
SECTION A-A

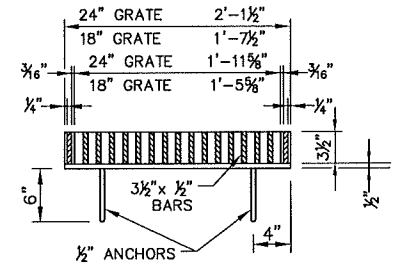

SECTION OF
FRAME AND GRATE
SECTION B-B

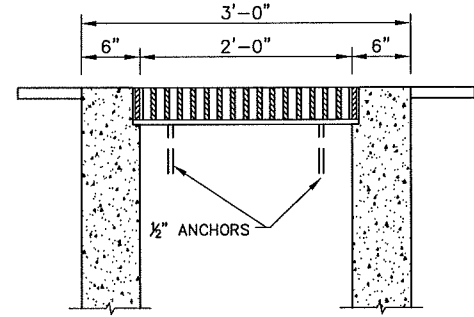

SECTION BOX
FRAME AND GRATE

DETAIL 6
TYPE D CATCH BASIN

SUBMITTED BY JONATHAN L. PASCUA, P.E.
DESIGN BY ISABELO DELA MERCED/B.GUZMAN
DRAWN BY ISABELO DELA MERCED/J. GUICO
SPECIFICATIONS WRITTEN BY ISABELO DELA MERCED
APPROVAL RECOMMENDED BY PAUL H. GREENWAY, P.E.
ASSISTANT DIRECTOR OF PUBLIC WORKS

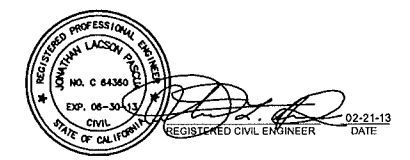

NO.	DATE	REVISION	APPROVED
▲			
▲			
▲			
▲			



COUNTY OF MONTEREY
RESOURCE MANAGEMENT AGENCY
DEPARTMENT OF PUBLIC WORKS
DESIGN SECTION
168 WEST ALISAL STREET, 2nd FLOOR
SALINAS, CALIFORNIA 93901
(831)755-4800/FAX (831)755-4958

DRAINAGE AND ROAD IMPROVEMENTS
ON UNION STREET AND ALLEY 1CV51 IN CASTROVILLE
PROJECT NO. 13-142465

CONSTRUCTION DETAILS

DATE 01/17/13	RELATIVE BORDER SCALE: IN INCHES 0 1 2 3	SHEET CD-2
SCALE NTS	VIEW CD-2	

SHEET NUMBER	TOTAL SHEETS
5	10

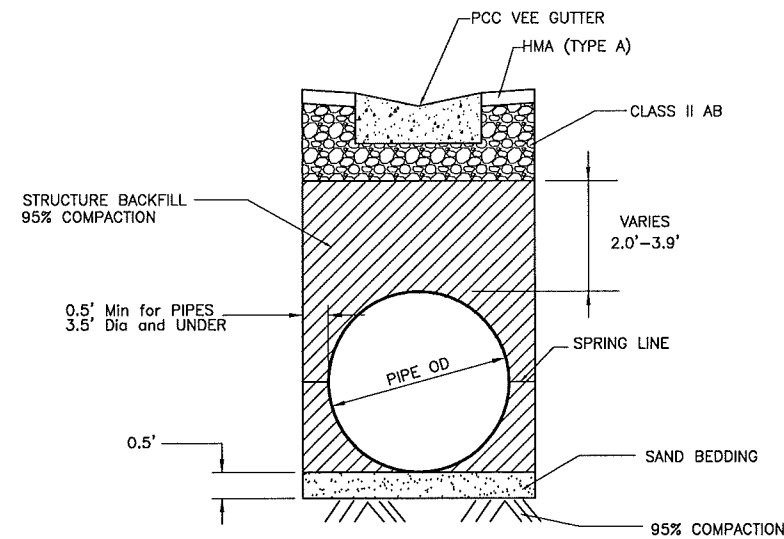

DETAIL 7
TYPICAL ALLEY TRENCH SECTION

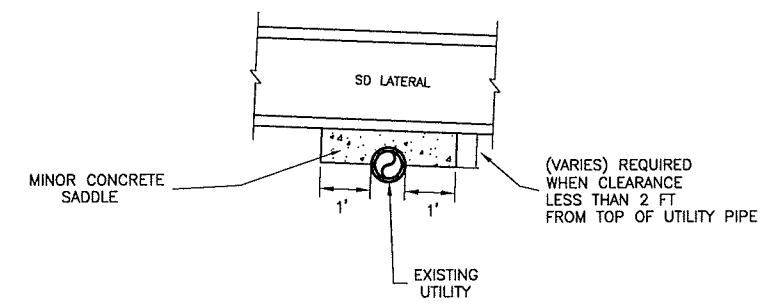

DETAIL 10
UTILITY CONFLICT DETAIL

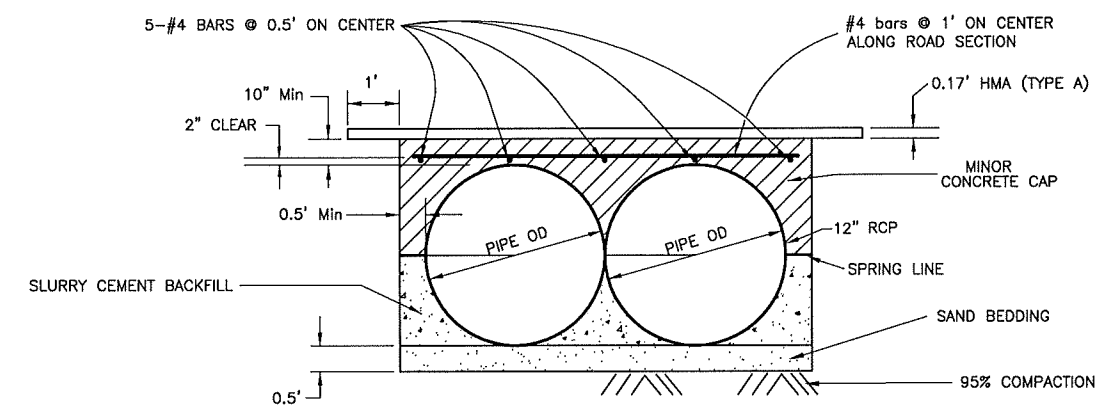

DETAIL 8
POOLE STREET TRENCH SECTION

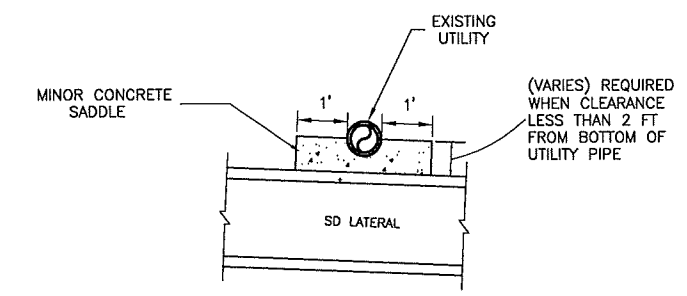

DETAIL 11
UTILITY CONFLICT DETAIL

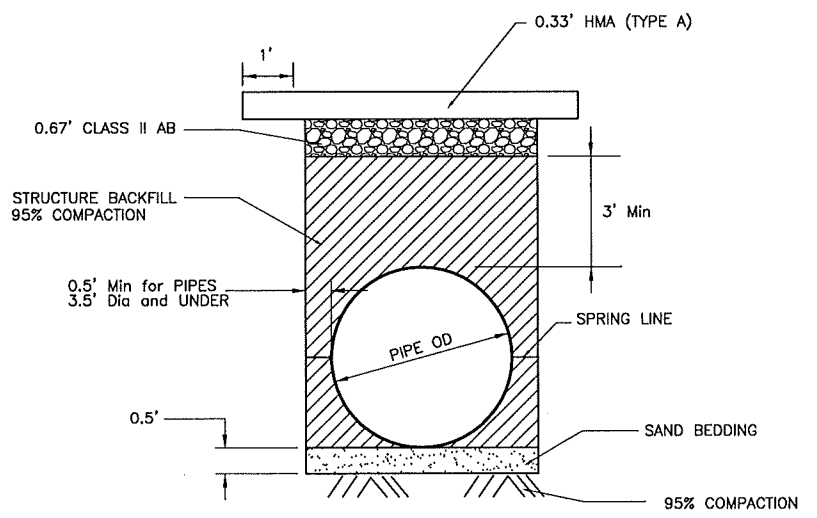

DETAIL 9
UNION STREET TRENCH SECTION

SUBMITTED BY: JONATHAN L. PASCUA, P.E.
 DESIGN BY: ISABELO DELA MERCED/B.GUZMAN
 DRAWN BY: ISABELO DELA MERCED/J. GUIÇO
 SPECIFICATIONS WRITTEN BY: ISABELO DELA MERCED
 APPROVAL RECOMMENDED BY: PAUL, H., GREENWAY, P.E.
 ASSISTANT DIRECTOR OF PUBLIC WORKS

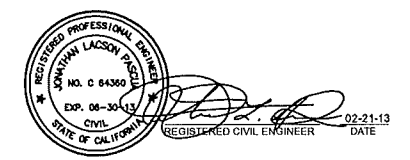

NO.	DATE	REVISION	APPROVED
△			
△			
△			
△			
△			



COUNTY OF MONTEREY
 RESOURCE MANAGEMENT AGENCY
 DEPARTMENT OF PUBLIC WORKS
 DESIGN SECTION
 168 WEST ALISAL STREET, 2nd FLOOR
 SALINAS, CALIFORNIA 93901
 (831)755-4800/FAX (831)755-4958

DRAINAGE AND ROAD IMPROVEMENTS
 ON UNION STREET AND ALLEY 1CV51 IN CASTROVILLE
 PROJECT NO. 13-142465

CONSTRUCTION DETAILS

DATE 02/20/13	RELATIVE BORDER SCALE: IN INCHES 0 1 2 3	SHEET CD-3
SCALE NTS	VIEW CD-3	

SHEET NUMBER	TOTAL SHEETS
6	10

K:\Design\Projects\1424-Castroville Drainage & Rd Improv\CAD\Union-Poole_base.dwg 2/22/2013 12:56:59 PM, moralesf, \\000sprint002new\300-M450C

LEGEND

- HMA TRANSITIONAL AREA (COLD PLANE)
- HMA TRANSITIONAL AREA (WITH BASE)
- PIPE

NOTE:
FOR DRAINAGE WORK
SEE SHEET PP-3

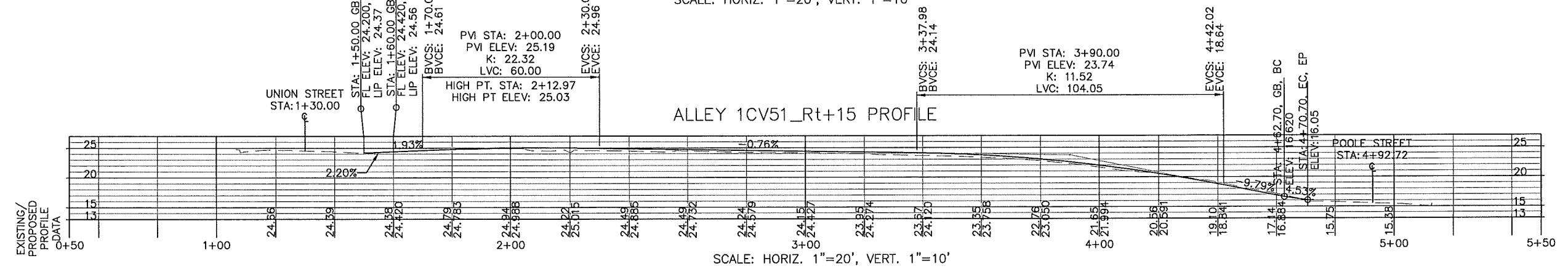
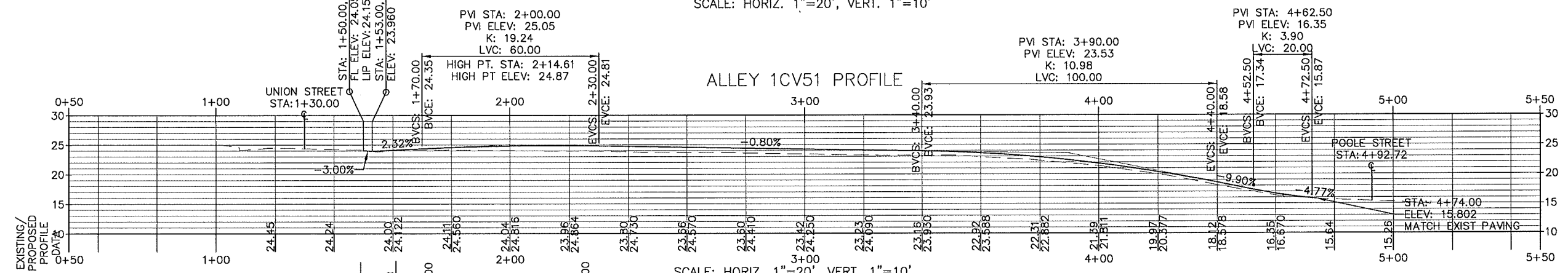
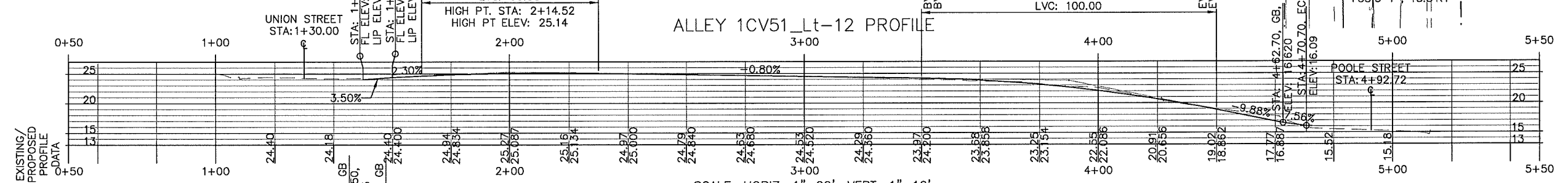
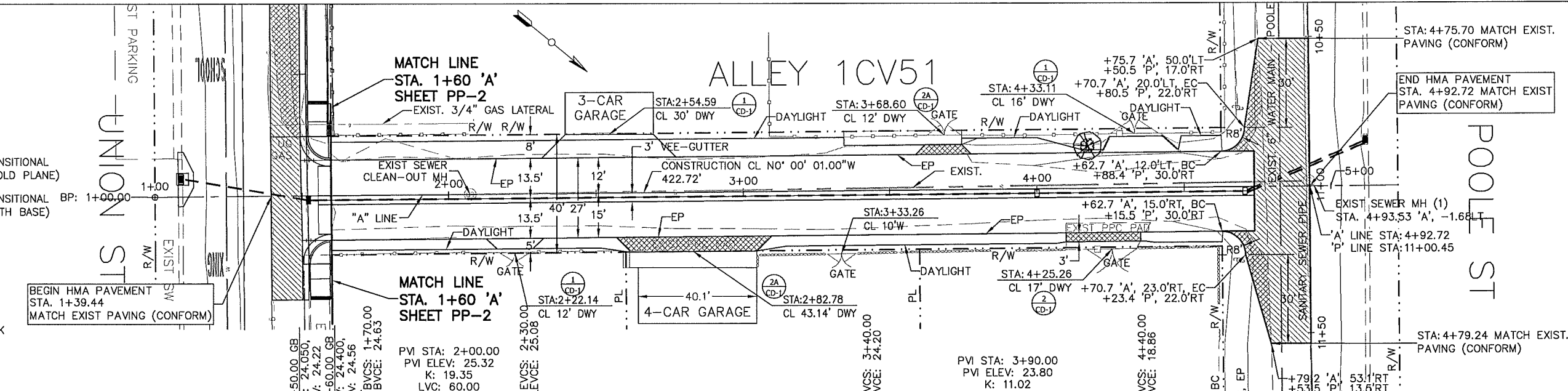

SUBMITTED BY: JONATHAN L. PASCUA, P.E.	
DESIGN BY: BARNEY GUZMAN	CHKD BY: J.P.
DRAWN BY: FELIPE MORALES	CHKD BY: B.G./J.P.
SPECIFICATIONS WRITTEN BY: ISABELO DELA MERCED	CHKD BY: B.G./J.P.
APPROVAL RECOMMENDED BY: PAUL H. GREENWAY, P.E. ASSISTANT DIRECTOR OF PUBLIC WORKS	

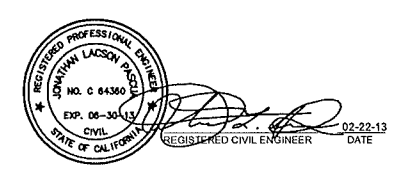

NO.	DATE	REVISION	APPROVED



COUNTY OF MONTEREY
RESOURCE MANAGEMENT AGENCY
DEPARTMENT OF PUBLIC WORKS

DESIGN SECTION
 168 WEST ALISAL STREET, 2nd FLOOR
 SALINAS, CALIFORNIA 93901
 (831)755-4800/FAX (831)755-4958



DRAINAGE AND ROAD IMPROVEMENTS
 ON UNION STREET AND ALLEY 1CV51 IN CASTROVILLE
 PROJECT NO. 13-142465

PLAN & PROFILE - ALLEY

DATE 02/11/2013	RELATIVE BORDER SCALE: IN INCHES 	SHEET PP-1
SCALE 1:20(H), 1:10(V)	VIEW ALLEY P&P	

SHEET NUMBER	TOTAL SHEETS
7	10

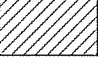
LEGEND

-  HMA TRANSITIONAL AREA (COLD PLANE)
-  HMA TRANSITIONAL AREA (WITH BASE)

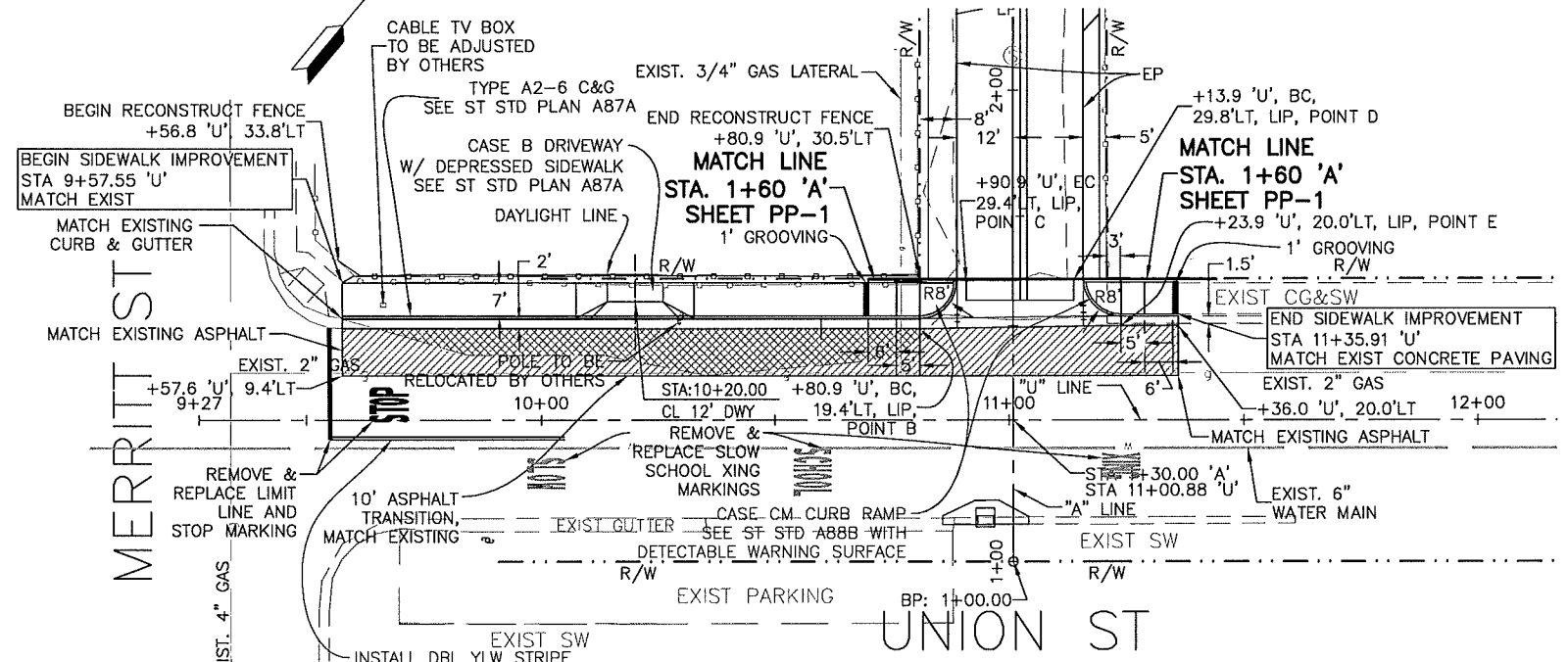

PLAN VIEW
SCALE: 1" = 20'

Point #	Description	Elevation	Northing	Easting	General Location
1	1" Iron Pipe	-	5000.0000	5000.0000	Union St/McDougall St Intersection
2	Backside CHKPT2	-	5266.5159	5000.0000	McDougall St (~96' SO Poole St)
100	BenchMark 9	17.430	5331.1554	4974.8678	McDougall St (~32' SO Poole St)

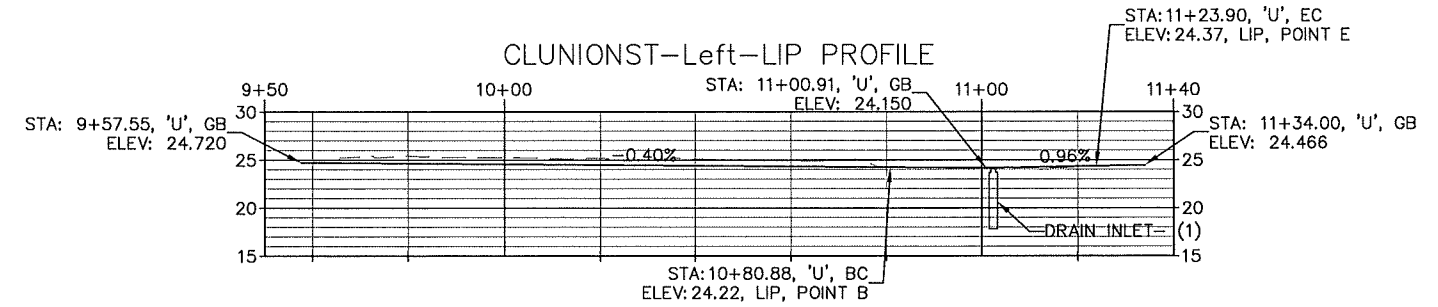

UNION STREET LEFT GUTTER LIP PROFILE
SCALE: HORIZONTAL 1" = 20'/VERTICAL: 1" = 10'

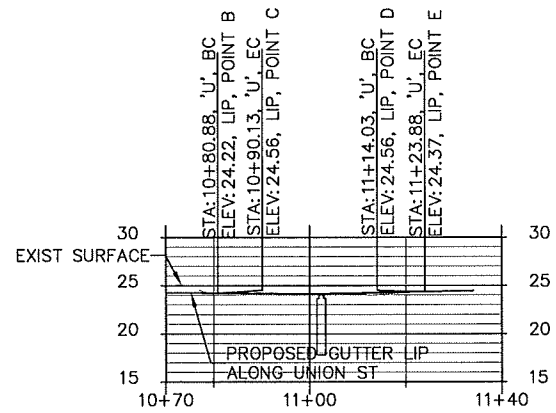

CURB RETURN (AT GUTTER LIP) PROFILE
SCALE: HORIZONTAL 1" = 20'/VERTICAL: 1" = 10'

K:\Design\Projects\1424-Castroville Drainage & Rd Improv\CAD\Union-Poole_base.dwg 2/22/2013 12:57:54 PM, moralesf, \\0000print002new\300-M450C

SUBMITTED BY, JONATHAN L. PASCUA, P.E.	
DESIGN BY, BARNEY GUZMAN	CHKD BY, J.P.P.
DRAWN BY, FELIPE MORALES	CHKD BY, B.G./J.P.P.
SPECIFICATIONS WRITTEN BY, ISABELA DELA MERCED	CHKD BY, B.G./J.P.P.
APPROVAL RECOMMENDED BY, PAUL H. GREENWAY, P.E. ASSISTANT DIRECTOR OF PUBLIC WORKS	

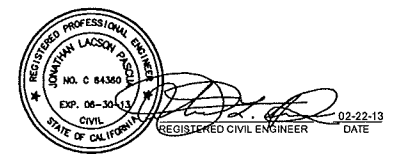

NO.	DATE	REVISION	APPROVED



COUNTY OF MONTEREY
RESOURCE MANAGEMENT AGENCY
DEPARTMENT OF PUBLIC WORKS
DESIGN SECTION
168 WEST ALISAL STREET, 2nd FLOOR
SALINAS, CALIFORNIA 93901
(831)755-4800/FAX (831)755-4958

DRAINAGE AND ROAD IMPROVEMENTS ON UNION STREET AND ALLEY 1CV51 IN CASTROVILLE PROJECT NO. 13-142465		
PLAN & PROFILE - UNION STREET SIDEWALK		
DATE 02/11/2013	RELATIVE BORDER SCALE: IN INCHES 0 1 2 3	SHEET PP-2
SCALE AS SHOWN	VIEW UNION P&P	

SHEET NUMBER	TOTAL SHEETS
8	10

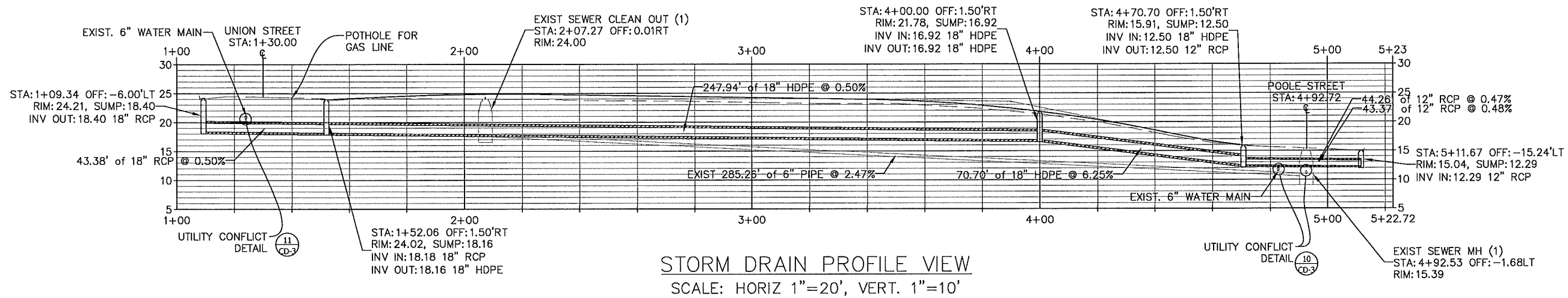
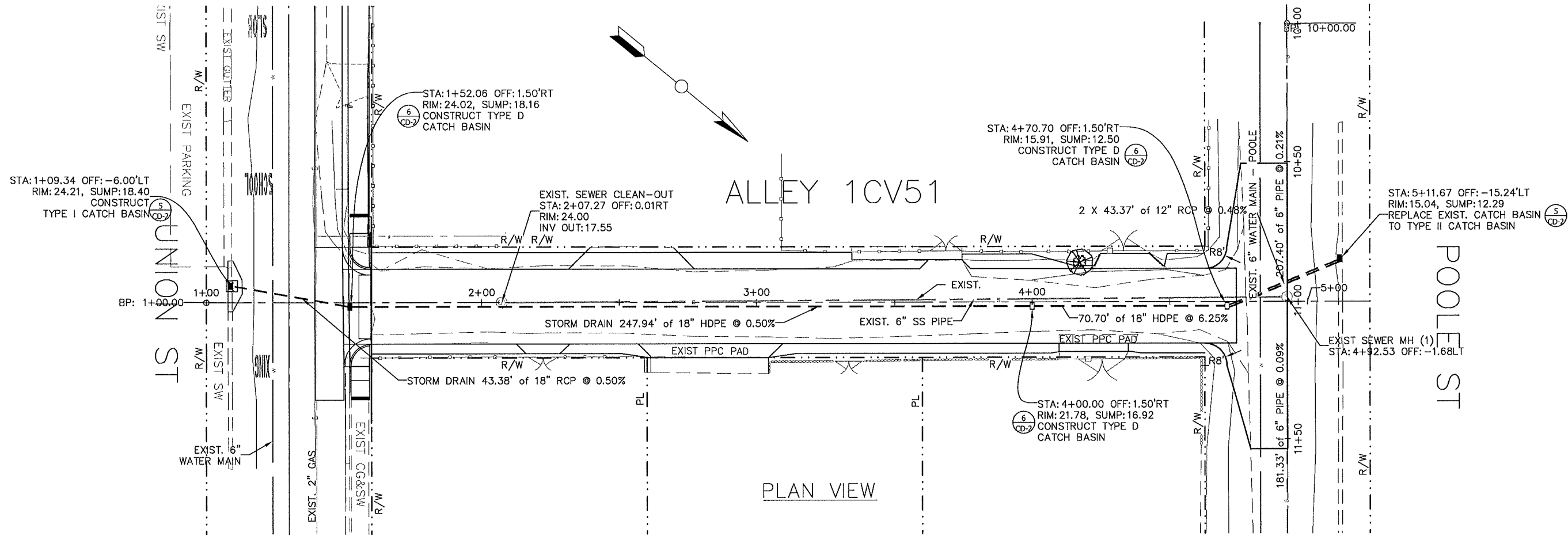

K:\Design\Projects\1424-Castroville Drainage & Rd Improv\CAD\Union-Poole_base.dwg, 2/22/2013 12:58:25 PM, moralesf, \\000sprint002new\300-M450C

SUBMITTED BY, JONATHAN L. PASCUA, P.E.	
DESIGN BY, BARNEY GUZMAN	CHKD BY, J.P.
DRAWN BY, FELIPE MORALES	CHKD BY, B.G./J.P.
SPECIFICATIONS WRITTEN BY, ISABELO DELA MERCED	CHKD BY, B.G./J.P.
APPROVAL RECOMMENDED BY, PAUL H. GREENWAY, P.E. ASSISTANT DIRECTOR OF PUBLIC WORKS	

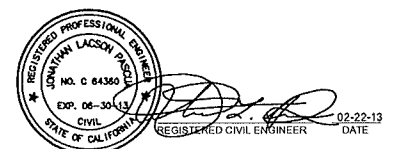

NO.	DATE	REVISION	APPROVED
▲			
▲			
▲			
▲			



COUNTY OF MONTEREY
RESOURCE MANAGEMENT AGENCY
DEPARTMENT OF PUBLIC WORKS
DESIGN SECTION
168 WEST ALISAL STREET, 2nd FLOOR
SALINAS, CALIFORNIA 93901
(831)755-4800/FAX (831)755-4958

DRAINAGE AND ROAD IMPROVEMENTS ON UNION STREET AND ALLEY 1CV51 IN CASTROVILLE PROJECT NO. 13-142465		
DRAINAGE PLAN & PROFILE		
DATE 02/11/2013	RELATIVE BORDER SCALE: IN INCHES 0 1 2 3	SHEET PP-3
SCALE 1:20(H), 1:10(H)	VIEW STORMDRAIN	

SHEET NUMBER	TOTAL SHEETS
9	10

CONSTRUCTION AREA SIGNS (STATIONARY MOUNTED)					
SIGN NO.	SIGN CODE	SIGN MESSAGE	PANEL SIZE (in)	NO. OF POST AND SIZE	NO. OF SIGNS
1	W20-1	ROAD WORK AHEAD	36 X 36	1 - 4in X 4in	4
2	G20-2	END ROAD WORK	36 X 18	1 - 4in X 4in	4

- NOTES:
- THIS PLAN ACCURATE FOR CONSTRUCTION AREA SIGN WORK ONLY.
 - EXACT SIGN LOCATIONS TO BE DETERMINED BY THE ENGINEER.

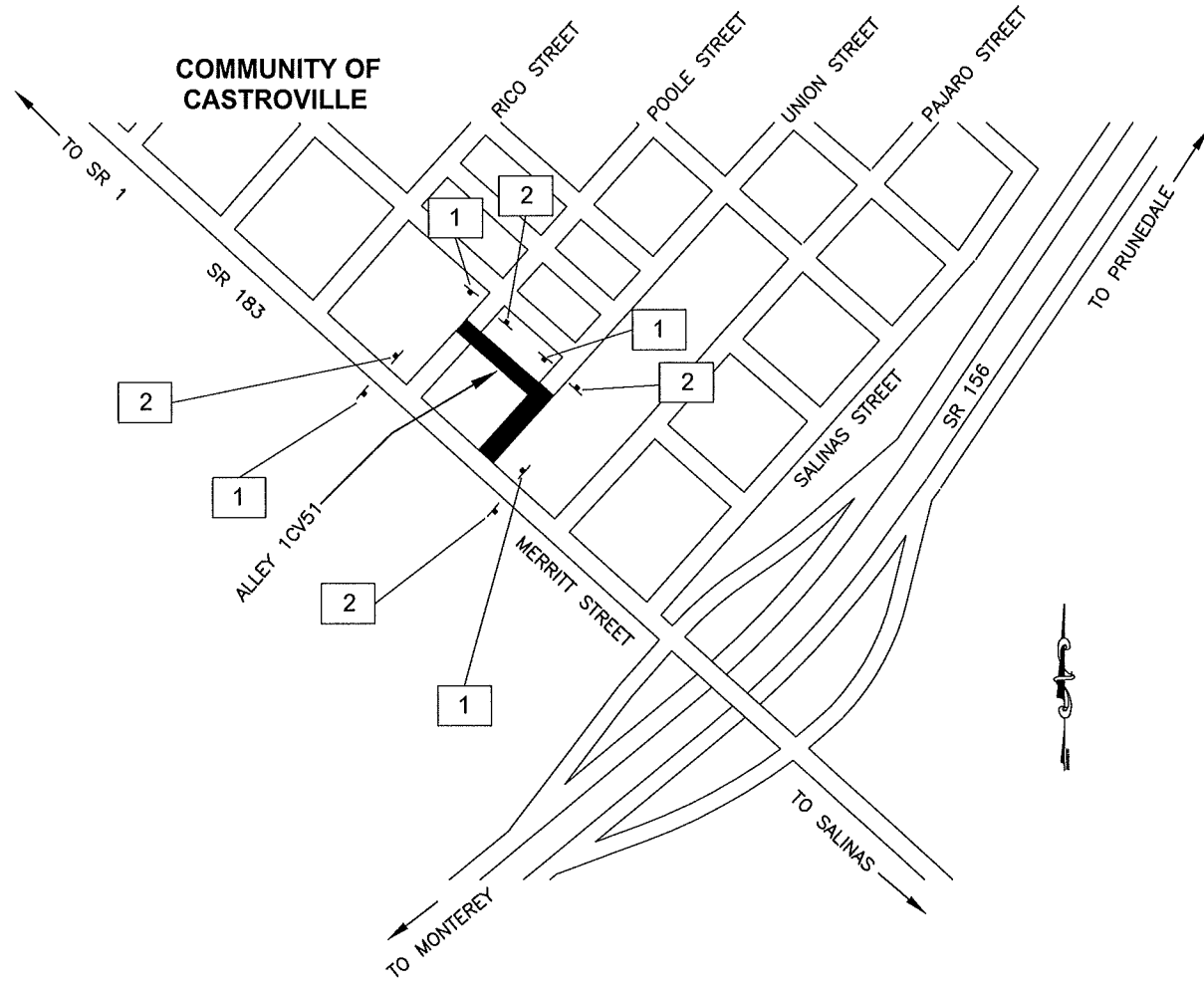

SUBMITTED BY, JONATHAN L. PASCUA, P.E.

DESIGN BY, ISABELO DELA MERCED/B. GUZMAN
 DRAWN BY, ISABELO DELA MERCED
 SPECIFICATIONS WRITTEN BY, ISABELO DELA MERCED

CHKD BY, J.P.
 CHKD BY, B.G./J.P.
 CHKD BY, B.G./J.P.

APPROVAL
 RECOMMENDED BY, PAUL H. GREENWAY, P.E.
 ASSISTANT DIRECTOR OF PUBLIC WORKS

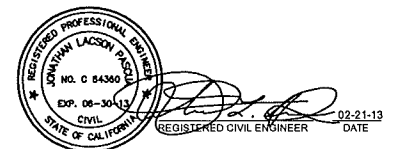

NO.	DATE	REVISION	APPROVED
▲			
▲			
▲			
▲			



COUNTY OF MONTEREY
 RESOURCE MANAGEMENT AGENCY
 DEPARTMENT OF PUBLIC WORKS
 DESIGN SECTION
 168 WEST ALISAL STREET, 2nd FLOOR
 SALINAS, CALIFORNIA 93901
 (831)755-4800/FAX (831)755-4958

DRAINAGE AND ROAD IMPROVEMENTS
 ON UNION STREET AND ALLEY 1CV51 IN CASTROVILLE
 PROJECT NO. 13-142465

CONSTRUCTION AREA SIGNS

DATE 02/15/2013	RELATIVE BORDER SCALE: IN INCHES 0 1 2 3	SHEET CS-1
SCALE NONE	VIEW CS-1	

SHEET NUMBER	TOTAL SHEETS
10	10

ROADWAY QUANTITY

LOCATION	HOT MIX ASPHALT (TYPE A)	CLASS 2 AGGREGATE BASE	IMPORTED MATERIAL (SHOULDER BACKING)	ROADWAY EXCAVATION	REMARK
	TON	CY	TON	CY	
ALLEY	204	230	28	249	4" HMA & 8" CL 2 AB UNDER ROADWAY & DRIVEWAYS
UNION STREET	34.5	19		117	3" HMA & 8" CL 2 AB UNDER ROADWAY
POOLE STREET	37.5	8	5	57	3" HMA & 8" CL 2 AB UNDER ROADWAY
UNION STREET	4.0	4			TRENCH BACK FILL
POOLE STREET	2.0				TRENCH BACK FILL
TOTAL	282	261	33	423	

ADJUST FRAME AND COVER

STATION	QUANTITY	DESCRIPTION
4+92.53 "A"	1	SEWER MANHOLE
2+07.27 "A"	1	SEWER CLEANOUT
TOTAL	2	

DRAINAGE QUANTITY

LOCATION	STATION	18" PLASTIC PIPE (HDPE)	18" RCP (CLASS III)	12" RCP (CLASS III)
		LF	LF	LF
ALLEY	1+52 "A" TO 4+71 "A"	319		89
UNION STREET	1+09.34 "A" TO 1+52 "A"		44	
POOLE STREET	4+71 "A" TO 5+11 "A"			
TOTAL		319	44	89

PAVEMENT DELINEATION

DETAIL NO. OR PAVEMENT MARKING	REMOVE THERMOPLASTIC PAVEMENT MARKING	THERMOPLASTIC PAVEMENT MARKING	THERMOPLASTIC TRAFFIC STRIPE 4" YELLOW (SOLID)
	SQFT	SQFT	LF
LIMIT LINE	24	24	
"SLOW"	23	23	
"SCHOOL"	35	35	
"XING"	21	21	
"STOP"	22	22	
DETAIL 21			100
TOTAL	125	125	100

MINOR CONCRETE

LOCATION	STATION, OFFSET & DESCRIPTION	MINOR CONCRETE (CURB & GUTTER)	MINOR CONCRETE (SIDEWALK)	MINOR CONCRETE (CURB RAMP)	MINOR CONCRETE (DRIVEWAY)	MINOR CONCRETE (CROSS GUTTER & VEE GUTTER)	MINOR CONCRETE (CONCRETE CAP FOR 12" RCP)	MINOR CONCRETE (CONCRETE CAP FOR UTILITY CONFLICT)	MINOR CONCRETE (MINOR STRUCTURE CATCH BASIN)
		CY	CY	CY	CY	CY	CY	CY	EA
UNION ST & ALLEY	1+45.75 "A" TO 1+55.43 "A"					4.4			
ALLEY	1+55.43 "A" TO 4+74 "A"					20.6			
UNION ST & ALLEY	1+60 "A" LT & RT			3.5					
UNION ST	10+20 "U", LT				2.3				
UNION ST	9+57.6 "U" TO 10+71 "U"		7.5						
UNION ST	9+57 "U" TO STA 11+36 "U"	10							
ALLEY	1+09.34 "A", TYPE I								1
ALLEY	1+52.06 "A", TYPE D								1
ALLEY	4+00 "A", TYPE D								1
ALLEY	4+74 "A", TYPE D								1
ALLEY	5+11.67 "A", TYPE II								1
POOLE ST	4+71 "A" TO 5+11 "A"						6.7		
UNION ST	1+24 "A" 3.4 LT, 6" WATER LINE							0.5	
UNION ST	1+40 "A" 0.6 LT, 2" GAS LINE							0.5	
POOLE ST	4+83 "A" 2.6 LT, WATER LINE							0.5	
POOLE ST	4+92 "A" 7.4 LT, SEWER LINE							0.5	
SUB TOTAL		10	7.5	3.5	2.3	25.0	6.7	2.0	5
TOTAL					57				5

WOOD FENCE

BEGIN	END	OFFSET	LENGTH (LF)	DESCRIPTION
9+56.8 "U"	10+80.9 "U"	LT	128	WOOD FENCE

COLD PLANE AC PAVEMENT

STATION			AREA	DESCRIPTION
BEGIN	END	OFFSET	SY	
9+57.55 "U"	11+33 "U"	LT	120	3" ON WB UNION STREET
4+62.7 "A"	4+92.7 "A"	LT & RT	223	3" ON INTERSECTION OF POOLE ST. & ALLEY
		TOTAL	343	

SUBMITTED BY, JONATHAN L. PASCUA, P.E.
 DESIGN BY, BARNEY GUZMAN
 DRAWN BY, FELIPE MORALES
 SPECIFICATIONS WRITTEN BY, ISABELA DELA MERCED
 APPROVAL RECOMMENDED BY, PAUL H. GREENWAY, P.E.
 ASSISTANT DIRECTOR OF PUBLIC WORKS

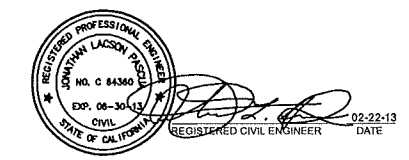

NO.	DATE	REVISION	APPROVED
▲			
▲			
▲			
▲			
▲			



COUNTY OF MONTEREY
 RESOURCE MANAGEMENT AGENCY
 DEPARTMENT OF PUBLIC WORKS
 DESIGN SECTION
 168 WEST ALISAL STREET, 2nd FLOOR
 SALINAS, CALIFORNIA 93901
 (831)755-4800/FAX (831)755-4958

DRAINAGE AND ROAD IMPROVEMENTS ON UNION STREET AND ALLEY 1CV51 IN CASTROVILLE PROJECT NO. 13-142465		
SUMMARY OF QUANTITIES		
DATE 2/22/2013	RELATIVE BORDER SCALE: IN INCHES 0 1 2 3	SHEET Q-1
SCALE N.T.S.	VIEW REV QUANTITY SUMMARY	