

**FREEWAY MAINTENANCE  
AGREEMENT  
WITH  
COUNTY OF MONTEREY**

THIS AGREEMENT is made effective this 26 day of July, 2016, by and between the State of California, acting by and through the Department of Transportation, hereinafter referred to as "STATE" and the COUNTY of MONTEREY; hereinafter referred to as "COUNTY" and collectively referred to as "PARTIES".

**SECTION I**

**RECITALS**

1. WHEREAS, on August 28, 2007 a Freeway Agreement was executed between COUNTY and STATE, wherein the PARTIES consented to certain adjustments of the local street and road system required for the development of that portion of STATE Highway Route (SR) 101 within the jurisdictional limits of the COUNTY of MONTEREY as a freeway; and
2. WHEREAS, recent adjustments to said freeway have now been completed, or are nearing completion, and the PARTIES hereto mutually desire to identify the maintenance responsibilities for improvements to separation structures and landscaped areas lying within those modified freeway limits; and
3. The degree or extent of maintenance work to be performed, and the standards therefore, shall be in accordance with the provisions of Section 27 of the California Streets and Highways Code (hereinafter referred to as the "Streets and Highways Code") and the then current edition of the STATE Maintenance Manual.
4. WHEREAS, pursuant to Section 1 of the above August 28, 2007 Freeway Agreement, COUNTY has resumed or will resume control and maintenance over each of the affected relocated or reconstructed COUNTY streets, except for those portions adopted as a part of the freeway proper.

NOW THEREFORE IT IS AGREED:

**SECTION II**

**AGREEMENT**

1. COUNTY agrees to continue their control and maintenance of each of the affected relocated or reconstructed COUNTY streets and roads as shown on that plan map attached hereto, marked Exhibit A, and made a part hereof by this reference.
2. STATE agrees to continue control and maintenance of those portions adopted as a part of SR 101 Freeway proper as shown Exhibit A.

3. When another planned future improvement has been constructed and/or a minor revision has been effected within the limits of the freeway herein described which will affect the PARTIES' division of maintenance responsibility as described herein, STATE will provide a new dated and revised Exhibit "A" which will thereafter supersede the attached original Exhibit "A" and become part of this Agreement.
4. COUNTY and STATE agree to accept their then respective operational and maintenance responsibilities and related associated costs thereof in the event jurisdictional boundaries of the PARTIES should change and Exhibit "A" is amended to reflect those changes.
5. COUNTY must obtain the necessary Encroachment Permits from STATE's District 5 Encroachment Permit Office prior to entering STATE right of way to perform COUNTY maintenance responsibilities. This permit will be issued at no cost to COUNTY.
6. VEHICULAR AND PEDESTRIAN OVERCROSSINGS
  - 6.1. STATE will maintain, at STATE expense, the entire structure of any STATE constructed vehicular and pedestrian overcrossings of SR 101 below the deck wearing surface and any wearing surface treatment thereon.
  - 6.2. COUNTY will maintain, at COUNTY expense, the deck wearing surface and structural drainage system (and shall perform such work as may be necessary to ensure an impervious and/or otherwise suitable surface) and all portions of the structure above the bridge deck, including, but without limitation, lighting installations, as well as all traffic service facilities (sidewalks, signs, pavement markings, bridge rails, etc.) that may be required for the benefit or control of traffic using that overcrossing.
  - 6.3. As directed by section 92.6 of the Streets and Highways Code, at locations determined by STATE, screening shall be placed on STATE freeway overpasses on which pedestrians are allowed. All screens installed under this program will be maintained by STATE, at STATE expense.
7. VEHICULAR AND PEDESTRIAN UNDERCROSSINGS
  - 7.1. STATE will maintain the entire structure of all STATE-constructed vehicular and pedestrian undercrossings of STATE freeways except as hereinafter provided.
  - 7.2. COUNTY will maintain the roadway sections, including the traveled way, shoulders, curbs, sidewalks, wall surfaces (including eliminating graffiti), drainage installations, lighting installations and traffic service facilities that may be required for the benefit or control of traffic using that undercrossing.

- 7.3. COUNTY will request STATE's District Encroachment Permit Engineer to issue the necessary Encroachment Permit for any proposed change in minimum vertical clearances between COUNTY roadway surface and the structure that results from modifications to the roadway (except when said modifications are made by STATE). If the planned modifications will result in a reduction in the minimum clearance within the traveled way, an estimate of the clearance reduction must be provided to STATE's Transportation Permit Engineer prior to starting work. Upon completion of that work, a vertical clearance diagram will be furnished to STATE's Transportation Permit Engineer that shows revised minimum clearances for all affected movements of traffic, both at the edges of the traveled way and at points of minimum clearance within the traveled way.
8. WALLS AND COLUMNS – COUNTY is responsible for debris removal, cleaning, and painting to keep COUNTY's side of any wall structure or column free of debris, dirt, and graffiti.
9. LANDSCAPED AREAS - COUNTY is responsible for the maintenance of any plantings or other types of roadside development lying outside of the fenced right of way area reserved for exclusive freeway.
10. INTERCHANGE OPERATON - It is STATE's responsibility to provide efficient operation of freeway interchanges, including ramp connections to local streets and roads.
11. ELECTRICALLY OPERATED TRAFFIC CONTROL DEVICES
- 11.1. The cost of installation, operation, maintenance, repairs, replacement and energy costs of safety lighting, traffic signals or other necessary electrically operated traffic control devices placed at interchanges of SR 1 Freeway and COUNTY streets and roads and at ramp connections or SR 1 and COUNTY facilities shall be shared by the PARTIES as a separate "Shared Cost Electrical Agreement" between the PARTIES.
- 11.2. Timing of traffic signals, which shall be coordinated with COUNTY to the extent that no conflict is created with freeway operations, shall be the sole responsibility of STATE.
12. DRAINAGE – PARTIES have drainage conduits that begin in COUNTY maintained areas and terminate in STATE areas and vice versa. It is mutually agreed that for all such **shared culvert links** between the STATE and COUNTY that the STATE shall maintain all conduits that outlet within STATE and that COUNTY shall maintain those conduits that outlet in COUNTY maintained areas. PARTIES further that, when replaced, such conduits will be replaced at shared cost and that STATE shall, at STATE expense, construct junction structures at STATE right of way to thereafter segregate COUNTY from STATE drainage facilities. When these **shared culvert link** replacements are constructed, EXHIBIT "A" shall be modified to reflect such change.

13. **BICYCLE PATHS** - Except for bicycle paths constructed as permitted encroachments within STATE's right of way for which the permittee is solely responsible for all path improvements, STATE will maintain, at STATE expense, all fences, guard railing, drainage facilities, slope and structural adequacy of any bicycle path located and constructed within STATE's right of way. COUNTY will maintain, at COUNTY expense, a safe facility for bicycle travel along the entire length of the path by providing sweeping and debris removal when necessary; and all signing and striping and pavement markings required for the direction and operation of that non-motorized facility.

#### 14. **LEGAL RELATIONS AND RESPONSIBILITIES**

14.1. Nothing within the provisions of this Agreement is intended to create duties or obligations to or rights in third parties not PARTIES to this Agreement or to affect the legal liability of a PARTY to the Agreement by imposing any standard of care with respect to the operation and maintenance of STATE highways and local facilities different from the standard of care imposed by law.

14.2. Neither COUNTY nor any officer or employee thereof is responsible for any injury, damage or liability occurring by reason of anything done or omitted to be done by STATE, under or in connection with any work, authority or jurisdiction conferred upon STATE arising under this Agreement. It is understood and agreed that STATE shall fully defend, indemnify and save harmless COUNTY and all of their officers and employees from all claims, suits or actions of every name, kind and description brought forth under, including, but not limited to, tortious, contractual, inverse condemnation and other theories or assertions of liability occurring by reason of anything done or omitted to be done by STATE under this Agreement.

14.3. Neither STATE nor any officer or employee thereof is responsible for any injury, damage or liability occurring by reason of anything done or omitted to be done by COUNTY under or in connection with any work, authority or jurisdiction conferred upon COUNTY and arising under this Agreement. It is understood and agreed that COUNTY shall fully defend, indemnify and save harmless STATE and all of its officers and employees from all claims, suits or actions of every name, kind and description brought forth under, including, but not limited to, tortious, contractual, inverse condemnation or other theories or assertions of liability occurring by reason of anything done or omitted to be done by COUNTY under this Agreement.

**15. PREVAILING WAGES:**

**15.1. Labor Code Compliance**- If the work performed on this Project is done under contract and falls within the Labor Code section 1720(a)(1) definition of a "public work" in that it is construction, alteration, demolition, installation, or repair; or maintenance work under Labor Code section 1771. COUNTY must conform to the provisions of Labor Code sections 1720 through 1815, and all applicable provisions of California Code of Regulations found in Title 8, Chapter 8, Subchapter 3, Articles 1-7. COUNTY agrees to include prevailing wage requirements in its contracts for public work. Work performed by COUNTY's own forces is exempt from the Labor Code's Prevailing Wage requirements.

**15.2. Requirements in Subcontracts** - COUNTY shall require its contractors to include prevailing wage requirements in all subcontracts funded by this Agreement when the work to be performed by the subcontractor is a "public work" as defined in Labor Code Section 1720(a)(1) and Labor Code Section 1771. Subcontracts shall include all prevailing wage requirements set forth in COUNTY's contracts.

**16. INSURANCE:**

**16.1. SELF-INSURED** - COUNTY is self-insured. COUNTY agrees to deliver evidence of self-insured coverage providing general liability insurance, coverage of bodily injury liability and property damage liability, naming the STATE, its officers, agents and employees as the additional insured in an amount of \$1 million per occurrence and \$2 million in aggregate and \$5 million in excess. Coverage shall be evidenced by a certificate of insurance in a form satisfactory to the STATE that shall be delivered to the STATE with a signed copy of this Agreement in a form satisfactory to STATE, along with a signed copy of the Agreement.

**16.2. SELF-INSURED - using Contractor** - If the work performed under this Agreement is done by COUNTY's contractor(s), COUNTY shall require its contractor(s) to maintain in force, during the term of this Agreement, a policy of general liability insurance, including coverage of bodily injury liability and property damage liability, naming the STATE, its officers, agents and employees as the additional insured in an amount of \$1 million per occurrence and \$2 million in aggregate and \$5 million in excess. Coverage shall be evidenced by a certificate of insurance in a form satisfactory to the STATE and shall be delivered to the STATE with a signed copy of this Agreement.

**17. TERMINATION** - This Agreement may be terminated by timely mutual written consent by PARTIES, and COUNTY's failure to comply with the provisions of this Agreement may be grounds for a Notice of Termination by STATE.

**18. TERM OF AGREEMENT** - This Agreement shall become effective on the date first shown on its face sheet and shall remain in full force and effect until amended or terminated at any time upon mutual consent of the PARTIES or until terminated by STATE for cause.

***PARTIES are empowered by Streets and Highways Code Section 114 and 130 to enter into this Agreement and have delegated to the undersigned the authority to execute this Agreement on behalf of the respective agencies and covenant to have followed all the necessary legal requirements to validly execute this Agreement.***

IN WITNESS WHEREOF, PARTIES hereto have set their hands and seals the day and year first above written.

THE COUNTY OF MONTEREY

STATE OF CALIFORNIA  
DEPARTMENT OF TRANSPORTATION

By:   
JANE PARKER  
Chair, Board of Supervisors

MALCOLM DOUGHERTY  
Director of Transportation

Initiated and Approved

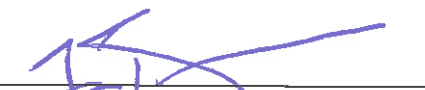
By:   
LEW BAUMAN  
County Administrative Officer

By:   
SARA von SCHWIND  
Deputy District Director  
Maintenance & Operations  
District 5

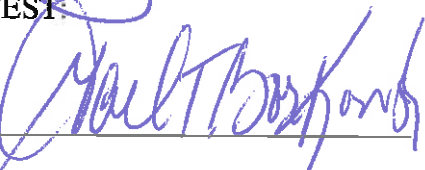
ATTEST  
By:   
GAIL T. BORKOWSKI  
County Clerk to the Board

Approved as to Form

As to Form and Procedure:

By:   
MARY GRACE PERRY  
Deputy County Counsel

By:   
Attorney  
Department of Transportation

**EXHIBIT "A"**

**(Plan map identifying STATE Route 101 (Freeway proper) and COUNTY road(s) and facilities (12-Sheets - Attached))**

**05-0181E4  
PRUNDALE IMPROVEMENT  
PROJECT**

**STATE OF CALIFORNIA  
DEPARTMENT OF TRANSPORTATION**

**NH-Q101(187)E**

**PROJECT PLANS FOR CONSTRUCTION ON  
STATE HIGHWAY  
IN MONTEREY COUNTY IN AND NEAR  
PRUNDALE AT VARIOUS LOCATIONS FROM  
0.3 KM NORTH OF LITTLE BEAR CREEK UNDERCROSSING  
TO 0.5 KM NORTH OF ECHO VALLEY ROAD**

**LEGEND**

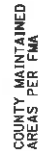

COUNTY MAINTAINED  
AREAS PER FMA



COUNTY MAINTAINED  
ROADWAY PER FMA



COUNTY MAINTAINED  
SHARED CULVERT LINK PER FMA

Dist#	COUNTY	ROUTE	PROJECT	SHEET NO.	TOTAL SHEETS
05	Mon	101	R146.8/159.7	1	12



LOCATION MAP

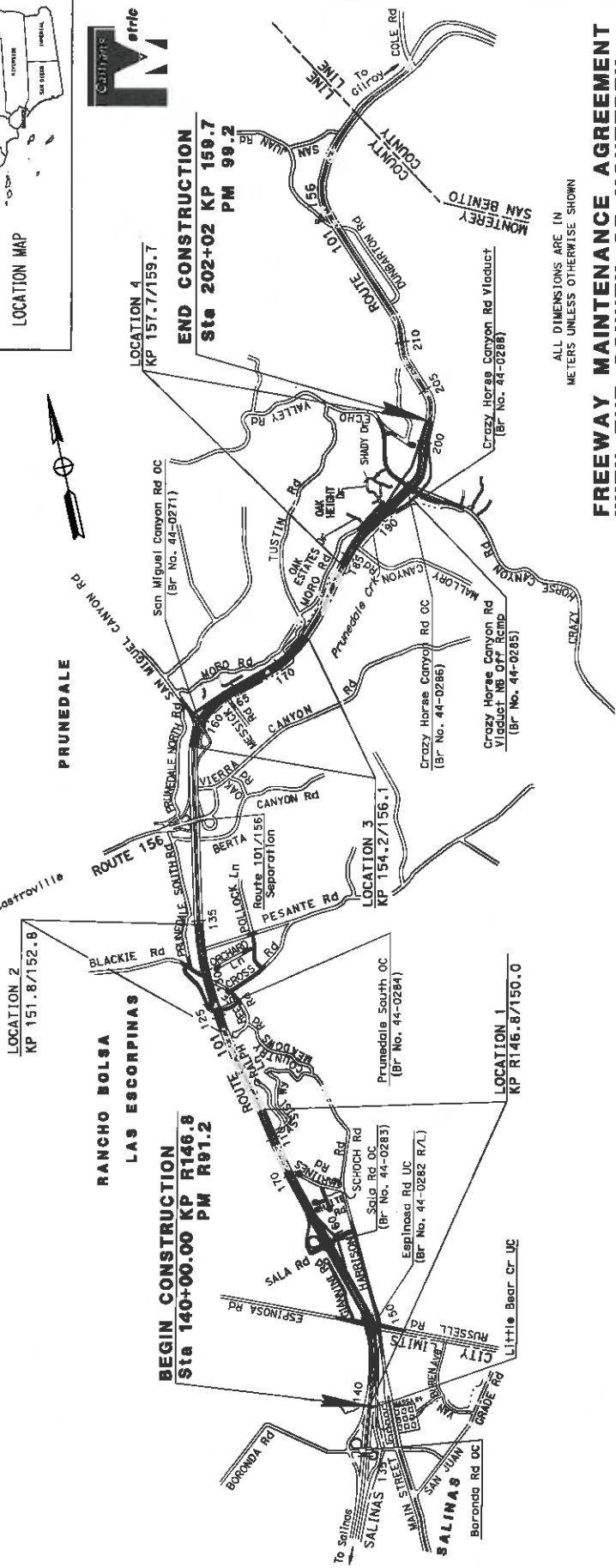
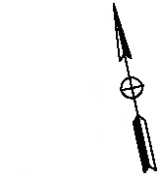

**BEGIN CONSTRUCTION  
Sta 140+00.00 KP R146.8  
PM R97.2**

**END CONSTRUCTION  
Sta 202+02 KP 159.7  
PM 99.2**

ALL DIMENSIONS ARE IN  
METERS UNLESS OTHERWISE SHOWN

**FREEWAY MAINTENANCE AGREEMENT  
WITH THE COUNTY OF MONTEREY**

NO SCALE



DATE	COUNTY	ROUTE	BLANKET NO.	SHEET NO.	TOTAL SHEETS
05	Mon	101	R146-R/159.7	2	12



**05-0161E4  
PRUNDALE IMPROVEMENT  
PROJECT**

**LEGEND**

COUNTY MAINTAINED  
AREAS PER FMA

COUNTY MAINTAINED  
ROADWAY PER FMA

COUNTY MAINTAINED  
SHARED CULVERT LINK PER FMA

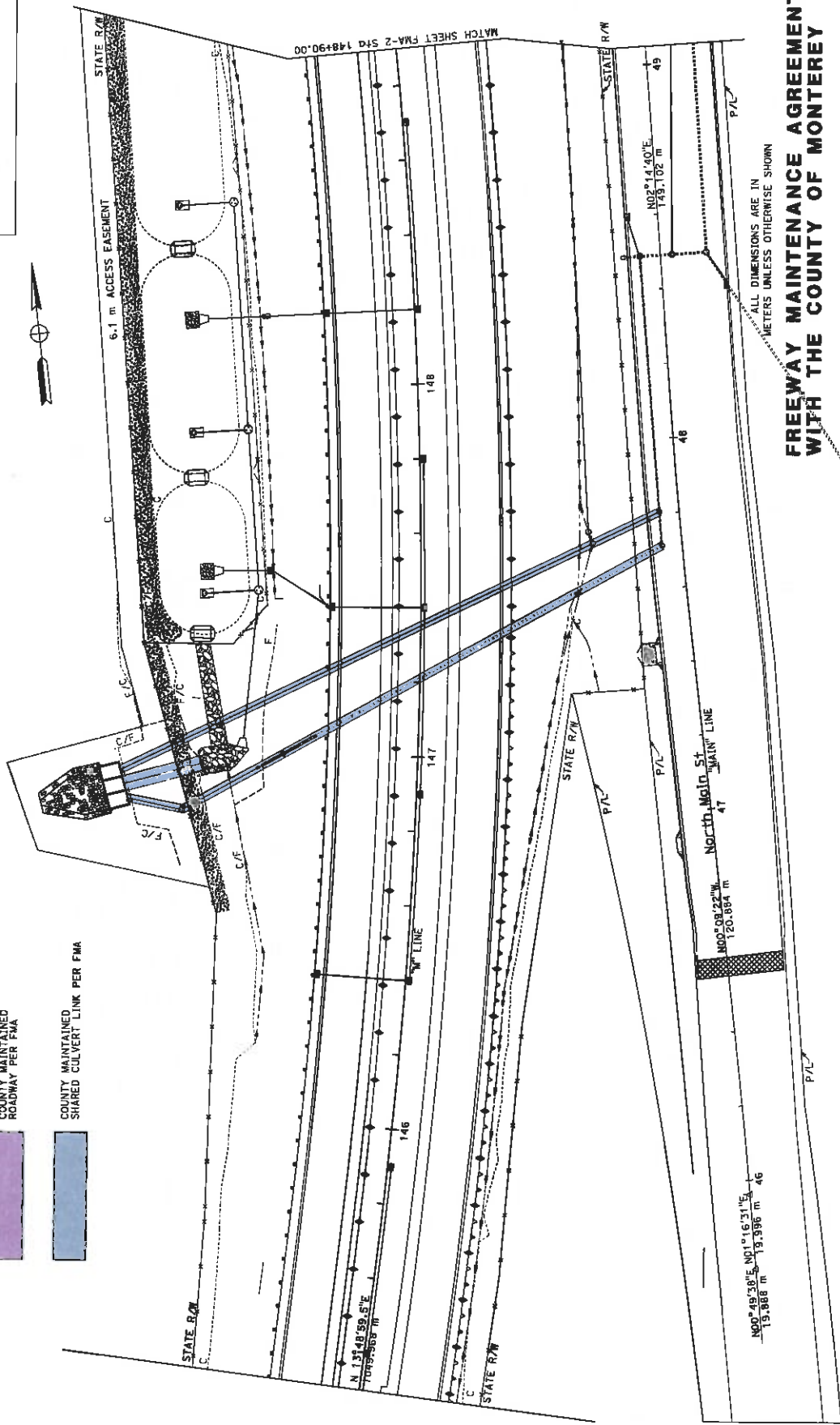

ALL DIMENSIONS ARE IN METERS UNLESS OTHERWISE SHOWN

**FREEWAY MAINTENANCE AGREEMENT  
WITH THE COUNTY OF MONTEREY**

SCALE 1:500

**FMA-1**

STATE OF CALIFORNIA - DEPARTMENT OF TRANSPORTATION	FUNCTIONAL SUPERVISOR	CHECKED BY	DATE REVISED
DESIGNED BY	DESIGNED BY	DESIGNED BY	DATE REVISED

DIST	COUNTY	ROUTE	KILOMETER POST TOTAL PROJECT	SHEET NO.	TOTAL SHEETS
05	Mon	101	R146.8/158.7	3	12



**05-0161E4  
PRUNDALE IMPROVEMENT  
PROJECT**

**LEGEND**

- COUNTY MAINTAINED AREAS PER FMA
- COUNTY MAINTAINED ROADWAY PER FMA
- COUNTY MAINTAINED SHARED CULVERT LINK PER FMA

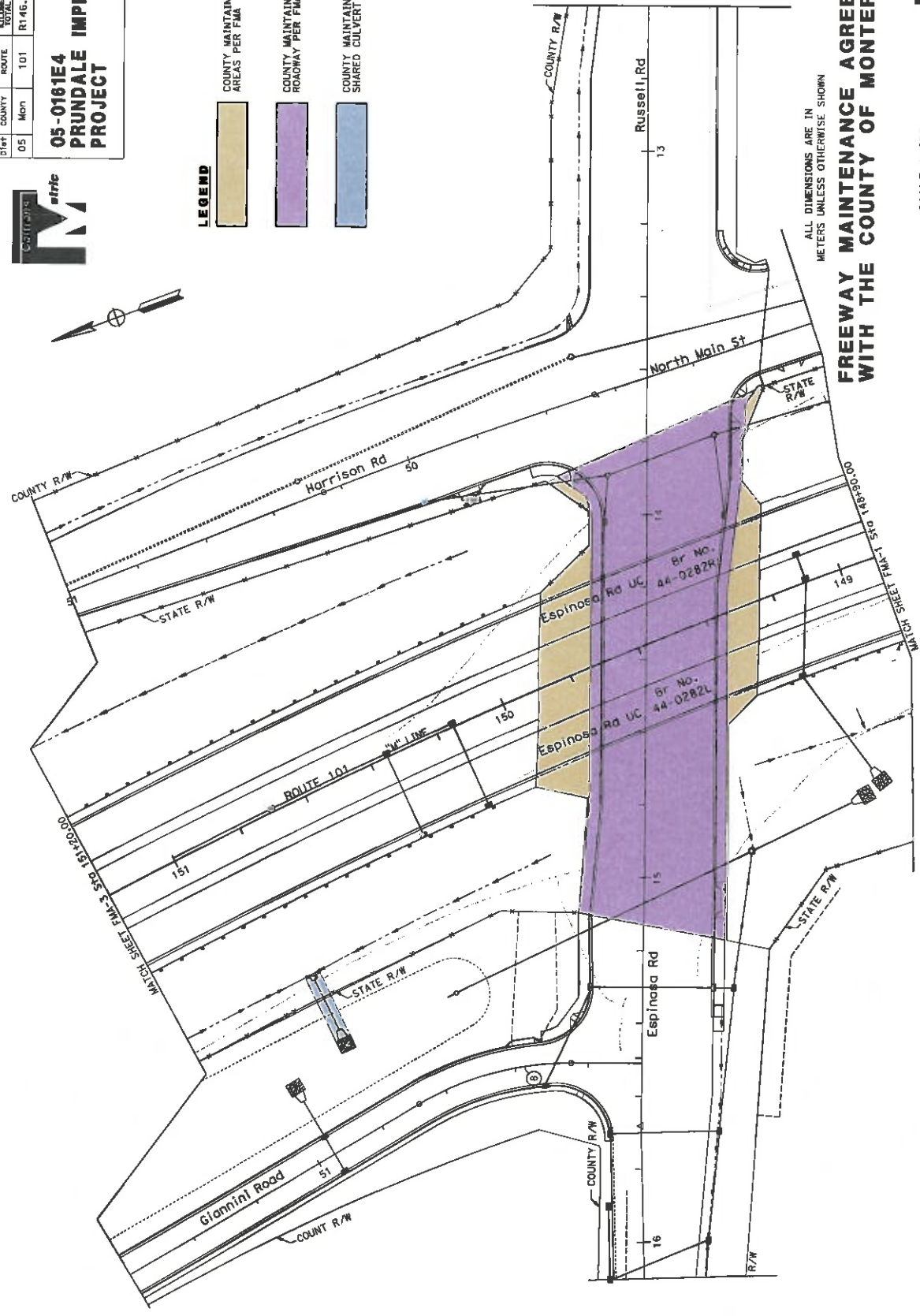

ALL DIMENSIONS ARE IN METERS UNLESS OTHERWISE SHOWN

**FREEWAY MAINTENANCE AGREEMENT WITH THE COUNTY OF MONTEREY**

SCALE 1:500

FMA-2

RELATIVE BORDER SCALE IS IN MILLIMETERS

CU 06226

EA 0161E1

STATE OF CALIFORNIA - DEPARTMENT OF TRANSPORTATION	FUNCTIONAL SUPERVISOR	CALCULATED BY	DESIGNED BY	REVISIONS	DATE REVISIONS



BORDER LAST REVISED 3/1/2007

DATE PLOTTED 06-JUL-2016  
TIME PLOTTED 13:55

Div#	COUNTY	ROUTE	MILEAGE PER POST	SHEET NO.	TOTAL SHEETS
05	Mon	101	R146-B/159-7	4	12

**05-0161E4  
PRUNDALE IMPROVEMENT  
PROJECT**



**LEGEND**

- COUNTY MAINTAINED AREAS PER FMA
- COUNTY MAINTAINED ROADWAY PER FMA
- COUNTY MAINTAINED SHARED CULVERT LINK PER FMA

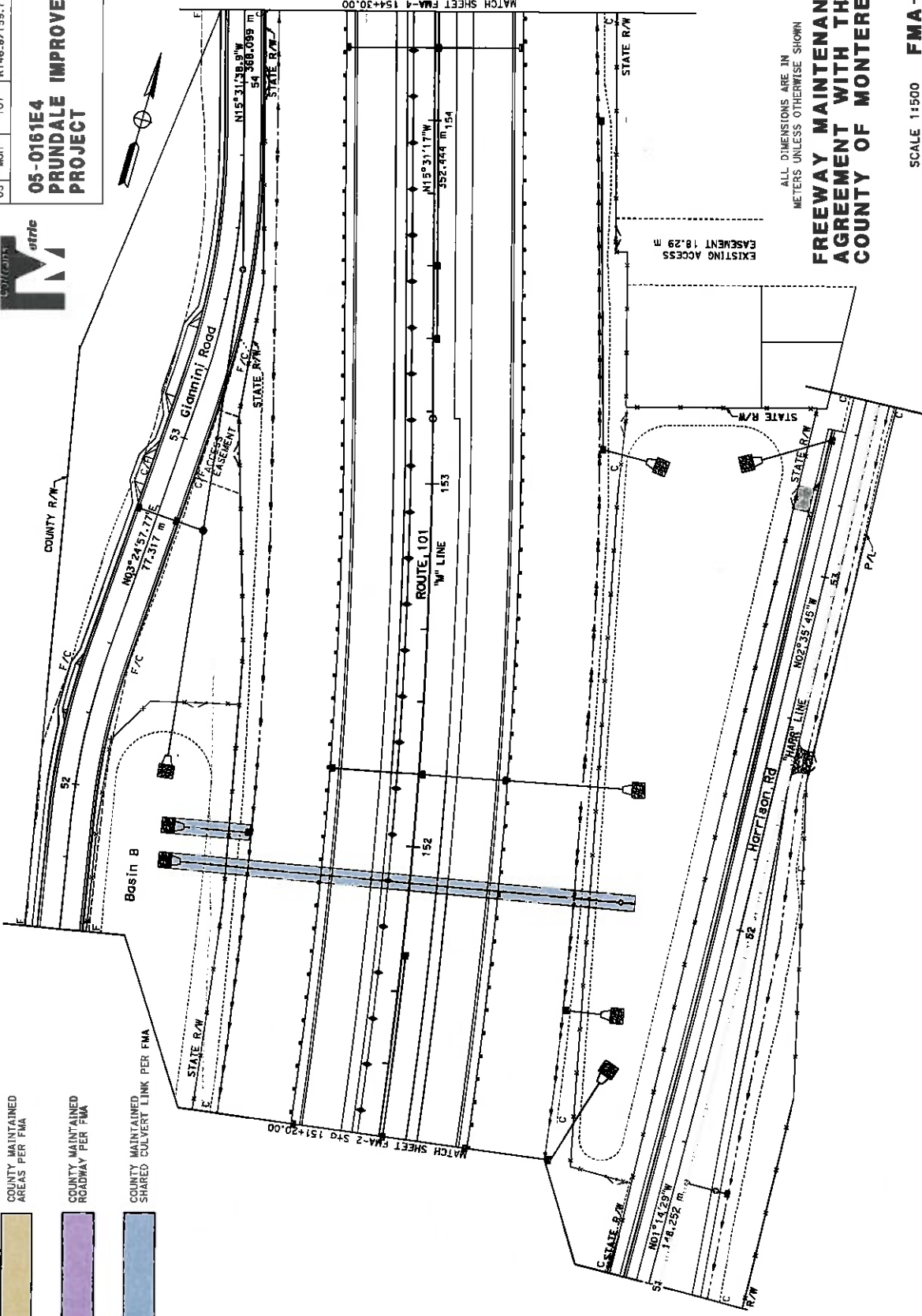

ALL DIMENSIONS ARE IN METERS UNLESS OTHERWISE SHOWN

**FREEWAY MAINTENANCE AGREEMENT WITH THE COUNTY OF MONTEREY**

SCALE 1:1500 **FMA-3**

STATE OF CALIFORNIA - DEPARTMENT OF TRANSPORTATION	FUNCTIONAL SUPERVISOR	CALCULATED BY	DESIGNED BY	REVISOR	DATE REVISED

RELATIVE BORDER SCALE IS IN MILLIMETERS

BORDER LAST REVISED 3/1/2007

CU 06226 EA 0161E1

DIST	COUNTY	ROUTE	KILOMETER POST TOTAL PROJECT	SHEET NO.	TOTAL SHEETS
05	Mon	101	R146-B/159-7	5	12

**05-0161E4  
PRUNDALE IMPROVEMENT  
PROJECT**



**LEGEND**

- COUNTY MAINTAINED AREAS PER FMA
- COUNTY MAINTAINED ROADWAY PER FMA
- COUNTY MAINTAINED SHARED CULVERTY LINK PER FMA

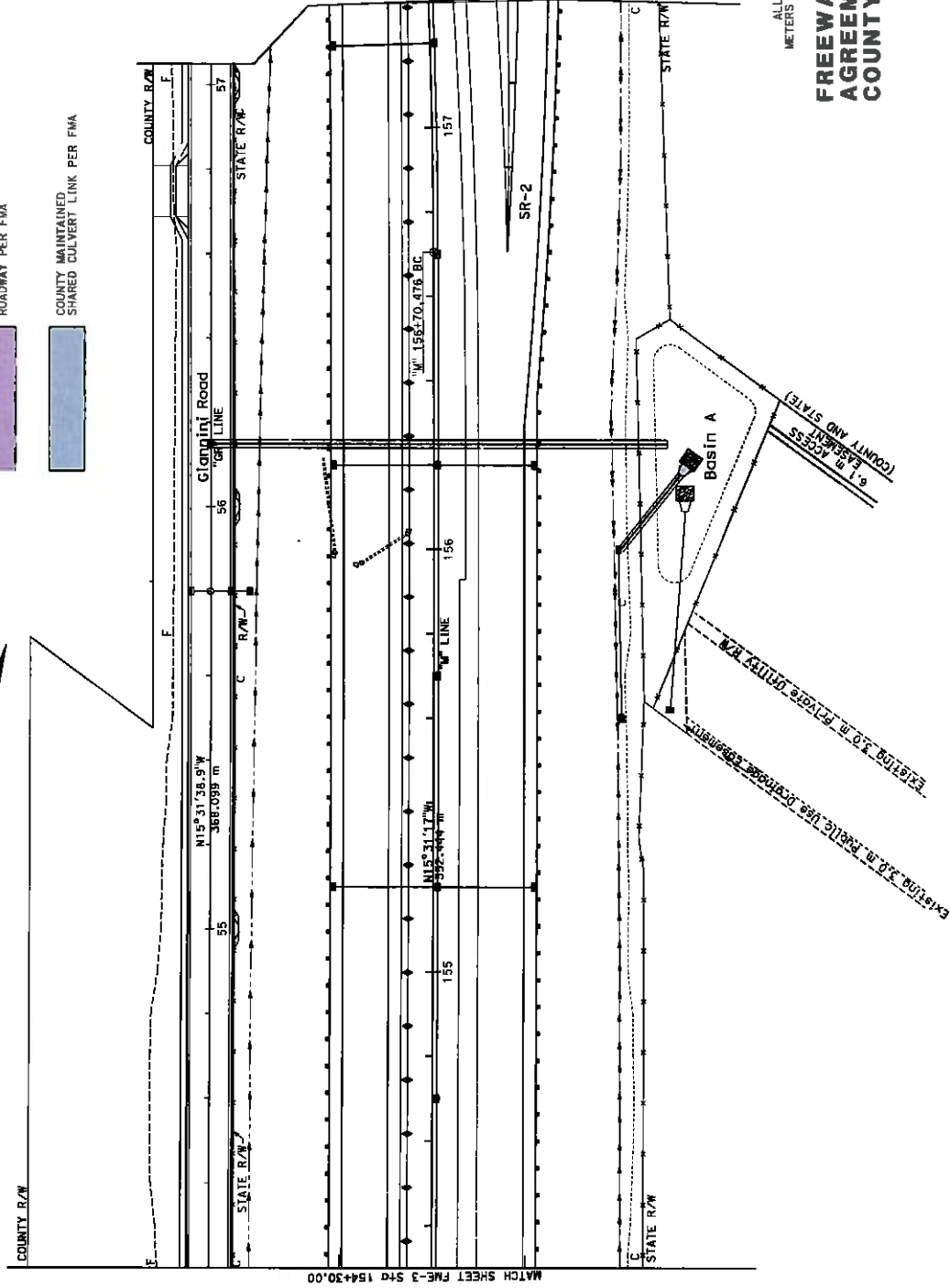

ALL DIMENSIONS ARE IN METERS UNLESS OTHERWISE SHOWN

**FREEWAY MAINTENANCE  
AGREEMENT WITH THE  
COUNTY OF MONTEREY**

SCALE 1:500

FMA - 4

CU 06226

EA 0161E1

RELATIVE BORDER SCALE  
1:5 IN MILLIMETERS

BORDER LAST REVISED 3/1/2007

STATE OF CALIFORNIA - DEPARTMENT OF TRANSPORTATION		FUNCTIONAL SUPERVISOR		DESIGNED BY	CHECKED BY	REVISOR	DATE REVISED
CALCULATED		DESIGNED BY		REVISOR		DATE REVISED	



USERNAME: a1161mas  
DGN FILE: 50181E.FMA06.dgn

0 20 40 60 80

05-11-C DATE PLOTTED: 06-JUN-2016 TIME PLOTTED: 13:59

DATE	COUNTY	ROUTE	NAME PER POST TOTAL PROJECT	SHEET NO.	TOTAL SHEETS
05	Mon	101	R146-B/159.7	6	12



**05-0161E4  
PRUNDALE IMPROVEMENT  
PROJECT**

- LEGEND**
- COUNTY MAINTAINED AREAS PER FMA
  - COUNTY MAINTAINED ROADWAY PER FMA
  - COUNTY MAINTAINED SHARED CULVERT LINK PER FMA

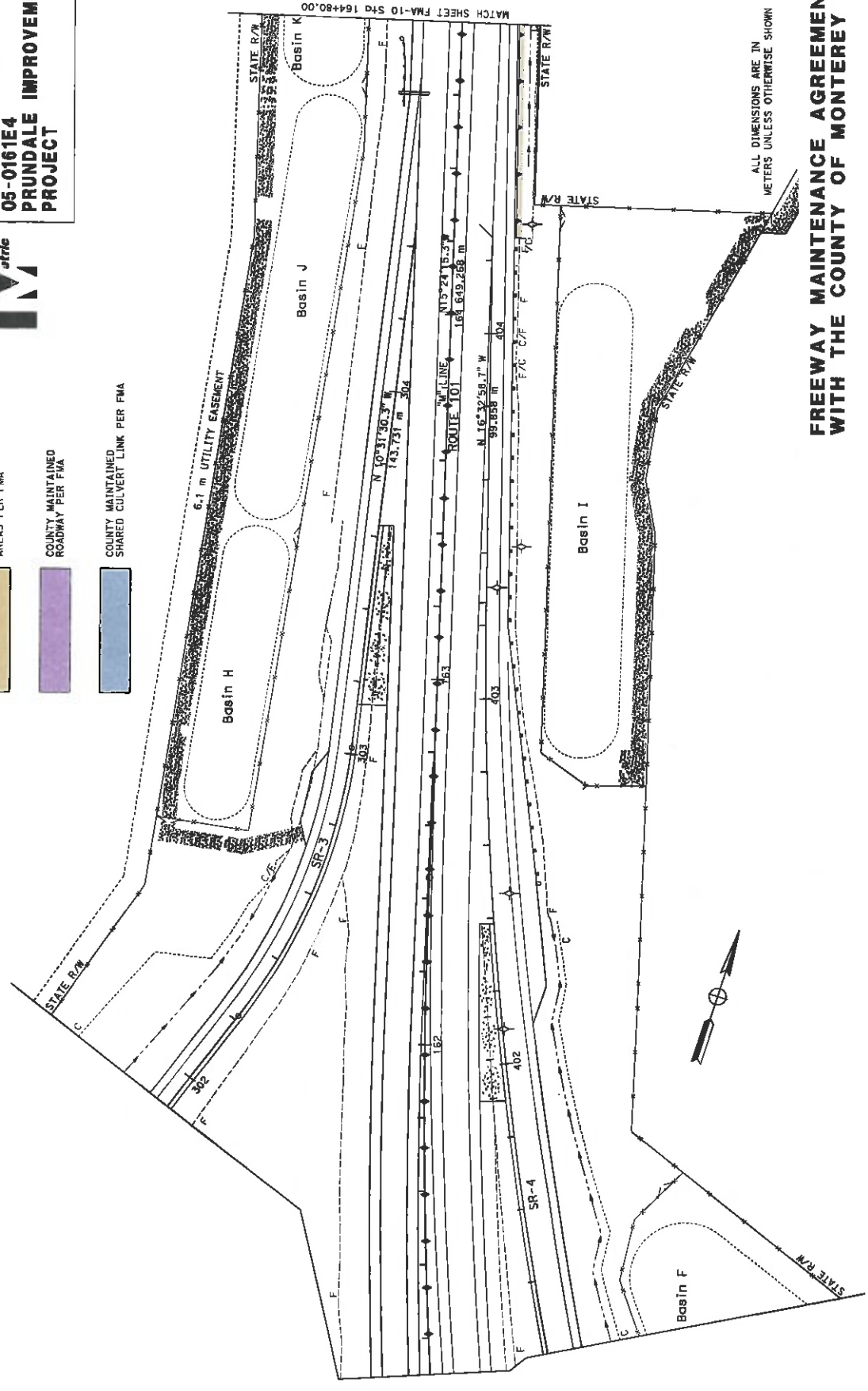

**FREEWAY MAINTENANCE AGREEMENT  
WITH THE COUNTY OF MONTEREY**

**FMA-5**

SCALE 1:500

USERNAME → 4171043  
JOB FILE → 50161E\_FMA10.dgn



BORDER LAST REVISED 3/1/2007

STATE OF CALIFORNIA - DEPARTMENT OF TRANSPORTATION	FUNCTIONAL SUPERVISOR	CHECKED BY	DATE REVISED

LAST REVISION DATE PLOTTED → 05-08-11-2016  
TIME PLOTTED → 14:00

DATE	05	COUNTY	Mon	ROUTE	101	MILEAGE PER SHEET	R146.8/159.7	SHEET NO.	7	TOTAL SHEETS	12
------	----	--------	-----	-------	-----	-------------------	--------------	-----------	---	--------------	----



**05-0161E4  
PRUNDALE IMPROVEMENT  
PROJECT**

**LEGEND**

- COUNTY MAINTAINED AREAS PER FMA
- COUNTY MAINTAINED ROADWAY PER FMA
- COUNTY MAINTAINED SHARED CULVERT LINK PER FMA

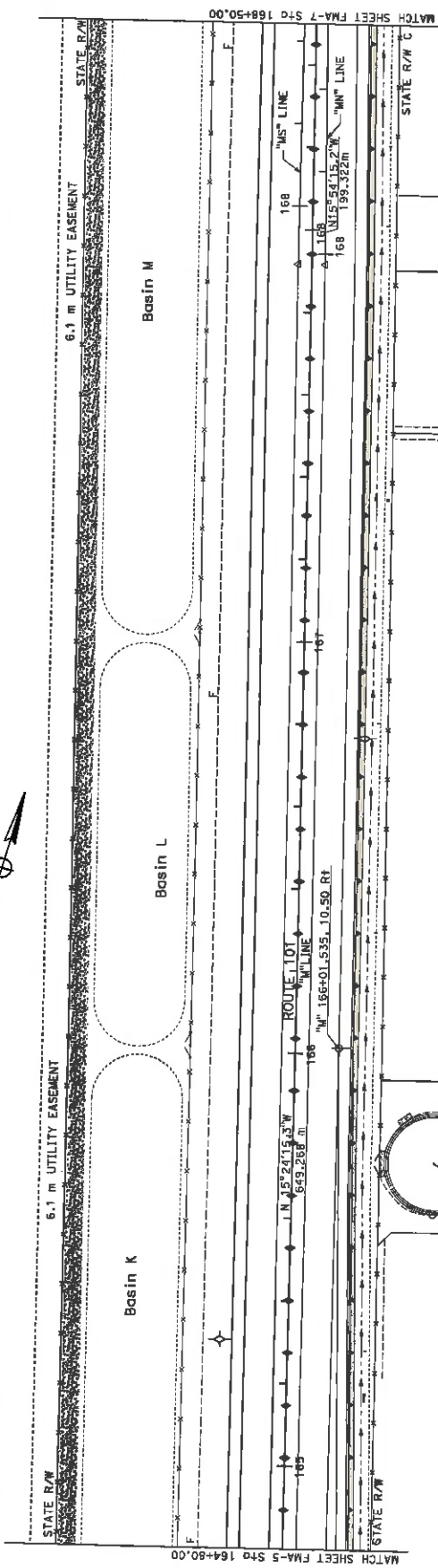

ALL DIMENSIONS ARE IN METERS UNLESS OTHERWISE SHOWN

**FREEWAY MAINTENANCE AGREEMENT  
WITH THE COUNTY OF MONTEREY**

**FMA-6**

SCALE 1:500

EA 0161E1

CU 05226

USERNAME → 3181663  
DWG FILE → 30181E.FMA1.dwg



BORDER LAST REVISED 3/1/2007

STATE OF CALIFORNIA - DEPARTMENT OF TRANSPORTATION	FUNCTIONAL SUPERVISOR	DESIGNED BY	DATE REVISID
DESIGNED BY	DATE REVISID	DESIGNED BY	DATE REVISID

DATE	05	COUNTY	Mon	ROUTE	101	FILE NO.	R146-B/159.7	SHEET NO.	8	TOTAL SHEETS	12
------	----	--------	-----	-------	-----	----------	--------------	-----------	---	--------------	----

**05-0161E4  
PRUNDALE IMPROVEMENT  
PROJECT**



- LEGEND**
- COUNTY MAINTAINED AREAS PE FMA
  - COUNTY MAINTAINED ROADWAY PER FMA
  - COUNTY MAINTAINED SHARED CULVERT LINK PER FMA

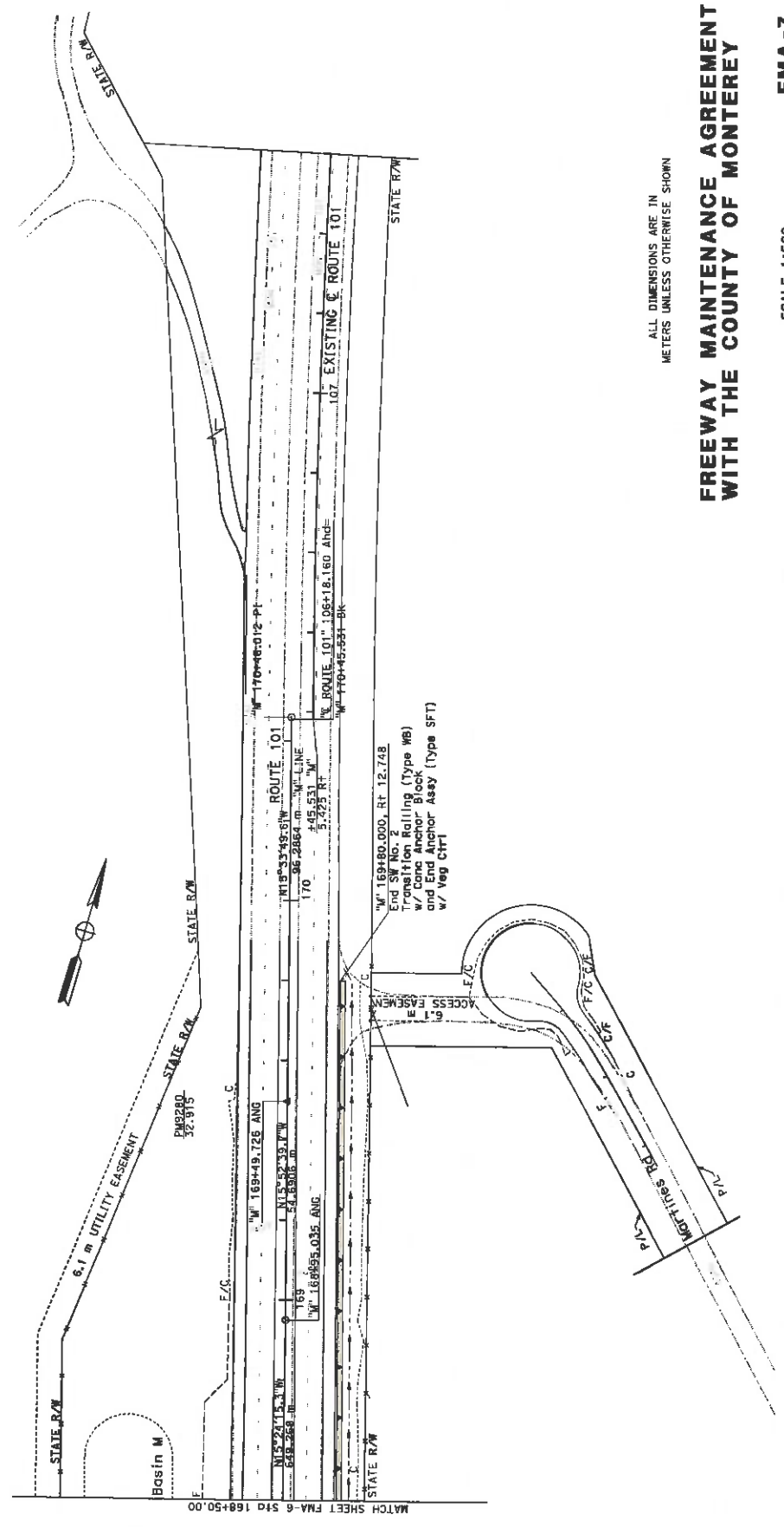

ALL DIMENSIONS ARE IN METERS UNLESS OTHERWISE SHOWN

**FREEWAY MAINTENANCE AGREEMENT WITH THE COUNTY OF MONTEREY**

**FMA-7**

SCALE 1:500

EA 0161E1

CU 06226

USERNAME -> 8171583  
JOB FILE -> 50161E\_1MA12.dgn



RELATIVE BORDER SCALE IS IN MILLIMETERS

BORDER LAST REVISED 3/1/2007

STATE OF CALIFORNIA - DEPARTMENT OF TRANSPORTATION	FUNCTIONAL SUPERVISOR	CALCULATED-DESIGNED BY	REVISIONS
		CHECKED BY	DATE REVISED







Dist	County	Route	Alignment Project No.	SHEET NO.	TOTAL SHEETS
05	Mon	101	R146-B/159.7	9	12



**05-0161E4  
PRUNDALE IMPROVEMENT  
PROJECT**

**LEGEND**

-  COUNTY MAINTAINED AREAS PER FMA
-  COUNTY MAINTAINED ROADWAY PER FMA
-  COUNTY MAINTAINED SHARED CULVERT LINK PER FMA

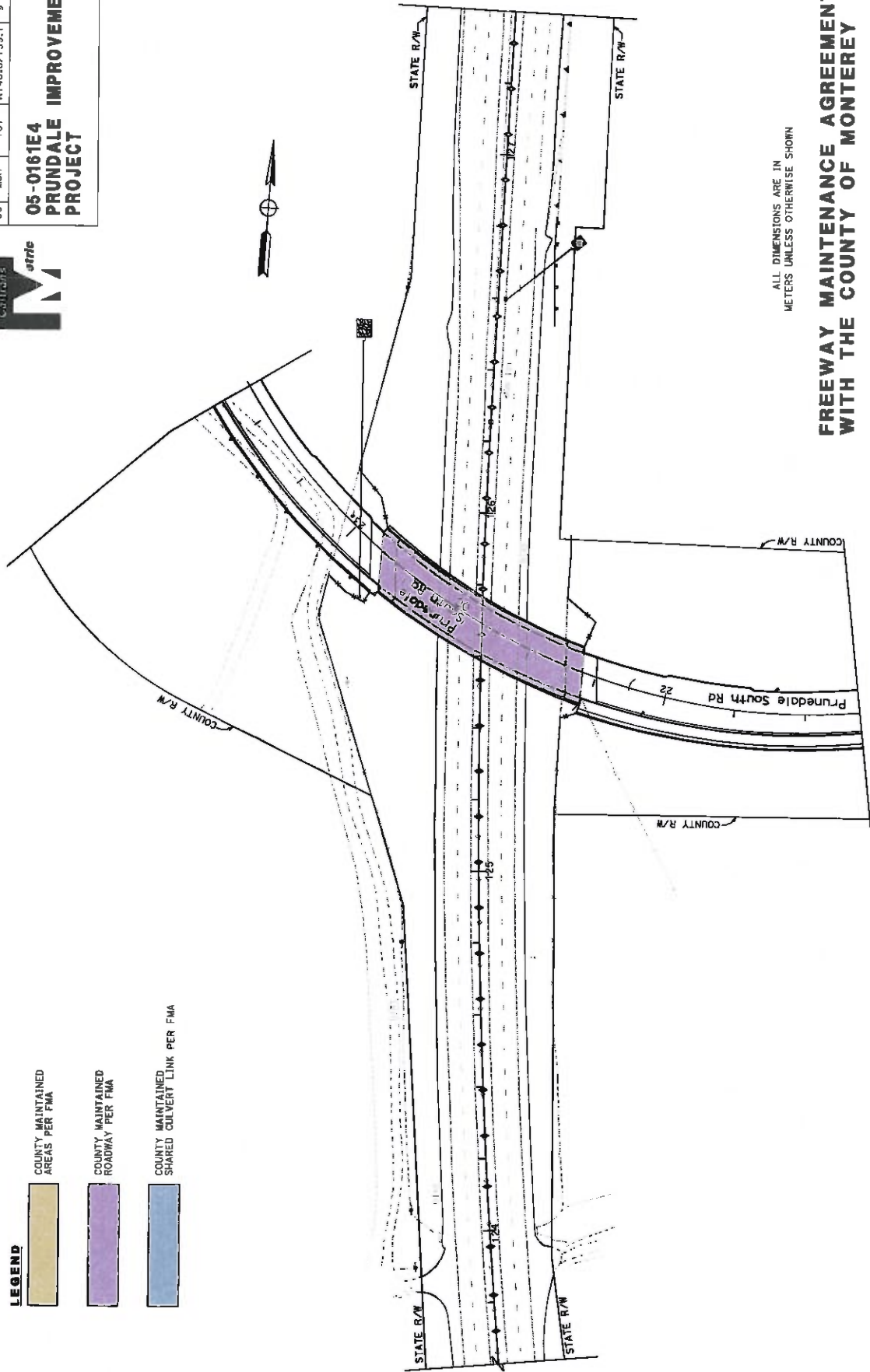

ALL DIMENSIONS ARE IN METERS UNLESS OTHERWISE SHOWN

**FREEWAY MAINTENANCE AGREEMENT WITH THE COUNTY OF MONTEREY**

**FMA - 8**

SCALE 1:500

EA 0161E1

CU 06226

USERNAME => 0161E03  
DWG FILE => 20161E\_FMA15.dwg

RELATIVE BORDER SCALE IS IN MILLIMETERS

BORDER LAST REVISED 3/1/2007

STATE OF CALIFORNIA - DEPARTMENT OF TRANSPORTATION	FUNCTIONAL SUPERVISOR	CHECKED BY	DATE REVISED	REVISOR



DATE	05-09-10	DATE PLOTTED	05-08-2010
LAST REVISION	10	LAST PLOTTED	1410



05-0161E4  
**PRUNDALE IMPROVEMENT PROJECT**

DIST	05	COUNTY	Mon	ROUTE	101	SCALE	R146-B/159-7	SHEET NO.	10	TOTAL SHEETS	12
------	----	--------	-----	-------	-----	-------	--------------	-----------	----	--------------	----

STATE OF CALIFORNIA - DEPARTMENT OF TRANSPORTATION	FUNCTIONAL SUPERVISOR	CHECKED BY	DATE REVISED
		DESIGNED BY	REVISOR

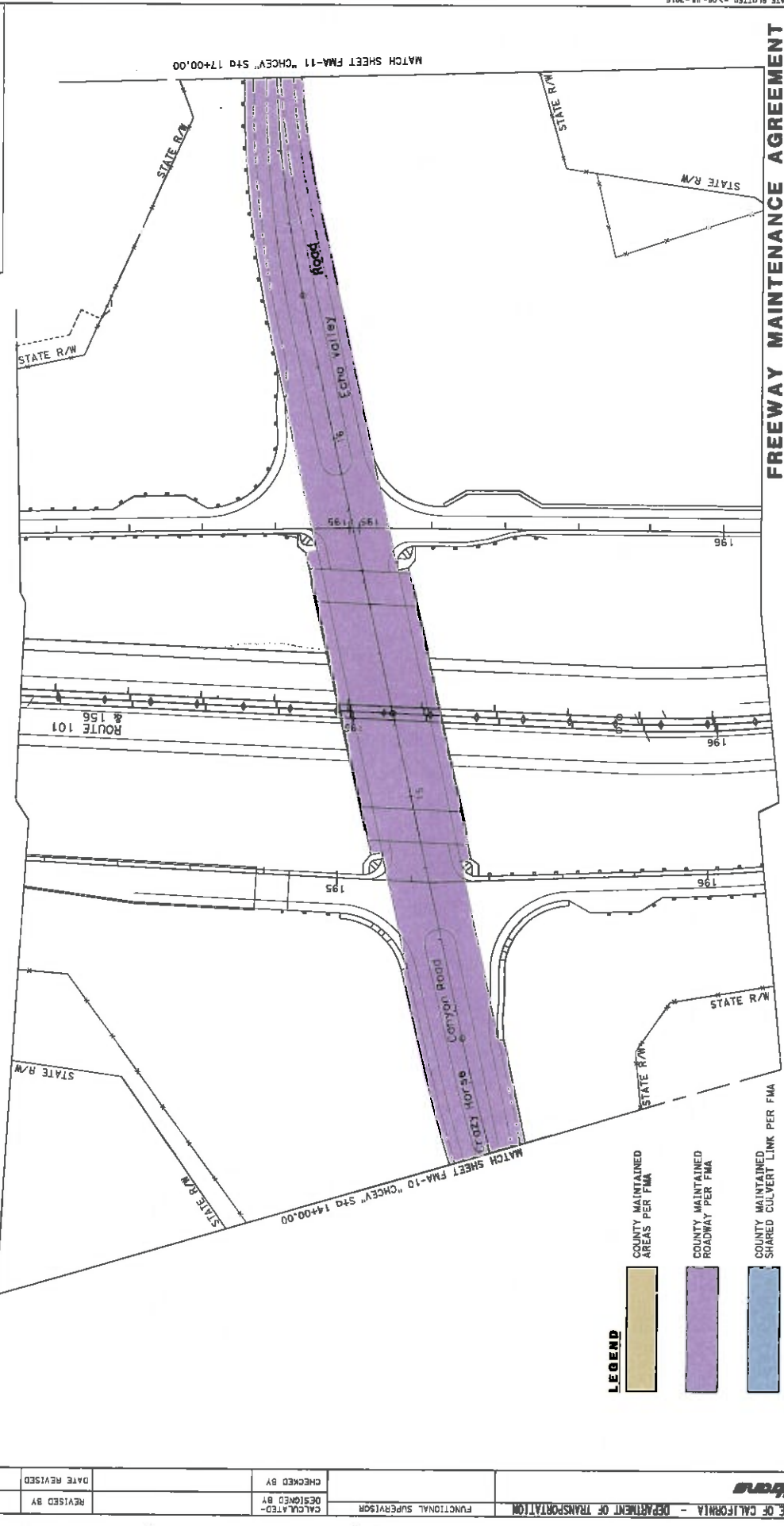

**FREEWAY MAINTENANCE AGREEMENT WITH THE COUNTY OF MONTEREY FMA-9**

SCALE 1:500

ALL DIMENSIONS ARE IN METERS UNLESS OTHERWISE SHOWN

**LEGEND**

- COUNTY MAINTAINED AREAS PER FMA
- COUNTY MAINTAINED ROADWAY PER FMA
- COUNTY MAINTAINED SHARED CULVERT LINK PER FMA

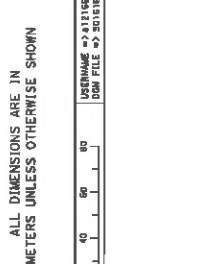

RELATIVE BORDER SCALE IS IN MILLIMETERS

USERNAME -> 0111583  
 JOB FILE -> 2010E.FMA9B.dgn

Dist	County	Route	Balance for Project	Sheet No.	Total Sheets
05	Mon	101	R146-B/159-7	11	12

**05-0161E4  
PRUNDALE IMPROVEMENT  
PROJECT**

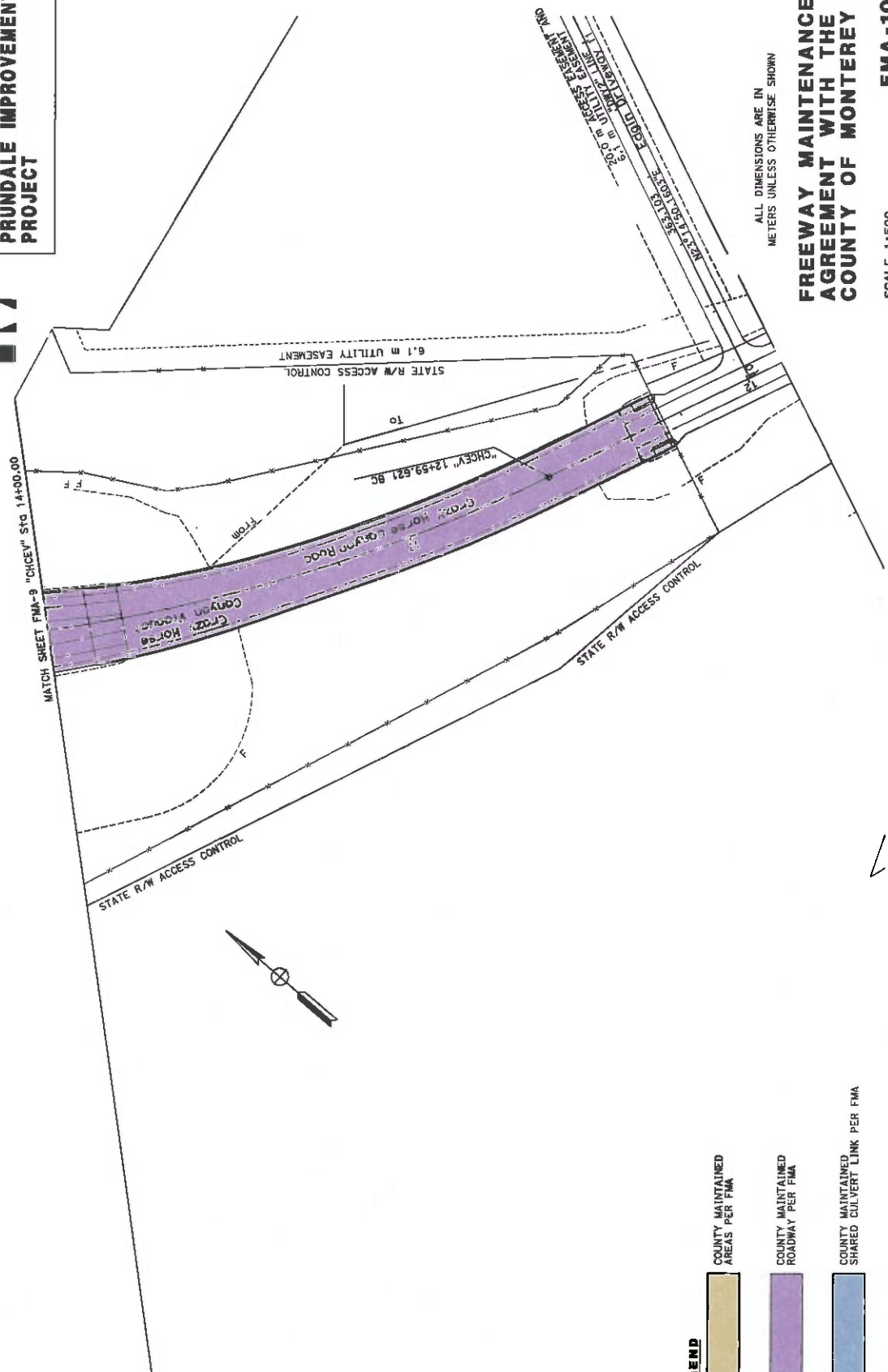

ALL DIMENSIONS ARE IN METERS UNLESS OTHERWISE SHOWN

**FREEWAY MAINTENANCE AGREEMENT WITH THE COUNTY OF MONTEREY**

SCALE 1:500 FMA-10

- LEGEND**
- COUNTY MAINTAINED AREAS PER FMA
  - COUNTY MAINTAINED ROADWAY PER FMA
  - COUNTY MAINTAINED SHARED CULVERT LINK PER FMA

DATE PLOTTED: 06-JUN-2018 05-09-10  
 USER: 0161E4  
 FILE: 05161E.DWG  
 SCALE: 1:500  
 PROJECT: 05-0161E4  
 SHEET: 11 OF 12  
 COUNTY: MONTEREY  
 ROUTE: 101  
 PROJECT: PRUNDALE IMPROVEMENT PROJECT

STATE OF CALIFORNIA - DEPARTMENT OF TRANSPORTATION	FUNCTIONAL SUPERVISOR	DESIGNED BY	REVISIONS
		CHECKED BY	DATE REVISIONS
		DESIGNED BY	REVISIONS
		CHECKED BY	DATE REVISIONS

DIST	COUNTY	ROUTE	ALLOWED PER TOTAL PROJECT	SHEET NO.	TOTAL SHEETS
05	Mon	101	R146.8/198.7	12	12

**05-0161E4  
PRUNDALE IMPROVEMENT  
PROJECT**

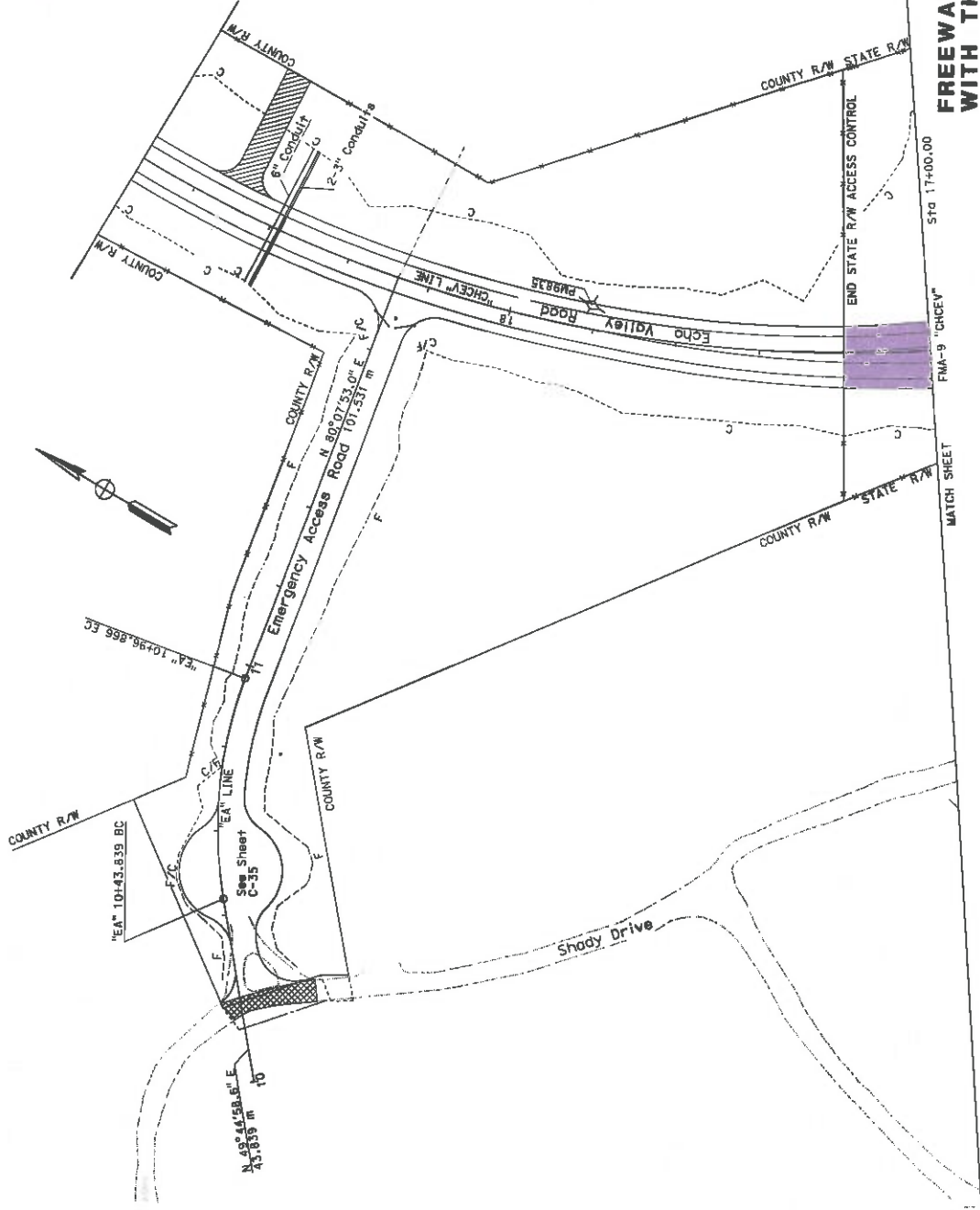

**LEGEND**

- COUNTY MAINTAINED AREAS PER FMA
- COUNTY MAINTAINED ROADWAY PER FMA
- COUNTY MAINTAINED SHARED CULVERTY LINK PER FMA

**FREEWAY MAINTENANCE AGREEMENT  
WITH THE COUNTY OF MONTEREY**

ALL DIMENSIONS ARE IN METERS UNLESS OTHERWISE SHOWN  
SCALE 1:500  
**FMA-11**

CU 06226 EA 0161E1

STATE OF CALIFORNIA - DEPARTMENT OF TRANSPORTATION	FUNCTIONAL SUPERVISOR	CHECKED BY	DATE REVISED
DESIGNED BY	REVISOR	REVISION	