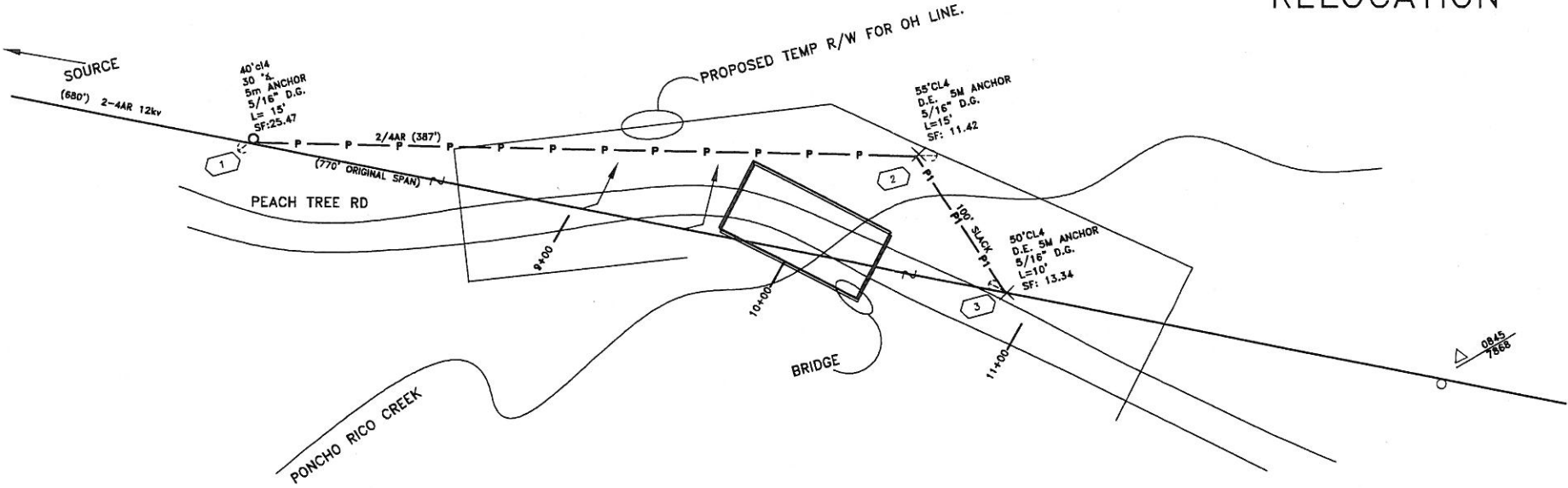

EXHIBIT "A"

RELOCATION - INSTALL



RELOCATION - INSTALL

GO BACK

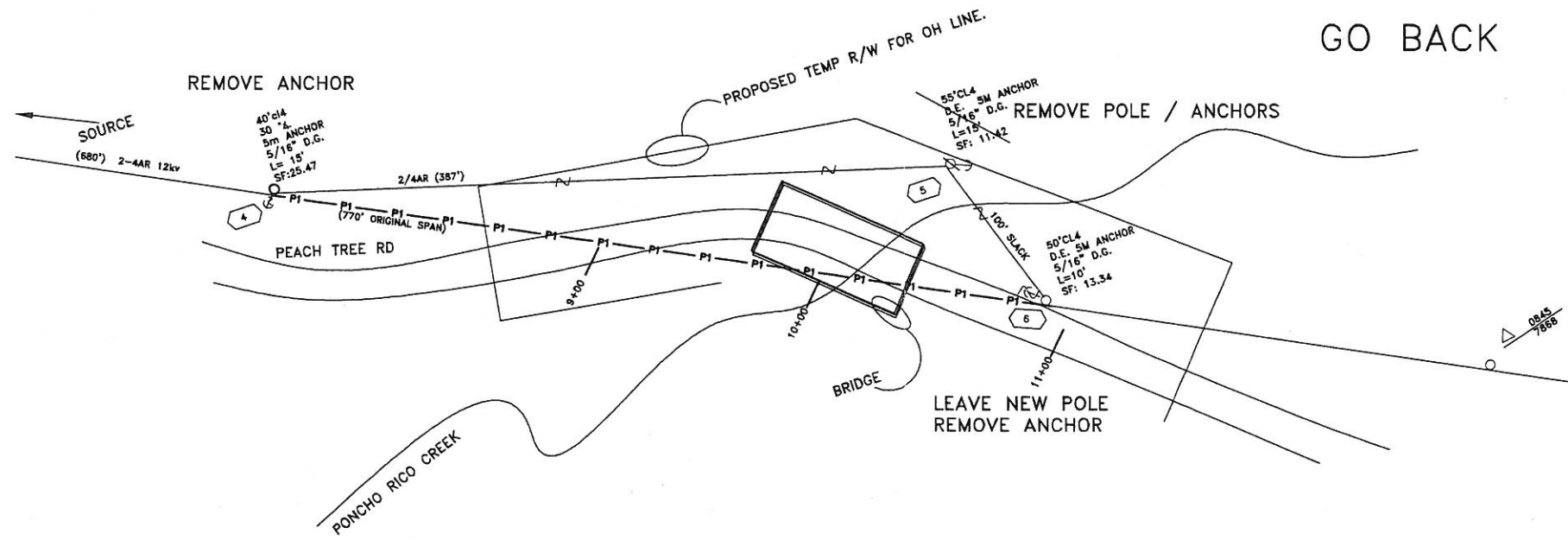

POLE LOCATIONS ARE STAKED IN THE FIELD.
'GO BACK' LOCATIONS - LEAVE POLE AT LOC 3.

SmartMeter™ Network Device

Loc# _____ Device Equ# _____

Install ☐ Remove ☐ Transfer ☐

Latitude _____

Longitude _____

Descriptive Geographic Loc of Device: _____

CONSTRUCTION NOTE:
Please call the SmartMeter™ Ops Center at 1-877-709-7662 to report
SM Network device energized / de-energized.

LEGEND AND NOTES	
JOB PROPOSES TO RELOCATE OH LINE TO CLEAR BRIDGE IMPROVEMENT WORK. RELOCATION IS WRO. AFTER BRIDGE WORK, PGE TO GO BACK TO ORIGINAL ALIGNMENT. NO NEED TO REMOVE POLE AT LOC 3/6.	
11+00	LOC ID ON APPLICANT PLANS, TYPICAL
P1	2-4AR, TRANSFER
P	2-4AR, INSTALL BY PGE
X	POLE, PGE ONLY, W/ D.G. AND ANCHOR

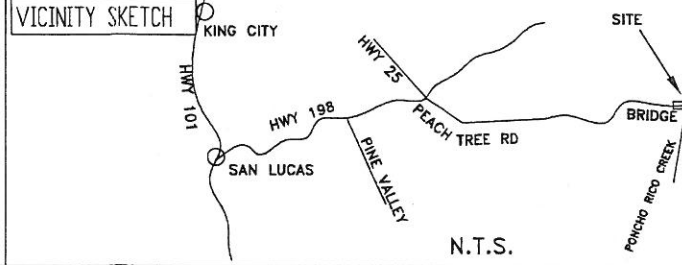

U-34
12KV
SAN ARD 1102
SSD: 7437

CLASS 1 AREA
"A" INSULATION
NON/CORR.

SAFETY PLEDGE
I ALWAYS PUT SAFETY FIRST
I LOOK FOR AND ACT TO
RESOLVE UNSAFE SITUATIONS
I HELP AND ENCOURAGE
OTHERS TO ACT SAFELY.

PEACHTREE ROAD BRIDGE
CO. NO. 412; ST NO. 44C-151
AT PONCHO RICO CREEK
KING CITY

EST: JELD	ENGINEERING AND PLANNING DEPT.
ADE: JELD	401 WORK STREET
SUPV: DWNU	SALINAS
REP: MPCG	PHONE #: 831-784-3614 FAX #: 831-784-3634
PLNR: N/A	PACIFIC GAS AND ELECTRIC COMPANY
SCALE: AS NOTED	DATE: 3-5-2014
DATE: 3-5-2014	REV: 1
DATE: 3-5-2014	REV: 1

CO: 106918498	NOTIF: 106918498
Other: 1/1	SHT: 1/1
PM: 31014920	REV: 1