

COUNTY OF MONTEREY FACILITY SECURITY ASSESSMENT PHASE I  
GOVERNMENT CENTER SECURITY SIGNAGE  
168 W. ALISAL STREET  
SALINAS, CA 93901  
100% CONSTRUCTION DOCUMENTS

2013 California Green Building Standard Code (CGC)  
Non Residential Checklist

Feature or Measure	Yes
SITE DEVELOPMENT (CGC 5.106)	
Short-Term bicycle parking. If the project is anticipated to generate visitor traffic, provide permanently anchored bicycle racks within 200 feet of the visitors' entrance, readily visible to passers-by, for 5 percent of visitor motorized vehicle parking capacity, with a minimum of one two-bike capacity rack per CGC 5.106.4.1.	<input type="checkbox"/>
Long-Term bicycle parking. For buildings with over 10 tenant-occupants, provide secure bicycle parking for 5 percent of tenant-occupied motorized vehicle parking capacity, with a minimum of one space per CGC 5.106.4.2.	<input type="checkbox"/>
Designated parking. Provide designated parking for any combination of low-emitting, fuel-efficient and carpool/van pool vehicles as shown in Table 5.106.5.2.	<input type="checkbox"/>
Light pollution reduction. Comply with lighting power requirements in the California Energy Code and in compliance with CGC 5.106.8.	<input type="checkbox"/>
WATER EFFICIENCY AND CONSERVATION	
INDOOR WATER USE (CGC 5.303)	
Meters. Separate meters shall be installed for the uses described in Sections 503.1.1 through 503.1.2.	
Buildings in excess of 50,000 square feet. Separate submeters shall be installed as follows: 1. For each individual leased, rented or other tenant space within the building projected to consume more than 100 gal/day. 2. For spaces used for laundry or cleaners, restaurant or food service, medical or dental office, laboratory or beauty salon or barber shop projected to consume more than 100 gal/day. Excess consumption. Any building within a project or space within a building that is projected to consume more than 1,000 gal/day.	<input type="checkbox"/> <input type="checkbox"/> <input type="checkbox"/>
20 percent savings. A schedule of plumbing fixtures and fixture fittings that will reduce the overall use of potable water within the building by 20 percent shall be provided per CGC 5.303.2. (Calculate savings by Water Use Worksheets)	<input type="checkbox"/>
Multiple showerheads serving one shower. When single shower fixtures are served by more than one showerhead, the combined flow rate of all the showerheads shall not exceed the maximum flow rates specified in the 20 percent reduction column contained in Table 5.303.2.3 or the shower shall be designed to only allow one showerhead to be in operation at a time (CGC 5.303.2.1).	<input type="checkbox"/>
Wastewater reduction. Each building shall reduce the generation of wastewater by one of the methods per CGC 5.303.4:	<input type="checkbox"/>
Plumbing fixtures and fittings. Plumbing fixtures (water closets and urinals) and fittings (faucets and showerheads) shall comply with the requirements listed for each type in Items listed in Table 5.303.6: 1. Water closets (toilets) – flushometer valve type single or dual flush, maximum flush volume 2. Water closets (toilets) – tank type 3. Urinals, maximum flush volume 4. Urinals, non-water urinals 5. Public lavatory faucets: Maximum flow rate-0.5 gpm 6. Public metering self-closing faucets: Maximum flow rate-0.25 gallon per cycle 7. Residential bathroom lavatory sink faucets: Maximum flow rate-1.5 gpm	<input type="checkbox"/> <input type="checkbox"/> <input type="checkbox"/> <input type="checkbox"/> <input type="checkbox"/> <input type="checkbox"/> <input type="checkbox"/>

OUTDOOR WATER USE (CGC 5.304)	
Water budget. A water budget shall be developed for landscape irrigation use per CGC 5.304.1.	<input type="checkbox"/>
Outdoor potable water use. For new water service, separate meters or submeters shall be installed for indoor and outdoor potable water use for landscaped areas between 1,000 square feet and 5,000 square feet per CGC 5.304.2.	<input type="checkbox"/>
Irrigation design. In new nonresidential projects with between 1,000 and 2,500 square feet of landscaped area (the level at which the MLO applies), install irrigation controllers and sensors which include the following criteria and meet manufacturer's recommendations CGC 5.304.3.	<input type="checkbox"/>
Irrigation controllers. Automatic irrigation system controllers installed at the time of final inspection shall comply with CGC 5.304.3.1.	<input type="checkbox"/>
WEATHER RESISTANCE AND MOISTURE MANAGEMENT (CGC 5.407)	
Weather protection. Provide a weather-resistant exterior wall and foundation envelope as required by California Building Code Section 1403.2 and California Energy Code Section 150, manufacturer's installation instructions or local ordinance, whichever is more stringent.	<input type="checkbox"/>
Moisture control. Employ moisture control measures by the following methods: Sprinklers. Prevent irrigation spray on structures per CGC 5.407.2.1.	<input type="checkbox"/> <input type="checkbox"/>
Entries and openings. Design exterior entries and openings to prevent water intrusion into buildings per CGC 5.407.2.2.	<input type="checkbox"/>
CONSTRUCTION WASTE REDUCTION, DISPOSAL AND RECYCLING (CGC 5.408)	
Construction waste diversion. Comply with the Construction and Demolition Debris Recycling Program.	<input type="checkbox"/>
Verification of compliance. A copy of the completed waste management report shall be provided.	<input type="checkbox"/>
BUILDING MAINTENANCE AND OPERATION (CGC 5.410)	
Recycling by occupants. Provide readily accessible areas that serve the entire building and are identified for the depositing, storage and collection of nonhazardous materials for recycling per CGC 5.410.1.	<input type="checkbox"/>
Commissioning. For new buildings 10,000 square feet and over, building commissioning for all building systems covered by T24, Part 6, process systems and renewable energy systems shall be included in the design and construction processes of the building project. Commissioning requirements shall include items listed in Section 5.410.2.	<input type="checkbox"/>
Commissioning report. A complete report of commissioning process activities undertaken through the design, construction and reporting recommendations for post-construction phases of the building project shall be completed and provided to the owner or representative.	<input type="checkbox"/>
Testing and adjusting. Testing and adjusting of systems shall be required for buildings less than 10,000 square feet per CGC 5.410.4.	<input type="checkbox"/>
Operation and maintenance manual. Provide the building owner with detailed operating and maintenance instructions and copies of guarantees/warranties for each system prior to final inspection per CGC 5.410.4.5.	<input type="checkbox"/>
Inspections and reports. Include a copy of all inspection verifications and reports required by the enforcing agency.	<input type="checkbox"/>
ENVIRONMENTAL QUALITY	
GAS FIREPLACES (CGC 5.503)	
Install only a direct-vent sealed-combustion gas or sealed wood-burning fireplace or a sealed woodstove and refer to residential requirements in the California Energy Code, Title 24, Part 6, Subchapter 7, Section 150.	<input type="checkbox"/>
Woodstoves. Woodstoves shall comply with US EPA Phase II emission limits.	

POLLUTANT CONTROL (CGC 5.504)	
Covering of duct openings and protection of mechanical equipment during construction. At the time of rough installation or during storage on the construction site and until final startup of the heating and cooling equipment, all duct and other related air distribution component openings shall be covered with tape, plastic, sheet metal or other methods acceptable to the enforcing agency to reduce the amount of dust or debris which may collect in the system per CGC 5.504.3.	<input type="checkbox"/>
Finish material pollutant control. Finish materials shall comply with Sections 5.504.4.1 through 5.504.4.4.	<input type="checkbox"/>
Adhesives, sealants, caulks. Adhesives and sealants used on the project shall meet the requirements of the standards listed in CGC 5.504.4.1.	<input type="checkbox"/>
Paints and coatings. Architectural paints and coatings shall comply with Table 5.504.4.3 unless more stringent local limits apply.	<input type="checkbox"/>
Verification. Verification of compliance with this section shall be provided at the request of the enforcing agency.	<input type="checkbox"/>
Carpet systems. All carpet installed in the building interior shall meet the testing and product requirements of one of the standards listed in Section 5.504.4.4.	<input type="checkbox"/>
Composite wood products. Hardwood plywood, particleboard and medium density fiberboard composite wood products used on the interior or exterior of the building shall meet the requirements for formaldehyde as specified in Table 5.504.4.5.	<input type="checkbox"/>
Resilient flooring systems. Comply with the VOC-emission limits defined in the 2009 CHPS criteria and listed on its Low-emitting Materials List (or Product Registry) or certified under the FloorScore program of the Resilient Floor Covering Institute.	<input type="checkbox"/>
Verification of compliance. Documentation shall be provided verifying that resilient flooring materials meet the pollutant emission limits.	<input type="checkbox"/>
Hazardous particulates and chemical pollutants. Minimize and control pollutant entry into buildings and cross-contamination of regularly occupied areas.	<input type="checkbox"/>
Filters. In mechanically ventilated buildings, provide regularly occupied areas of the building with air filtration media for outside and return air prior to occupancy that provides at least a MERV of 8.	<input type="checkbox"/>

Responsible Designer's Declaration Statement	Contractor Declaration Statement
I hereby certify that this project has been designed to meet the requirements of the 2013 California Green Building Standards Code.	I hereby certify, as the builder or installer under permit listed herein, that this project will be constructed to meet the requirements of the California Green Building Standards Code.
Name: BRAD SCHULTZ	Name:
Signature:	Signature:
Date: 12/22/2016	Date:
Company: KITCHELL CEM	License:
Address: 2450 VENTURE OAKS DRIVE, SUITE 500 SACRAMENTO, CA 95833	Address:

SHEET INDEX

GENERAL	COVER SHEET
G001	
ARCHITECTURE	
A100	SITE REFERENCE PLAN
A201	FIRST FLOOR SIGNAGE REFERENCE PLAN
A710	SIGN TYPES

GOVERNMENT CENTER SECURITY SIGNAGE

168 W. ALISAL STREET  
SALINAS, CA 93901

COUNTY OF MONTEREY FACILITY SECURITY  
ASSESSMENT PHASE I

PROJECT SCOPE

THE PROPOSED PROJECT IS INSTALLATION OF EXTERIOR AND INTERIOR SIGNAGE FOR PURPOSE OF COMMUNICATING SECURITY REQUIREMENTS TO THE PUBLIC ON ENTERING MONTEREY COUNTY PROPERTY. THERE IS NO PHYSICAL CHANGE IN THE EXISTING FACILITIES OR USE.

CLIENT CONTACT

COUNTY OF MONTEREY,  
RESOURCE MANAGEMENT AGENCY  
FLORENCE KABWASA-GREEN  
168 W. ALISAL STREET  
SALINAS, CA 93901

CONSULTANT

KITCHELL CEM, INC  
2450 VENTURE OAKS WAY, SUITE 500  
SACRAMENTO, CA 95833  
ARCHITECTURAL, CIVIL, STRUCTURAL, MECHANICAL,  
& ELECTRICAL ENGINEERING  
PH: 916.648.9700  
FAX: 916.648.6534  
PROJECT ARCHITECT: BRAD SCHULTZ, R.A.  
EMAIL: bschultz@kitchell.com



VICINITY MAP  
NTS



LOCATION MAP  
NTS

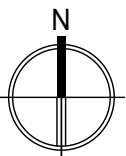

**KITCHELL**

Capital Expenditure Managers  
2450 Venture Oaks Way  
Suite 500  
Sacramento, CA. 95833  
(916) 648-9700

PROJECT STATUS:

100% CONSTRUCTION  
DOCUMENTS

BUILDINGS:

SHEET TITLE:

COVER SHEET

SCALE:



REVISIONS

No.	Description	Date

JOB NO.

6109C2

DATE

12/22/2016

SHEET

G001



LAST REVISION: 2/15/2017 3:57:04 PM

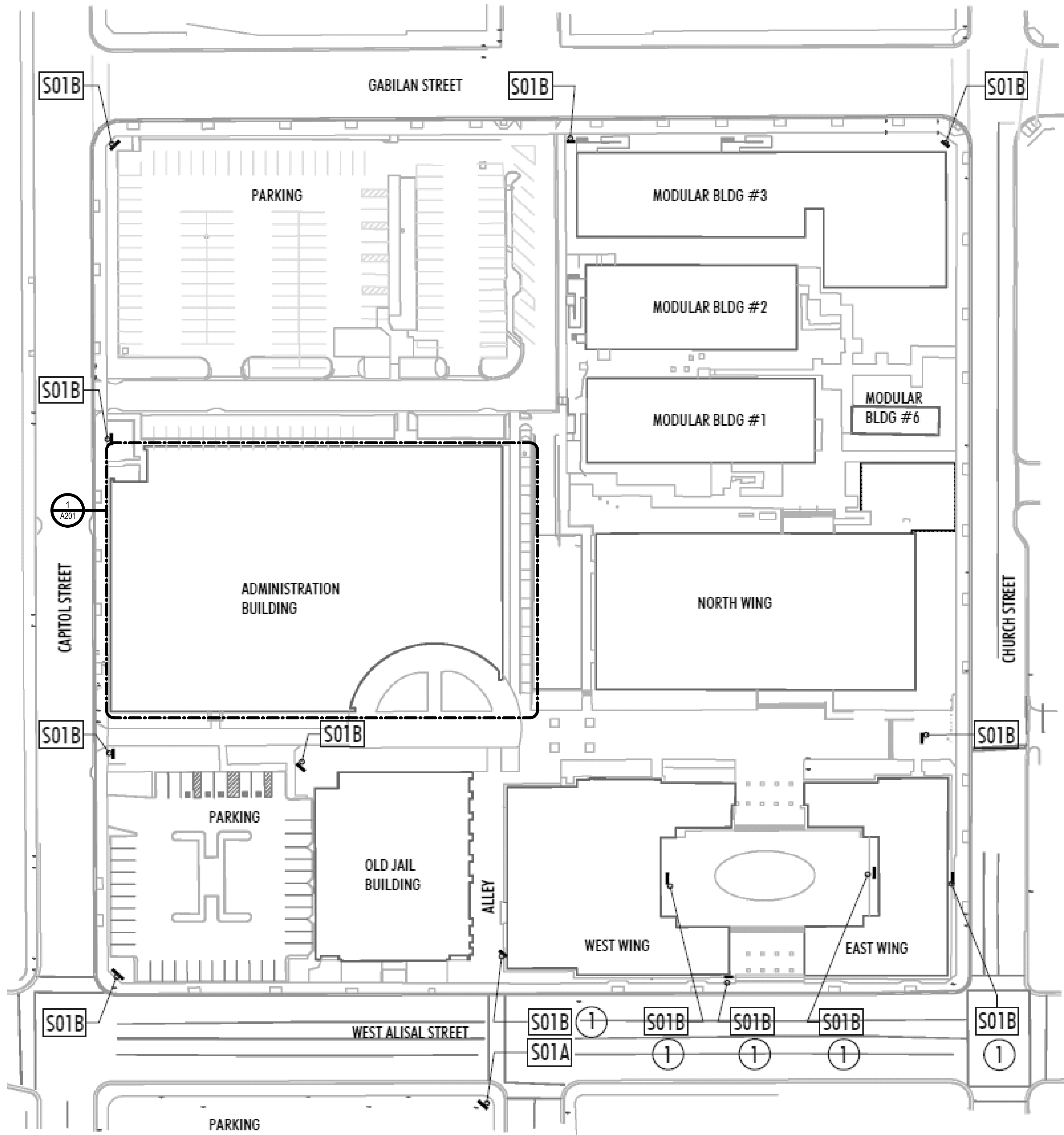

MONTEREY COUNTY GOVERNMENT CENTER SITE REFERENCE  
PLAN  
NTS

**GENERAL NOTE:**

1. REFER TO SHEET A710 FOR SIGNAGE TYPES AND SECTION 101400 FOR SIGN SPECIFICATIONS.

**KEYNOTES:**

1 NOT IN CONTRACT. PROVIDE ALTERNATE PRICE FOR ADDITIONAL SIGNS AT LOCATION SHOWN ON DRAWING.



Capital Expenditure Managers  
2450 Venture Oaks Way  
Suite 500  
Sacramento, CA. 95833  
(916) 648-9700

GOVERNMENT CENTER SECURITY SIGNAGE  
168 W. ALISAL STREET  
SALINAS, CA 93901

COUNTY OF MONTEREY FACILITY SECURITY  
ASSESSMENT PHASE I

PROJECT STATUS:

100% CONSTRUCTION  
DOCUMENTS

BUILDINGS:

SHEET TITLE:

SITE REFERENCE  
PLAN

SCALE: 0 1/2 1  
BAR IS ONE INCH ON ORIGINAL  
DRAWING. IF NOT ONE INCH ON  
THIS SHEET, ADJUST SCALES  
ACCORDINGLY.

**REVISIONS**

No.	Description	Date

JOB NO.

6109C2

DATE

12/22/2016

SHEET

A100

**GENERAL NOTE:**

1. REFER TO SHEET A710 FOR SIGNAGE TYPES AND SECTION 101400 FOR SIGN SPECIFICATIONS.

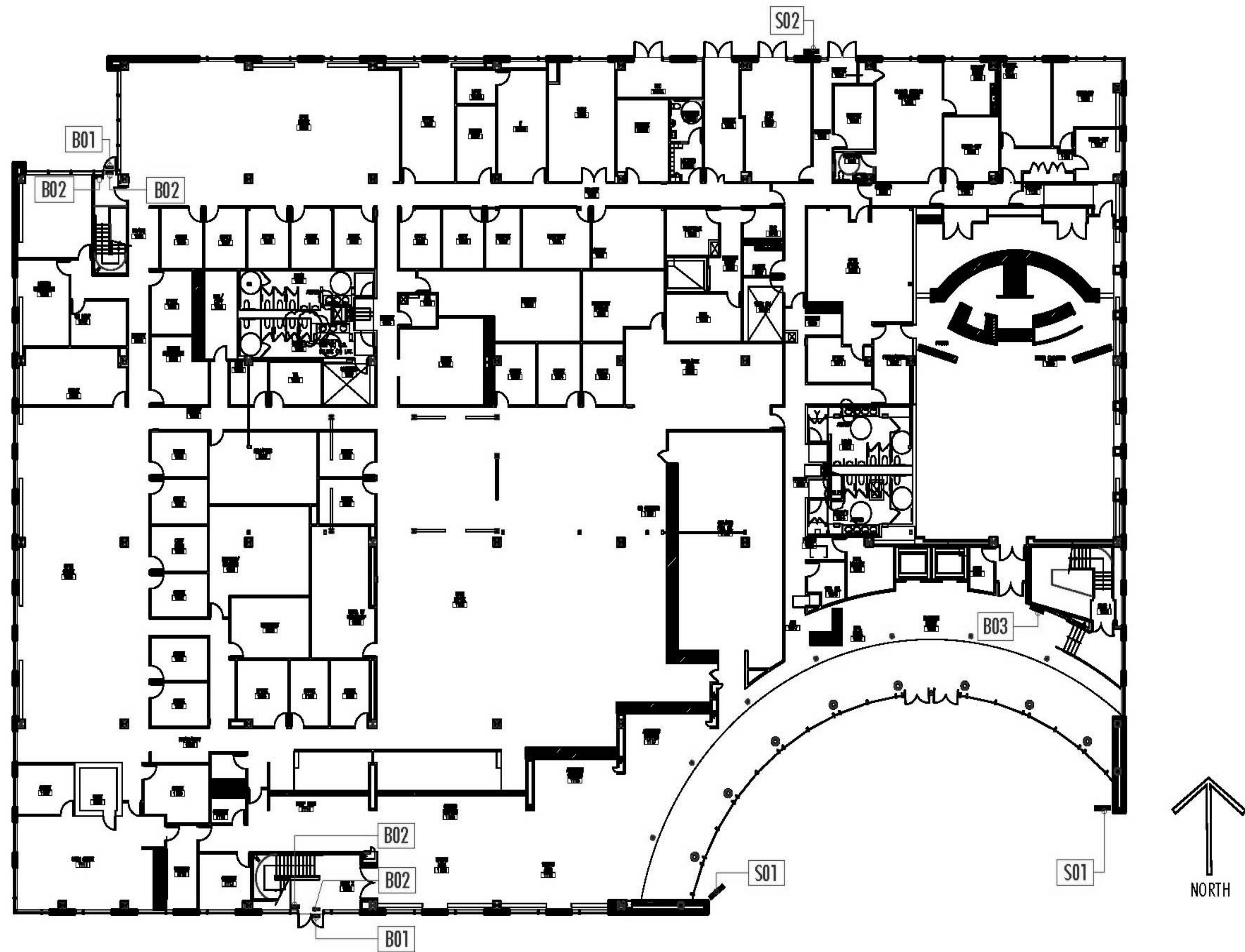

ADMINISTRATION BUILDING FIRST FLOOR SIGNAGE REFERENCE  
1 PLAN  
NTS

GOVERNMENT CENTER SECURITY SIGNAGE  
168 W. ALISAL STREET  
SALINAS, CA 93901

COUNTY OF MONTEREY FACILITY SECURITY  
ASSESSMENT PHASE I

PROJECT STATUS:  
100% CONSTRUCTION  
DOCUMENTS

BUILDINGS:

SHEET TITLE:  
FIRST FLOOR  
SIGNAGE  
REFERENCE PLAN

SCALE: 0 1/2 1  
BAR IS ONE INCH ON ORIGINAL  
DRAWING. IF NOT ONE INCH ON  
THIS SHEET, ADJUST SCALES  
ACCORDINGLY.

REVISIONS		
No.	Description	Date

JOB NO. 6109C2	SHEET <b>A201</b>
DATE 12/22/2016	

