

Exhibit E

This page intentionally left blank.

PC 66-449		DATE SUBMITTED 4/19/87		PERMIT NO. 7 038816 M		AREA 2		CODE 34	
PROPERTY LOCATION									
LOT BLOCK B16 TRACT/SUBD. FOR LOT 13415 Carmel									
STREET ADDRESS ASSIGNOR'S PARCEL NO.									
L 2361 Bay View Avenue									
NAREST CROSS STREET									
Inspiration Avenue									
Carmel									
Robert Holmes									
408-861-6086									
1995 Monte Vista Drive Saratoga, CA 95070									
OWNER/BUILDER									
USE OF STRUCTURE									
SFD Addn./Enlrgm., 2 bdrms, study, 2									
TYPICAL CONSTRUCTION: deck; remainder of SFD									
CONCRETE FOUNDATION									
FOUNDATION									
FLOORING									
CEILING									
WALLS									
ROOFING									
MECHANICAL									
ELECTRICAL									
PLOASTERING									
PAINTING									
LANDSCAPING									
POOL									
OTHER									
NET AREA (sq ft)									
VALUATION									
FEES:									
DUR 61.75									
PLAN CHECK 326.22									
RESOLUTION 506.88									
RECORDING P.C. 60.00									
GRADING									
PLUMBING									
ELECTRICAL									
MECHANICAL									
SPRING WATER FEE 4.48									
PLAN MARKED YES									
TOTAL \$1097.33									
APPLICATION APPROVED BY Paul Abadillo									
NO BUSINESS INSURANCE									
THE ABOVE APPROVAL GRANTS PERMISSION TO DO THE WORK COVERED BY THIS APPLICATION IN ACCORDANCE WITH PLANS AS APPROVED AND AS APPLICABLE COUNTY AND STATE ORDINANCES, REGULATIONS AND LAWS GOVERNING LOCATION, CONSTRUCTION AND OCCUPANCY OF BUILDINGS.									
THIS PERMIT EXPIRES 2 YEARS FROM DATE OF APPROVAL. IF NOT COMPLETED WITHIN 180 DAYS FROM DATE OF APPROVAL, OR IF BEFORE IT IS REOPENED, A RENEWAL FEE MUST BE PAID. AFTER EXPIRATION, THIS PERMIT MUST BE RENEWED BEFORE THE WORK CAN BE COMMENCED AGAIN.									
REQUIRED FOR CLEARANCE									
COASTAL - WAIVED									
GEN PLAN OK DRCG SENT 11/11/87 4/20/87									
BRICK SUBVISION									
HEALTH									
WATER MEAT 7459									
ENFORCEMENTS									
BUILDING INSPECTION									
FIRE DEPT									
OWNER/BUILDER VERIFICATION									
FINANCIAL AGENCY									
BRANCH									
ADDRESS									
NOTICE: STATE LAW PROHIBITS USE OF SOLDIER CONTAINING MORE THAN 10 PERCENT LEAD FOR JOINTS & FITTINGS IN ANY PRIVATE UN-IGOLD POTABLE WATER SUPPLY SYSTEM.									

PC 186/27/86 PC1 86-449

PROPERTY LOCATION: BLOCK B16 TRACT/BLDG. FOR LOT 13815 Carmel Point

STREET (ADD. 255) 2361 Bay View Avenue

NEAREST CROSS STREET Inspiration Avenue

OWNER Robert Holmes

18975 Monte Vista Drive Saratoga, CA 95070

OWNER/Builder

USE OF STRUCTURE SFD Addn./Palm, 2 bdrms, study, 2

NO. OF TOTAL 1341 Deck 2180 of 2000

DATE ISSUED 4/19/87

PERMIT NO. 38815

AREA 2

CODE 434

FRONT	BACK	SIDE	REAR
20	6	6	10

PERMITS: ELECTRICAL, PLUMBING, MECHANICAL, SOAR

FEES: DUE 61.75

PLAN CHECK 326.22

RESIDENTIAL 586.88

CHARGES: P.C. 60.00

TOTAL 1,034.85

APPROVED BY Paul Holmes

NOTES: 1. See Note 1, 2, 3, 4, 5, 6, 7, 8, 9, 10, 11, 12, 13, 14, 15, 16, 17, 18, 19, 20, 21, 22, 23, 24, 25, 26, 27, 28, 29, 30, 31, 32, 33, 34, 35, 36, 37, 38, 39, 40, 41, 42, 43, 44, 45, 46, 47, 48, 49, 50, 51, 52, 53, 54, 55, 56, 57, 58, 59, 60, 61, 62, 63, 64, 65, 66, 67, 68, 69, 70, 71, 72, 73, 74, 75, 76, 77, 78, 79, 80, 81, 82, 83, 84, 85, 86, 87, 88, 89, 90, 91, 92, 93, 94, 95, 96, 97, 98, 99, 100, 101, 102, 103, 104, 105, 106, 107, 108, 109, 110, 111, 112, 113, 114, 115, 116, 117, 118, 119, 120, 121, 122, 123, 124, 125, 126, 127, 128, 129, 130, 131, 132, 133, 134, 135, 136, 137, 138, 139, 140, 141, 142, 143, 144, 145, 146, 147, 148, 149, 150, 151, 152, 153, 154, 155, 156, 157, 158, 159, 160, 161, 162, 163, 164, 165, 166, 167, 168, 169, 170, 171, 172, 173, 174, 175, 176, 177, 178, 179, 180, 181, 182, 183, 184, 185, 186, 187, 188, 189, 190, 191, 192, 193, 194, 195, 196, 197, 198, 199, 200, 201, 202, 203, 204, 205, 206, 207, 208, 209, 210, 211, 212, 213, 214, 215, 216, 217, 218, 219, 220, 221, 222, 223, 224, 225, 226, 227, 228, 229, 230, 231, 232, 233, 234, 235, 236, 237, 238, 239, 240, 241, 242, 243, 244, 245, 246, 247, 248, 249, 250, 251, 252, 253, 254, 255, 256, 257, 258, 259, 260, 261, 262, 263, 264, 265, 266, 267, 268, 269, 270, 271, 272, 273, 274, 275, 276, 277, 278, 279, 280, 281, 282, 283, 284, 285, 286, 287, 288, 289, 290, 291, 292, 293, 294, 295, 296, 297, 298, 299, 300, 301, 302, 303, 304, 305, 306, 307, 308, 309, 310, 311, 312, 313, 314, 315, 316, 317, 318, 319, 320, 321, 322, 323, 324, 325, 326, 327, 328, 329, 330, 331, 332, 333, 334, 335, 336, 337, 338, 339, 340, 341, 342, 343, 344, 345, 346, 347, 348, 349, 350, 351, 352, 353, 354, 355, 356, 357, 358, 359, 360, 361, 362, 363, 364, 365, 366, 367, 368, 369, 370, 371, 372, 373, 374, 375, 376, 377, 378, 379, 380, 381, 382, 383, 384, 385, 386, 387, 388, 389, 390, 391, 392, 393, 394, 395, 396, 397, 398, 399, 400, 401, 402, 403, 404, 405, 406, 407, 408, 409, 410, 411, 412, 413, 414, 415, 416, 417, 418, 419, 420, 421, 422, 423, 424, 425, 426, 427, 428, 429, 430, 431, 432, 433, 434, 435, 436, 437, 438, 439, 440, 441, 442, 443, 444, 445, 446, 447, 448, 449, 450, 451, 452, 453, 454, 455, 456, 457, 458, 459, 460, 461, 462, 463, 464, 465, 466, 467, 468, 469, 470, 471, 472, 473, 474, 475, 476, 477, 478, 479, 480, 481, 482, 483, 484, 485, 486, 487, 488, 489, 490, 491, 492, 493, 494, 495, 496, 497, 498, 499, 500, 501, 502, 503, 504, 505, 506, 507, 508, 509, 510, 511, 512, 513, 514, 515, 516, 517, 518, 519, 520, 521, 522, 523, 524, 525, 526, 527, 528, 529, 530, 531, 532, 533, 534, 535, 536, 537, 538, 539, 540, 541, 542, 543, 544, 545, 546, 547, 548, 549, 550, 551, 552, 553, 554, 555, 556, 557, 558, 559, 560, 561, 562, 563, 564, 565, 566, 567, 568, 569, 570, 571, 572, 573, 574, 575, 576, 577, 578, 579, 580, 581, 582, 583, 584, 585, 586, 587, 588, 589, 590, 591, 592, 593, 594, 595, 596, 597, 598, 599, 600, 601, 602, 603, 604, 605, 606, 607, 608, 609, 610, 611, 612, 613, 614, 615, 616, 617, 618, 619, 620, 621, 622, 623, 624, 625, 626, 627, 628, 629, 630, 631, 632, 633, 634, 635, 636, 637, 638, 639, 640, 641, 642, 643, 644, 645, 646, 647, 648, 649, 650, 651, 652, 653, 654, 655, 656, 657, 658, 659, 660, 661, 662, 663, 664, 665, 666, 667, 668, 669, 670, 671, 672, 673, 674, 675, 676, 677, 678, 679, 680, 681, 682, 683, 684, 685, 686, 687, 688, 689, 690, 691, 692, 693, 694, 695, 696, 697, 698, 699, 700, 701, 702, 703, 704, 705, 706, 707, 708, 709, 710, 711, 712, 713, 714, 715, 716, 717, 718, 719, 720, 721, 722, 723, 724, 725, 726, 727, 728, 729, 730, 731, 732, 733, 734, 735, 736, 737, 738, 739, 740, 741, 742, 743, 744, 745, 746, 747, 748, 749, 750, 751, 752, 753, 754, 755, 756, 757, 758, 759, 760, 761, 762, 763, 764, 765, 766, 767, 768, 769, 770, 771, 772, 773, 774, 775, 776, 777, 778, 779, 780, 781, 782, 783, 784, 785, 786, 787, 788, 789, 790, 791, 792, 793, 794, 795, 796, 797, 798, 799, 800, 801, 802, 803, 804, 805, 806, 807, 808, 809, 810, 811, 812, 813, 814, 815, 816, 817, 818, 819, 820, 821, 822, 823, 824, 825, 826, 827, 828, 829, 830, 831, 832, 833, 834, 835, 836, 837, 838, 839, 840, 841, 842, 843, 844, 845, 846, 847, 848, 849, 850, 851, 852, 853, 854, 855, 856, 857, 858, 859, 860, 861, 862, 863, 864, 865, 866, 867, 868, 869, 870, 871, 872, 873, 874, 875, 876, 877, 878, 879, 880, 881, 882, 883, 884, 885, 886, 887, 888, 889, 890, 891, 892, 893, 894, 895, 896, 897, 898, 899, 900, 901, 902, 903, 904, 905, 906, 907, 908, 909, 910, 911, 912, 913, 914, 915, 916, 917, 918, 919, 920, 921, 922, 923, 924, 925, 926, 927, 928, 929, 930, 931, 932, 933, 934, 935, 936, 937, 938, 939, 940, 941, 942, 943, 944, 945, 946, 947, 948, 949, 950, 951, 952, 953, 954, 955, 956, 957, 958, 959, 960, 961, 962, 963, 964, 965, 966, 967, 968, 969, 970, 971, 972, 973, 974, 975, 976, 977, 978, 979, 980, 981, 982, 983, 984, 985, 986, 987, 988, 989, 990, 991, 992, 993, 994, 995, 996, 997, 998, 999, 1000

2/8/88

Prans

- OK - Remove debris behind retaining wall. backfill to be per inspection. OK
- OK - Provide surveyor's report on setbacks. OK
- OK - Nail siding 6" o.c. (not 4" o.c.)
- OK - Bolt ext. post (no corner) at top & bottom.
- OK - Flood waste & copper lines to roof.
- OK - Stairs to have 6'-0" headroom.
- OK - Spiral stairs & subpanel feeder not in yet.
- OK - Complete ductwork & remove underfloor.
- OK - Near chimney pipe not installed yet.
- OK - Firestop walls & shafts throughout bldg.
- OK - 1" clear used to 8-vent & attic.
- OK - Hangers required at ridge to rafters.
- OK - Typical det. sheet 9 requires ply shear.
- OK - Provide 4 x 6 spiral stairs for header.
- OK - Water heater pop off to go outside.
- OK - Fluorescent lights required in kitchen.
- OK - Scrap splice in plates. N.R.

Progress as noted above - 2/8/88

Ins for upstairs & roof OK 2/10/88

Note: waste lines & sewage ejector not installed at this time

- OK - Paint ABS roof vents.
- OK - Closet lights need lens.
- OK - Finish nailing dock board's (upper).
- OK - Kitchen sink under supply valve - leak.
- OK - No hub band at sewer under bathroom by bridge leaking.
- OK - Anchor threshold to utility room.
- OK - Weather strip all doors from storage to lvg space.
- OK - Turn eye connection seal at furnace.
- OK - Need hand rail from up to downstairs (2nd floor).
- OK - Finish tile at fireplace chase.
- OK - Recept. needed at kitchen island.
- OK - This is not a final inspection, too many items. N.R.

Need 2-11

1. Insulate under bath area for final

OK 2/11/88

10/11/88

36816-1M

BLOCK B19

17

15

13

DRIVEWAY

COTTAGE
FLOOR
ELEV.
34.7

GARAGE
UNDER
RIDGE ELEV.
54.9
FLOOR ELEV.
41.1
CAR
PORT

BAY VIEW AVE

NEILL ENGINEERS, Inc.	
Consulting Engineers	
CARMEL	MONTREY
ELEVATION SURVEY	
PORTION OF LOTS 13 & 15, BLOCK B-16	
CARMEL POINT	
FOR PAT HENDERSON	
DATE 5-11-56 W.O. 5619 SCALE 1" = 20'	<i>Clayton B. Neill</i> Registered Civil Engineer R.C.E. 12345

[illegible]

MONTEREY COUNTY BUILDING INSPECTION DEPARTMENT

PC 12/30/87 PC# 87-906

PROPERTY LOCATION: 4th St PERMIT NO. 40390 AREA 2 CODE 329

STREET (A - ADDRESS) Block B16 TRACT/SECTION Portion Lot 13615 Carmel Point ASSESSOR'S PARCEL NO. 40390

2361 Bay View Avenue POST OFFICE 009-422-06 CITY Carmel

NEAREST CROSS STREET Inspiration Ave 408 PHONE 492-6535

OWNER Robert Holmes CITY San Jose PHONE 492-6535

MAILING ADDRESS 18975 Monte Vista Drive CITY San Jose PHONE 492-6535

ARCHITECT OR ENGINEER Robert Holmes CITY San Jose PHONE 492-6535

CONTRACTOR Owner/Builder CITY San Jose PHONE 678-5722

USE OF STRUCTURE Replacing Ret. Wall

TYPE OF IMPROVEMENT: ☐ SOLAR ☐ PLUMBING ☐ MECH ☐ ELEC ☐ GRADING ☐ EX. TDS

☒ REPAIR ☐ REMODEL ☐ ADD TO ☐ REPAIR ☐ REPAIR ☐ REPAIR ☐ REPAIR

SIZE: 74 FT. NO. OF STORIES 1 NO. OF FAMILIES 1

Order 176

DATE ISSUED: PERMIT NO. 40390 AREA 2 CODE 329

SET BACKS (IN FEET): FRONT 1.056 SIDE 1.056 REAR 1.056

FEE: 1.056

PLAN CHECK 16.25

RESIDENTIAL 25.00

COMMERCIAL

GRADING

PLUMBING

ELECTRICAL

MECHANICAL 50.00

STRONG MOTION FEE

PLAN MARK. FEE

TOTAL \$

APPLICATION APPROVED BY Paul [Signature] FOR BUILDING INSPECTOR

☐ CATEGORICALLY EXEMPT

☐ ASSESSMENT REQ'D

☐ NEG. DEC. ADOPTED

☐ CERTIFIED ENR REV.

OTHER PERMITS	PERMIT NUMBER	FEE
POWER POLE		
GRADING		
PLUMBING		
ELECTRICAL		
MECHANICAL		
SOLAR		

OFFICE RECORD OF INSPECTIONS

BUILDING	ELECTRICAL	PLUMBING	PLASTERING
FOUNDATION FORMS	TEMPORARY SERVICE	ROUGH PLUMBING	LATH EXTERIOR
JANAGE FORMS	UNDERGROUND OR		LATH INTERIOR
CONCRETE SLAB FLOOR	UNDER CONCRETE	ROUGH HEATING	LATH SHOWER & TUB
CONCRETE BLOCKS	ROUGH ELECTRIC	GAS PRESSURE	SHIRT ROCK NAILING
	ELECT. SERVICE		FIRE SEPARATION
	FINAL ELECTRIC	SEWER	SCRATCH
ROOF SHEATHING		FINAL PLUMBING	
UNDERFLOOR FRAMING	ELECTRIC METER AUTH.	FINAL HEATING	OTHER
FRAMING	PO & T CALLED	FINAL GAS	ALTER
INSULATION		SEPTIC TANK	REPAIR
DOORING		GAS METER AUTH.	MOVE
REPLACE FOUNDATION		PO & T CALLED	GRADING
WROAT/DAMPER			
CONDUCTION AIR			
CHIMNEY			
ENCROACHMENT			
OK TO OCCUPY	DATE	FINAL INSPECTION	DATE
OWNER	GENERAL CONTRACTOR	PROPERTY FILE NO.	DATE
Holmes, Robert	Owner/Builder	40390	

#40390 M

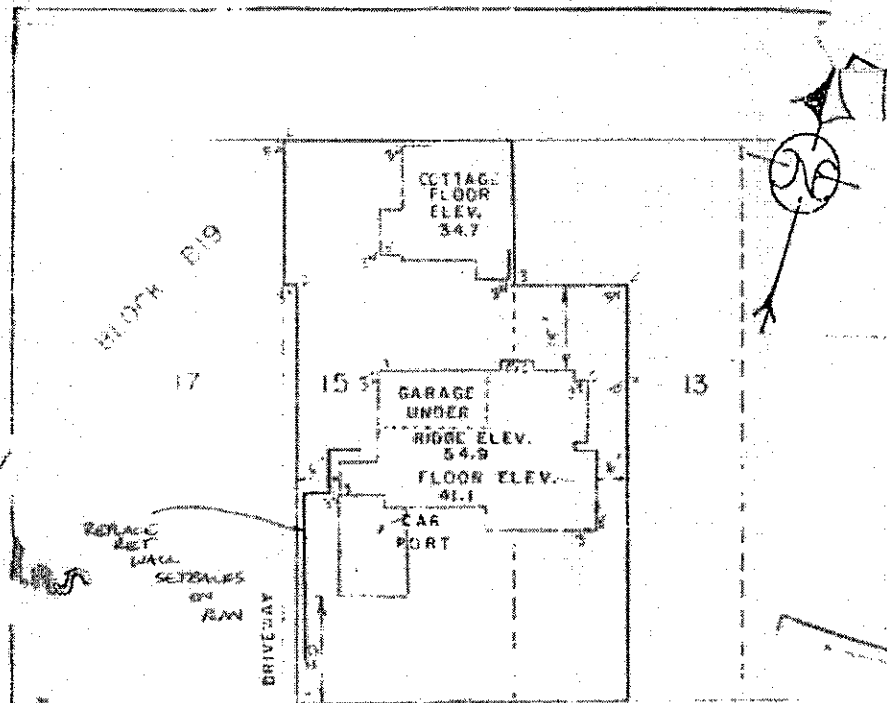

BAY VIEW AVE

2300 BAY VIEW AVE
CARMEL, CA
TEL. 425-422-26

NEILL ENGINEERS, INC.		
Consulting Engineers		
CARMEL		MONTEREY
ELEVATION SURVEY		
PORTION OF LOTS 13 & 15, BLOCK 6-16		
CARMEL POINT		

MONTREY COUNTY BUILDING INSPECTION DEPARTMENT			
PC 06/28/89		PCM 89-476	
PROPERTY LOCATION LOT 13814 MOCC B16 TRACT 5.00 Lateral by the Sea STREET ADDRESS: 2361 Bayview Avenue ASSessor's PARCEL NO. 009-422-06 NEAREST CROSS STREET: Martin Way OWNER: Patricia Felix MAILING ADDRESS: 2361 Bayview Avenue, Carmel, CA 93923 ARCHITECT OR ENGINEER: Seger & Kitchens & Baths 624-6667 CONTRACTOR: <i>La Page</i> 373-7440 REMOVALS: <i>Removals</i> 654-2272			
DATE ISSUED	PERMIT NO.	AREA	CODE
10/11/89	042526 42526	2	434
SETBACKS ON LOT FRONT: SIDE: REAR:		FEES 45,000	
APPROVALS BLDG. TYPE: <i>MOD. 2.0</i> PERMIT TYPE: <i>PC-71195</i> BP-73544		PLAN CHECK: 310.38 RESIDENTIAL: 477.50 COMMERCIAL: GRADING: PLUMBING: ELECTRICAL: MECHANICAL: STRONG MOTION: 3.19 PLAN MARK: 10 TOTAL: 791.03	
<input type="checkbox"/> CATEGORICALLY EXEMPT <input type="checkbox"/> ASSESSMENT REQ'D <input type="checkbox"/> MAG. DEC. ASSIGNED <input type="checkbox"/> CERTIFIED FOR REV.			
APPLICATION APPROVED BY <i>[Signature]</i>			
THE ABOVE APPROVAL GRANTS PERMISSION TO DO THE WORK COVERED BY THIS APPLICATION IN ACCORDANCE WITH PLANS AS APPROVED AND ALL APPLICABLE COUNTY AND STATE ORDINANCES, REGULATIONS AND LAWS GOVERNING LOCALITY, CONSTRUCTION AND OCCUPANCY OF BUILDING.			
EXPIRATION OF PERMIT THIS PERMIT EXPIRES IF THE BUILDING OR WORK AUTHORIZED HEREIN IS NOT COMMENCED WITHIN 180 DAYS FROM DATE OF APPROVAL. THE PERMIT IS SUSPENDED FOR A PERIOD OF 180 DAYS OR ABANDONED, AFTER EXPIRATION, THIS PERMIT MUST BE RENEWED BEFORE THE WORK MAY BE COMMENCED.			
LICENSED CONTRACTOR'S DECLARATION I hereby declare that I am licensed under the provisions of Chapter 9 of the Business and Professions Code, and I am duly licensed under the provisions of Chapter 9 of the Business and Professions Code.		REQUIRED FOR CLEARANCE 10/12/89	
OWNER-BUILDER DECLARATION I hereby declare that I am exempt from the provisions of Chapter 9 of the Business and Professions Code, and I am duly licensed under the provisions of Chapter 9 of the Business and Professions Code.		WORKS COMPLETED SEWER WTR/MOT 10779 06/19/86	
WORKERS COMPENSATION DECLARATION I hereby declare that I have a certificate of workers compensation insurance, or a certificate of workers compensation insurance, or a certificate of workers compensation insurance, or a certificate of workers compensation insurance.		INSPECTION N/A	
CERTIFICATE OF EXEMPTION FROM WORKERS COMPENSATION INSURANCE I hereby declare that I am exempt from the provisions of Chapter 9 of the Business and Professions Code, and I am duly licensed under the provisions of Chapter 9 of the Business and Professions Code.		PHOTOS REQUIRED N/A	
NOTICE TO APPLICANT The applicant is hereby notified that the permit is not valid unless the applicant has obtained a certificate of workers compensation insurance, or a certificate of workers compensation insurance, or a certificate of workers compensation insurance, or a certificate of workers compensation insurance.		FIRE N/A	
CHOOSE BUILDING VERIFICATION YES NO		CHOOSE BUILDING VERIFICATION YES NO	
CHOOSE BUILDING VERIFICATION YES NO		CHOOSE BUILDING VERIFICATION YES NO	

MONTEREY COUNTY BUILDING INSPECTION DEPARTMENT

PC 06/20/89 PCN 89-476

PROPERTY LOCATION: 13814 BLOCK B16 TRACT/SUBD Carmel by the Sea

2361 Bayview Avenue 009-422-06

Martin Way

Patricia Falis 26-8713

2361 Bayview Avenue Carmel, CA 93923

Sege's Kitchens & Baths 624-4667

LePage Construction 373-2440

RENOVATION 659-2272 373-7440

SFD Remodel/Kit, bathw, ext. windows; Add French Doors

OTHER PERMITS: PLASTERING, PLUMBING, ELECTRICAL, MECHANICAL, ROOFING, FLOORING, PAINTING, etc.

OFFICE RECORD OF INSPECTIONS

BUILDING	ELECTRICAL	PLUMBING	PLASTERING
FOUNDATION FORMS	TEMPORARY SERVICE	ROUGH PLUMBING	LATH/EXTERIOR
BRIDGE FORMS	UNDERGROUND C&S	ROUGH HEATING	LATH/INTERIOR
CONCRETE SLAB FLOOR	UNDER CONCRETE	GAS PRESSURE	LATH/INTERIOR & TUB
CONCRETE BLOCKS	ROUGH ELECTRIC	SEWER	SHEET ROCK HANGING
	ELECT SERVICE	FINAL PLUMBING	ADD SHOWER/STATION
	FINAL ELECTRIC	FINAL HEATING	SCRATCH
JOE SHEATHING	ELECTRIC METER AUTHZ	FINAL GAS	OTHER
1ST FLOOR FRAMING	POSS CALLED	SEPTIC TANK	ALTER
CEILING		GAS METER AUTHZ	REPAIR
ROOFING		PO & E CALLED	MOVE
REPLACE FOUNDATION			CRACKING
WIND-UP/GARAGE			
CHIMNEY			
SCROPEMENT			

OK TO OCCUPY DATE 7-12-90

OWNER: Felix, Patricia GENERAL CONTRACTOR: LePage Const

PROPERTY FILE NO: SFD remodel DATE: 10-19-89 PERMIT NO: 42526

3/27/90 DG

1. Submit plan revision for deck railing detail.
2. Pay re-inspection fee.

3/26/90 DG

FRAME INSPECTION, NEED PLANS FOR INSPECTION. RESCHEDULE.

6/18/90

1. Minimum guard rail height is 36" in. Top strip added. *Tu*
2. ~~In garage where vacuum is installed plastic pipes are not to penetrate floor.~~
NOT PART OF GARAGE JOB.

~~Weatherstrip doors.~~
Finish stops at end of deck.

7/12/90 TM

1. Receptacle at sink near refrigerator is not working.
2. Plans do not show cook top I'll check the planning condition.

[illegible]

MONTEREY COUNTY BUILDING INSPECTION DEPARTMENT																																																																							
DATE ISSUED	PERMIT NO.	AREA	CODE																																																																				
10/1/89	42527	2	434																																																																				
PG 06/28/89 PG 89-176 PROPERTY LOCATION 013815 Block D16 Tract/Block Carmel by the Sea STREET ADDRESS 2361 Bayview Avenue ASSUMED'S PARCEL NO. 2361 Bayview Avenue 002-422-06 NEAREST CROSS STREET POST OFFICE Martin Way Carmel OWNER Patricia Felix CITY 2361 Bayview Avenue Carmel, CA 93921 ARCHITECT OR ENGINEER PHONE Seeger Kitchens & Baths 624-4667 CONTRACTOR LePage Construction 332-2444 REMOVED 659-2278 273-7440 TYPE OF STRUCTURE Remodel Guest House/Bath & Bar Area TYPE OF IMPROVEMENT <input type="checkbox"/> ROOF <input type="checkbox"/> FLOORING <input type="checkbox"/> W.C. <input type="checkbox"/> MECH. <input type="checkbox"/> PLUMBING <input type="checkbox"/> E.C. <input type="checkbox"/> PAINT <input type="checkbox"/> EXTERIOR <input type="checkbox"/> INTERIOR <input type="checkbox"/> OTHER NO. OF ROOMS NO. OF PARCELS 1 1 OTHER PERMITS PERMIT NUMBER FEE POWER POLE PLUMBING ELECTRICAL MECHANICAL SOLAR OFFICE RECORD OF INSPECTIONS <table border="1"> <thead> <tr> <th>BUILDINGS</th> <th>ELECTRICAL</th> <th>PLUMBING</th> <th>PLASTERING</th> </tr> </thead> <tbody> <tr> <td>FOUNDATION FORMS</td> <td>TEMPORARY SERVICE</td> <td>ROUGH PLUMBING</td> <td>LATH-EXTERIOR</td> </tr> <tr> <td>LARGE ROOMS</td> <td>UNDERGROUND OR</td> <td>ROUGH HEATING</td> <td>LATH-INTERIOR</td> </tr> <tr> <td>CONCRETE SLAB FLOOR</td> <td>UNDER CONCRETE</td> <td>GAS PRESSURE</td> <td>LATH-SHOWER & T.B.</td> </tr> <tr> <td>CONCRETE BLOCKS</td> <td>ROUGH ELECTRIC</td> <td>SEWER</td> <td>SHIRT BODY MAKING</td> </tr> <tr> <td></td> <td>ELECT. SERVICE</td> <td>FINAL PLUMBING</td> <td>FIRE SEPARATION</td> </tr> <tr> <td></td> <td>FINAL ELECTRIC</td> <td>FINAL HEATING</td> <td>SCRATCH</td> </tr> <tr> <td>ROOF SHEATHING</td> <td>ELECTRIC METER AUTH.</td> <td>FINAL GAS</td> <td>OTHER</td> </tr> <tr> <td>UNDERFLOOR FRAMING</td> <td>POLE CALLED</td> <td>SEPTIC TANK</td> <td>ALTER</td> </tr> <tr> <td>SHADING</td> <td></td> <td>GAS METER AUTH.</td> <td>REPAIR</td> </tr> <tr> <td>GLAZING</td> <td></td> <td>PG & E CALLED</td> <td>MOVE</td> </tr> <tr> <td>DOORING</td> <td></td> <td></td> <td>GRADING</td> </tr> <tr> <td>REPLACE FOUNDATION</td> <td></td> <td></td> <td></td> </tr> <tr> <td>HEAT/DAMPERS</td> <td></td> <td></td> <td></td> </tr> <tr> <td>COMBUSTION AIR</td> <td></td> <td></td> <td></td> </tr> <tr> <td>CHIMNEY</td> <td></td> <td></td> <td></td> </tr> <tr> <td>MECHANICAL</td> <td></td> <td></td> <td></td> </tr> </tbody> </table>				BUILDINGS	ELECTRICAL	PLUMBING	PLASTERING	FOUNDATION FORMS	TEMPORARY SERVICE	ROUGH PLUMBING	LATH-EXTERIOR	LARGE ROOMS	UNDERGROUND OR	ROUGH HEATING	LATH-INTERIOR	CONCRETE SLAB FLOOR	UNDER CONCRETE	GAS PRESSURE	LATH-SHOWER & T.B.	CONCRETE BLOCKS	ROUGH ELECTRIC	SEWER	SHIRT BODY MAKING		ELECT. SERVICE	FINAL PLUMBING	FIRE SEPARATION		FINAL ELECTRIC	FINAL HEATING	SCRATCH	ROOF SHEATHING	ELECTRIC METER AUTH.	FINAL GAS	OTHER	UNDERFLOOR FRAMING	POLE CALLED	SEPTIC TANK	ALTER	SHADING		GAS METER AUTH.	REPAIR	GLAZING		PG & E CALLED	MOVE	DOORING			GRADING	REPLACE FOUNDATION				HEAT/DAMPERS				COMBUSTION AIR				CHIMNEY				MECHANICAL			
BUILDINGS	ELECTRICAL	PLUMBING	PLASTERING																																																																				
FOUNDATION FORMS	TEMPORARY SERVICE	ROUGH PLUMBING	LATH-EXTERIOR																																																																				
LARGE ROOMS	UNDERGROUND OR	ROUGH HEATING	LATH-INTERIOR																																																																				
CONCRETE SLAB FLOOR	UNDER CONCRETE	GAS PRESSURE	LATH-SHOWER & T.B.																																																																				
CONCRETE BLOCKS	ROUGH ELECTRIC	SEWER	SHIRT BODY MAKING																																																																				
	ELECT. SERVICE	FINAL PLUMBING	FIRE SEPARATION																																																																				
	FINAL ELECTRIC	FINAL HEATING	SCRATCH																																																																				
ROOF SHEATHING	ELECTRIC METER AUTH.	FINAL GAS	OTHER																																																																				
UNDERFLOOR FRAMING	POLE CALLED	SEPTIC TANK	ALTER																																																																				
SHADING		GAS METER AUTH.	REPAIR																																																																				
GLAZING		PG & E CALLED	MOVE																																																																				
DOORING			GRADING																																																																				
REPLACE FOUNDATION																																																																							
HEAT/DAMPERS																																																																							
COMBUSTION AIR																																																																							
CHIMNEY																																																																							
MECHANICAL																																																																							
OK TO OCCUPY DATE 7-26-90 FINAL INSPECTION DATE 7-26-90 OWNER Patricia Felix GENERAL CONTRACTOR LePage Construction PROPERTY PG. NO. 10-19-89 PERMIT NO. 42527																																																																							

4/18/90 RL

1. Not ready sheetrock nailing. Reschedule.

4/18/90 TM

Recepticles at sink one not working the other is wired incorrectly.

Plug under sink is not a switched recepticle.

Toilet is to be installed for final.

Install light in bathroom.

Sleeping room window doesn't open far enough to meet egress. No exit door TM

Have plans on job for final.

Not a complete list.

7-20-90 1. Cook top in Guest House is to be removed as per planning also is not an approved plan. T.M. *COOKTOP WAS REMOVED OFF 7-26-90*

*OK TO FINAL COMPARE TO
JOB COPY IN OFFICE 7-26-90
OFF*

PROPERTY LOCATION

LOT 15, BLOCK 116, TRACT 5088, Parcel by the Sea
 STREET ADDRESS: 4361 Bayview Drive
 NEAREST CROSS STREET: Capitulation Avenue
 CITY: Carmel
 ARCHITECT'S OFFICE: Patricia Felix
 CONTRACTOR: Pfeiffer Plumbing
 TYPE OF STRUCTURE: repair water pipes in Guest house

MONTEREY COUNTY BUILDING INSPECTION

08/27/90

043821

2 0.0

APPLICANT'S DECLARATION

I hereby affirm that I am licensed under the provisions of Chapter 4 of the Monterey County Code and the Business and Professions Code and I am duly licensed in full force and effect.

Signature: Catherine Pate
 License No: 636
 Number: 417043

OWNER-BUILDER DECLARATION

I hereby affirm that I am a licensed contractor under the provisions of Chapter 4 of the Monterey County Code and the Business and Professions Code and I am duly licensed in full force and effect.

Signature: Catherine Pate
 License No: 636
 Number: 417043

WORKERS' COMPENSATION DECLARATION

I hereby affirm that I have a certificate of consent to self-insure or a certificate of Workers' Compensation Insurance and I am duly licensed in full force and effect.

Signature: Catherine Pate
 License No: 636
 Number: 417043

CERTIFICATE OF EXEMPTION FROM WORKERS' COMPENSATION INSURANCE

I hereby affirm that I am exempt from the provisions of the Workers' Compensation Act and I am duly licensed in full force and effect.

Signature: Catherine Pate
 License No: 636
 Number: 417043

FEES

PLAN CHECK: \$

PERMIT: \$20.00

TOTAL: \$20.00

APPLICATION APPROVED BY: H. Lelund

REQUIRED FOR CLEARANCE

MINOR DISPOSITIONS:

HEALTH:

ENVIRONMENT:

BUILDING INSPECTOR:

OWNER-BUILDER DECLARATION:

PLANNING/DESIGN:

BRIDGE:

ADDRESS:

SCHOOL BUS:

DATE PAID:

RECEIVED:

9-7-90 In order to final 43821 I need to do a water or air test (50 lb. air test).
Please call me to let me know what was repaired on the water piping system. D.G.

- Activities
- Related Permits
- Valuation Calculator
- Valuation Contractor
- Fees
- Fee Payment
- Payment History
- Conditions
- Inspections
- Documents
- Bond Tracking
- GIS

Quicklinks

- Building Dept Website
- User Guides
- County Codes
- County Website
- APN Maps
- Staff Website
- State Contractors License Board
- PBI GIS Viewer/Parcel Rot
- National Weather Service

Reports

Record ID: BP090685

Menu Save Reset Summary Help

Go To Summary Detail Workflow Workflow History (1) Inspections (1) Valuation Calc (1) Fee (7) Docu

Application Name

WILSON EUGENE B TR ET AL

Detailed Description

REROOF 540 SQUARE FOOT GUEST HOUSE REMOVE EXISTING TAR AND GRAVEL AND REPLACE WITH SAMECROSS STREET MARTIN

check spelling

Permit Type

Building/Building/L

Status

Finalized

Opened Date

05/07/2009

Job Value

1,096.20

Created By ACA

--Select--

Channel Reported

--Select--

Assigned Date

Assigned to Department Current Department

--Select--

Assigned to Staff Current User

--Select--

Completed Date

Completed by Department Current Department

--Select--

Completed by Staff Current User

--Select--

Closed Date

Closed by Department Current Department

--Select--

Closed by Staff Current User

--Select--

150%

3:54 PM

2/23/2018

This page intentionally left blank