

Exhibit H

This page intentionally left blank.

PLANT LIST

Q/Size	Name
Trees	
20/5 gal.	Fruit trees (low hydrozone) Choose from: Malus varieties - edible apple Prunus varieties (plum, peach, apricot, etc.) Diospyros kaki - Persimmon
9/5 gal.	Fruit trees (medium hydrozone) Choose from: Ficus carica - Fig Citrus - Orange, Lemon, Tangarine Pyrus varieties - edible pear
Screening Plants (low hydrozone)	
13/5 gal.	Choose from: Callistemon citrinus - Lemon Bottlebrush Dodonaea viscosa 'Purpurea' - Purple Hopseed Bush Nerium oleander - Oleander Punica granatum - Pomegranate Quercus agrifolia - Coast Live Oak Umbellularia californica - California Bay Laural
Low Shrubs (3' spacing) (medium hydrozone)	
40/5 gal.	Choose from: Abelia 'Confetti' Coleonema 'Sunset Gold' - Sunset Gold Breath of Heaven Euryops pectinatus 'Verdi' - Yellow Daisy Bush Sollya heterophylla - Australian Bluebell Creeper
Green Roof (1' spacing) (low hydrozone)	
26/flats	Choose from: Juncus patens - California Grey Rush Sedum spathulifolium - Pacific Stonecrop Sedum spurium - Stone Crop Muhlenbergia rigens - Deer Grass

Landscaping Notes

1. Soil to be amended with compost at time of planting. Compost at a rate of a minimum of four (4) cubic yards per 1,000 sq.ft. of permeable area, and incorporated to a depth of six (6) inches into the soil. Soils with greater than 6% organic matter in the top 6 inches of soil are exempt from adding compost and tiling.

2. A minimum three (3) inch layer of mulch shall be applied on all exposed soil surfaces of planting areas except turf, creeping or rooting ground covers, or direct seeding applications where mulch is contraindicated. To provide habitat for beneficial insects and other wildlife, up to 5% of the landscape area may be left without mulch. Designated insect habitat will be indicated on the landscape plan if applicable.

3. Hydrozone areas of chosen plants are indicated on plan.

4. "I have complied with the criteria of the ordinance (MWEL0) and applied them for the efficient use of water in the landscape design plan."

Dinah Irino

Dinah Irino, Floravista

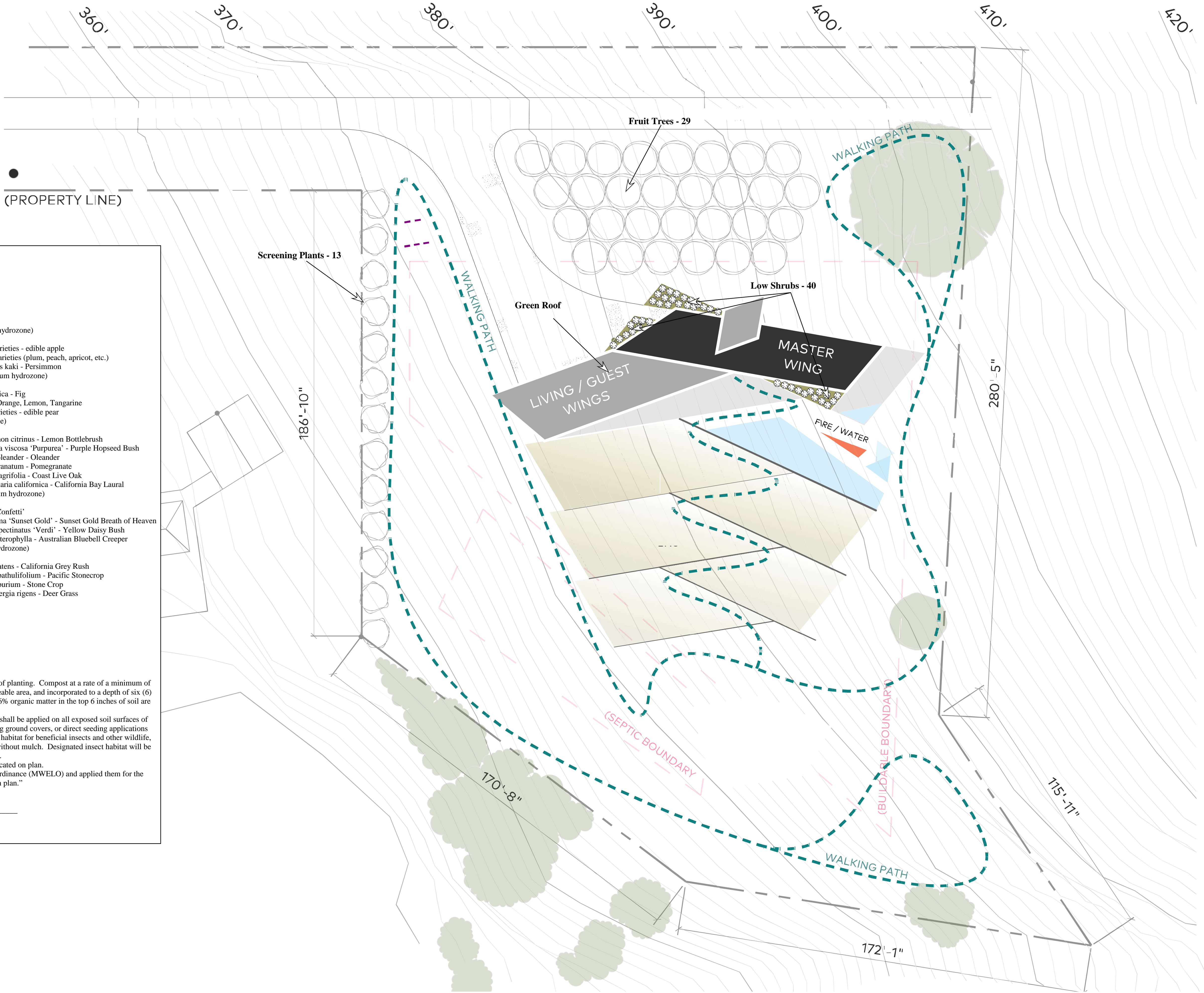

Project: **GOLDEN BLEU SKYE RANCH**
69 East Carmel Valley Road
Carmel Valley, CA 93924
APN: 197-011-018-000
Client: John Farmanesh Bocca
149 South Barrington Ave.
Los Angeles, CA 90049
310-270-3454

This page intentionally left blank.